

REV A	AUTH JLE	DATE 10/17/02	INITIAL RELEASE
REV B	AUTH RL	DATE 05/14/04	CORRECTED FREQ. NOTES.
REV C	AUTH RL	DATE 10/26/06	TOLERANCES REVISED; FORMAT UPDATE, REDESIGNATED AS 5231W

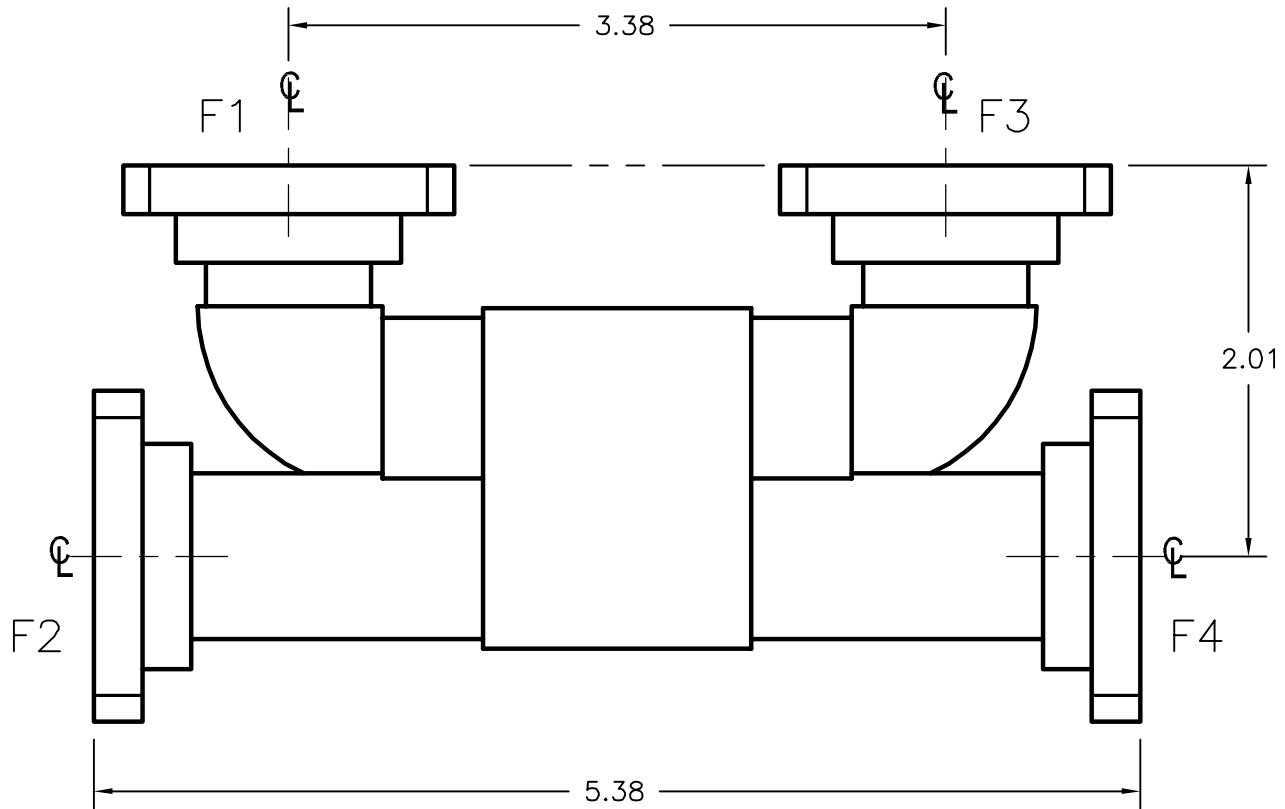

FLANGE TYPE
1 = CPRG
2 = CPRF
6 = UG COVER
7 = UG CHOKE
8 = COVER GROOVE

FREQUENCY	MODEL
10.0-11.6 GHz	75-261A-Z-F1-F2-F3-F4
11.6-13.4 GHz	75-262A-Z-F1-F2-F3-F4
13.0-15.0 GHz	75-263A-Z-F1-F2-F3-F4

NOTE: REPLACE "F1, F2, F3, & F4" NOTATION WITH NUMBER CORRESPONDING TO FLANGE TYPE DESIRED, AS SHOWN ON TABLE ABOVE.

THIRD ANGLE PROJECTION:		APPROVALS	DATE	<b>ADVANCED TECHNICAL MATERIALS, INC.</b> TEL: (631) 289-0363 FAX: (631) 289-0358 www.atmmicrowave.com	<small>THE INFORMATION IN THIS DRAWING IS PROPRIETARY AND SHALL NOT BE USED OR DISCLOSED WITHOUT THE PRIOR WRITTEN CONSENT OF ATM INC. DO NOT SCALE DWGS.</small>
UNLESS OTHERWISE NOTED, DIMENSIONS ARE IN INCHES. TOLERANCES ARE: FRACTIONS: ±1/64 ANGLES: ±1/2°		DRAWN <b>RL</b>	10/26/06		
BASIC DIMENSION	DECIMALS 2 PLACE 3 PLACE	CHKD.	APRVD.	<b>OUTLINE, WR75</b> <b>Z-STYLE COMBINER-DIVIDER (HYBRID COUP.)</b>	
UNDER 6"	±.02 ±.005	MATERIAL <b>PER ORDER</b>			
6" - 12"	±.03 ±.010	TREATMENT <b>-</b>			
OVER 12"	±.06 ±.015	FINISH <b>ATM GRAY</b>		SIZE <b>A</b>	CAGE CODE 0R8N4
				ATM DWG # <b>5231W</b>	REVISION <b>C</b>
				SCALE <b>1 : 1</b>	SHEET <b>1/1</b>
				MODEL # <b>75-26XX-Z-F1-F2-F3-F4</b>	