

**Dimensions mm[inch]**  
 tolerances acc. to DIN ISO 2768-m  
 Toleranzen gem. DIN ISO 2768-m

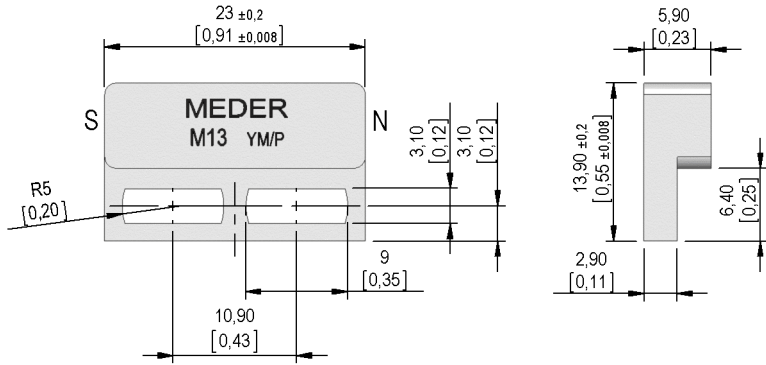

**Isometric**  
 Scale 1:2  
 Maßstab 1:2

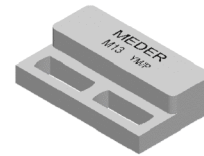

**Marking**  
 according to EN60062/factory code  
 gem. EN60062/Fertigungsstätte

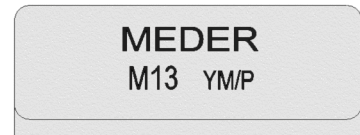

Special Product Data	Conditions	Min	Typ	Max	Unit
Sealing compound					Polyurethan
Housing material					PBT glass fibre reinforced
Case color					white

Environmental data	Conditions	Min	Typ	Max	Unit
Operating temperature		-20		80	°C

Mag. values DIN IEC 60404-8-	Conditions	Min	Typ	Max	Unit
Energy product (B x H) max.		35	39,8		kJ/cu m
Remanence Br		1.120	1.240		mT
Revers. temp. coeff. of Br			-0,02		%/K
Magnetic moment	inclusive of 5% tolerance	19,8	22,2		E-6 Vs*cm
Magnet Material					AlNiCo 500 35/5
Direction of Magnetization					axial

General data	Conditions	Min	Typ	Max	Unit
Housing Style/Form					
Tightening torque	Screw M3 ISO 1207 Disk ISO 7089			0,5	Nm

# Mouser Electronics

Authorized Distributor

Click to View Pricing, Inventory, Delivery & Lifecycle Information:

[Standex Electronics:](#)

[M13](#)