

2 BAY EDGE LINE

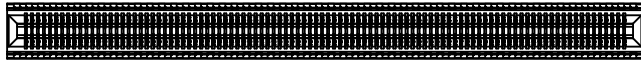

1 BAY EDGE LINE

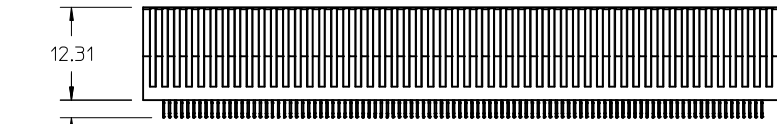

LAST CIRCUIT

FIRST CIRCUIT

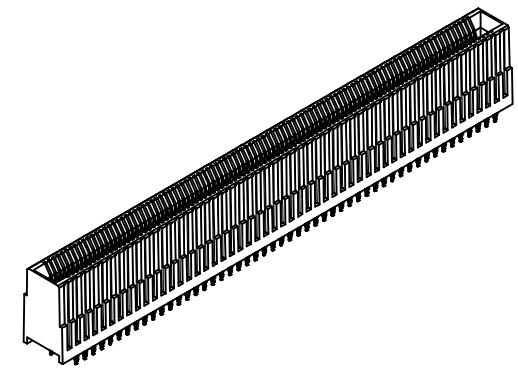
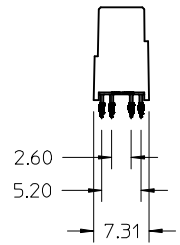
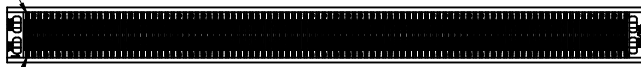

PART NUMBER	VERSION	BAY 1/BAY 2	TOTAL CIRCUITS	DIM A	SALES DRAWING (SEE NOTE 9)
76691-2278	2 BAY	143/132	278	118.63	RSD-76691-2278
76691-1200	1 BAY	200	200	84.20	RSD-76691-1200
76691-2108	2 BAY	86/22	108	50.63	RSD-76691-2108
76691-3108	2 BAY	86/22	108	50.63	RSD-76691-3108
76691-2080	2 BAY	52/28	80	39.43	RSD-76691-111
76691-9046*	1 BAY	46	46	22.60	RSD-76691-109
76691-1046	1 BAY	46	46	22.60	RSD-76691-107

NOTES:

- MATERIAL:
HOUSING - GLASS FILLED THERMOPLASTIC, 94-VO, BLACK
TERMINALS - COPPER ALLOY
- FINISH:
CONTACT AREA: 0.76 MICROMETER MINIMUM HARD GOLD OVER 3.80 MICROMETER NICKEL
COMPLIANT AREA: 0.76-1.52 MICROMETER TIN OVER 1.27 MICROMETER NICKEL
- REFER TO PS-75594-999 PRODUCT SPECIFICATION FOR ALL ELECTRICAL, MECHANICAL AND ENVIROMENTAL SPECIFICATIONS.
- REFER TO PK-76693-900 FOR ALL PACKAGING SPECIFICATIONS.
- PROCESSING: PRESSFIT TO PC BOARD.
- MATING PC BOARD THICKNESS = 1.60±0.16MM OVER CONTACT PADS.
- THIS PART CONFORMS TO CLASS B REQUIREMENTS OF COSMETIC SPEC PS-45499-002
- FOR EDGE CARD AND MOUNTING PCB LAYOUT DETAIL SEE CORRESPONDING SALES DRAWING.

INITIAL RELEASE EC NO: UCP2015-1097 DRWNR:RWHIPPLE 2014/09/15 CHKD:MPOFF 2014/09/15 APPR:SMILLER 2014/09/29	DESCRIPTION REV	QUALITY SYMBOLS	GENERAL TOLERANCES (UNLESS SPECIFIED)	DIMENSION STYLE MM ONLY	SCALE 2:1	DESIGN UNITS METRIC	THIRD ANGLE PROJECTION
		▽=0	mm INCH	DRAWN BY DATE RWHIPPLE 2014/09/15	EDGELINE 12.5GB 0.062*PCB 0.8MM PITCH		
		▽=0	4 PLACES ± --- ± ---	CHECKED BY DATE MPOFF 2014/09/15			
		▽=0	3 PLACES ± --- ± ---	APPROVED BY DATE SMILLER 2014/09/29			
	2 PLACES ± 0.13 ± ---	MATERIAL NO.	DOCUMENT NO.				
		1 PLACE ± 0.25 ± ---	ANGULAR ±1/2°	SEE TABLE	RSD-76691-100	SHEET NO.	
		0 PLACE ± --- ± ---	DRAFT WHERE APPLICABLE MUST REMAIN WITHIN DIMENSIONS	SIZE C	THIS DRAWING CONTAINS INFORMATION THAT IS PROPRIETARY TO MOLEX INCORPORATED AND SHOULD NOT BE USED WITHOUT WRITTEN PERMISSION	1 OF 1	

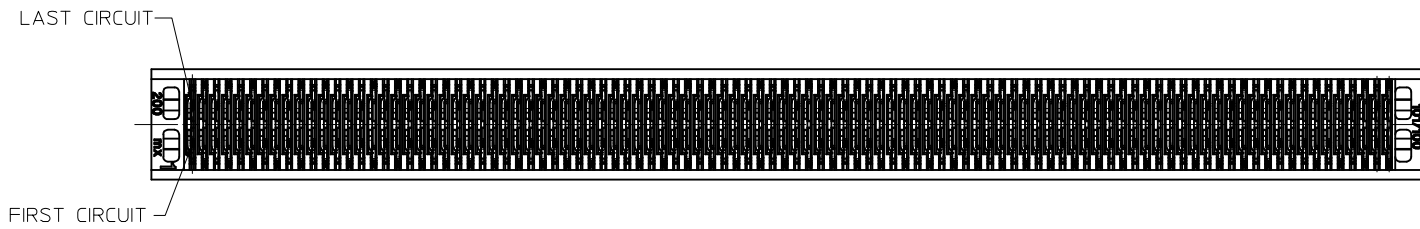
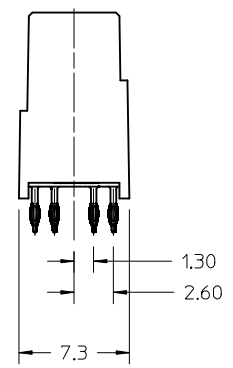
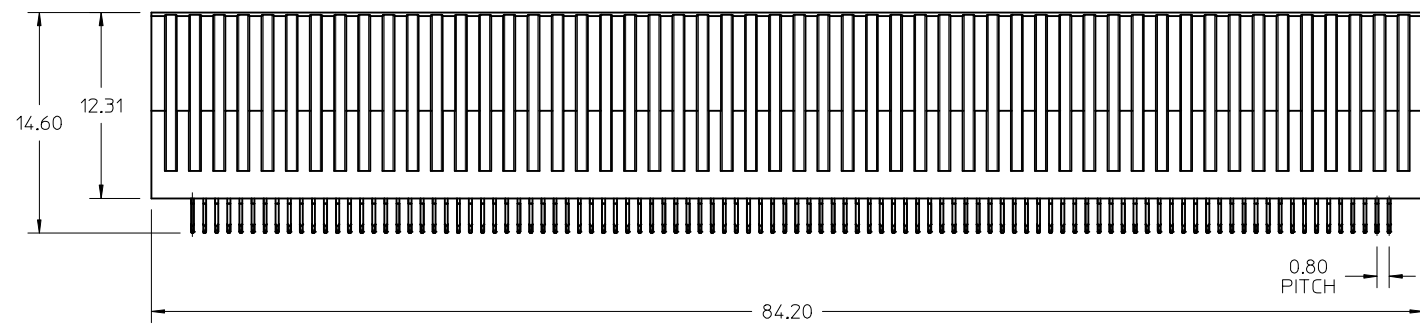
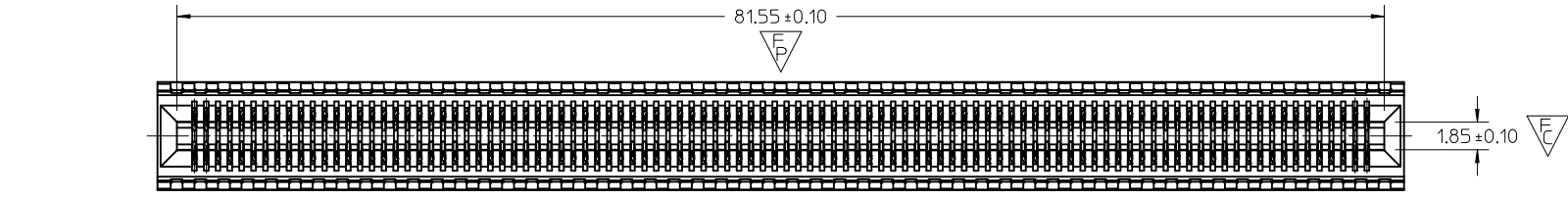

- NOTES:
- MATERIAL:
HOUSING - GLASS FILLED THERMOPLASTIC, 94-V0, BLACK
TERMINALS - COPPER ALLOY
 - FINISH:
CONTACT AREA: HARD GOLD $-0.76\mu\text{m}$ MIN OVER $3.80\mu\text{m}$ NICKEL
COMPLIANT AREA: TIN - $0.76/1.52\mu\text{m}$ OVER NICKEL
 - REFER TO PS-75594-999 PRODUCT SPECIFICATION FOR ALL ELECTRICAL, MECHANICAL AND ENVIRONMENTAL SPECIFICATIONS.
 - REFER TO PK-76693-900 FOR ALL PACKAGING SPECIFICATIONS.
 - PROCESSING: PRESSFIT TO PC BOARD.
 - MATING PC BOARD THICKNESS = $1.60\pm 0.16\text{MM}$ OVER CONTACT PADS.
 - THIS PART CONFORMS TO CLASS B REQUIREMENTS OF COSMETIC SPEC PS-45499-002

INITIAL RELEASE EC NO: UCP2015-1097 DRAWN: RWHPPL 2014/09/16 CHKD: MPOFF 2014/09/16 APPR: SMILLER 2014/09/29	DESCRIPTION REV	QUALITY SYMBOLS ▽=0 ▽=1 ▽=1	GENERAL TOLERANCES (UNLESS SPECIFIED)		DIMENSION STYLE MM ONLY	SCALE 4:1	DESIGN UNITS METRIC	THIRD ANGLE PROJECTION	
			mm	INCH	DRAWN BY RWHPPL	DATE 2014/09/16	TITLE EDGE LINE 12.5GB 200CKTS 0.062*PCB 0.8MM PITCH		
A			4 PLACES ± ---	± ---	CHECKED BY MPOFF	DATE 2014/09/16	DOCUMENT NO. RSD-76691-1200		SHEET NO. 1 OF 4
			3 PLACES ± ---	± ---	APPROVED BY SMILLER	DATE 2014/09/29	MATERIAL NO. 766911200		
			2 PLACES ± 0.15	± ---	ANGULAR ± 2 °		SIZE C		
			1 PLACE ± 0.25	± ---	DRAFT WHERE APPLICABLE MUST REMAIN WITHIN DIMENSIONS				
			0 PLACE ±	±	THIS DRAWING CONTAINS INFORMATION THAT IS PROPRIETARY TO MOLEX INCORPORATED AND SHOULD NOT BE USED WITHOUT WRITTEN PERMISSION				

EDGELINE CONNECTOR BOARD MOUNTING

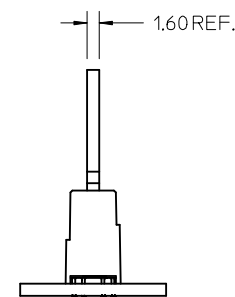
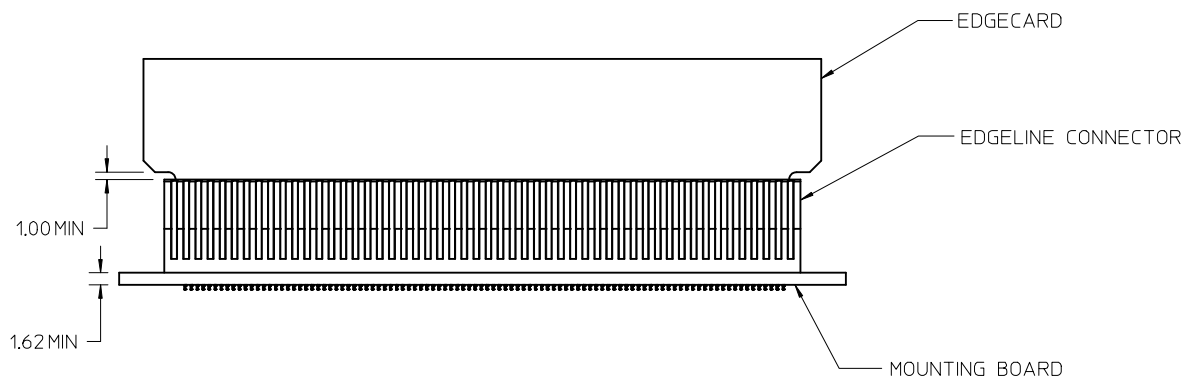
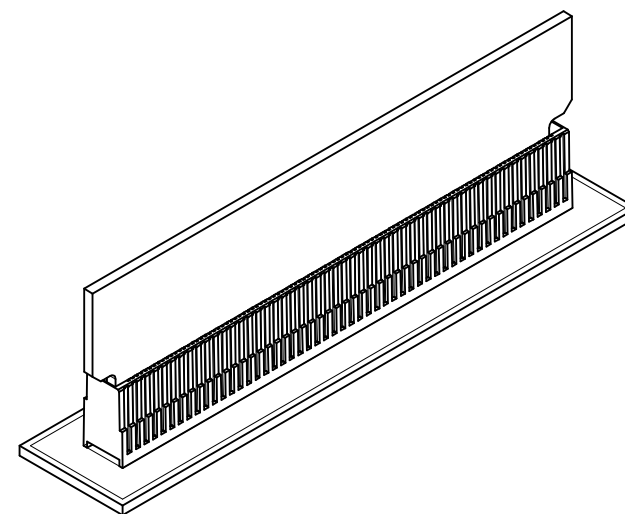
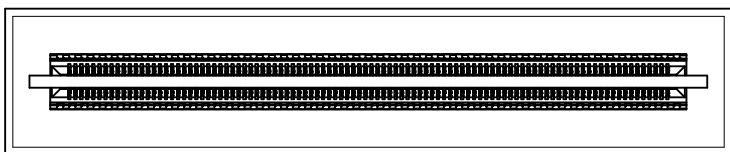

SEE SHEET 1 EC NO: UCP2015-1097 DRWR:RWHIPPLE 2014/09/16 CHKD:MPOFF 2014/09/16 APPR:SMILLER 2014/09/29	QUALITY SYMBOLS	GENERAL TOLERANCES (UNLESS SPECIFIED)		DIMENSION STYLE	SCALE	DESIGN UNITS	THIRD ANGLE PROJECTION
	▽=0	mm	INCH	MM ONLY	2:1	METRIC	
	▽=0	4 PLACES ± --- ± ---	3 PLACES ± --- ± ---	DRAWN BY	DATE	TITLE	
	▽=0	2 PLACES ± 0.15 ± ---	1 PLACE ± 0.25 ± ---	0 PLACE ± ±	RWHIPPLE 2014/09/16	2014/09/16	EDGELINE 12.5GB 200CKTS 0.062"PCB 0.8MM PITCH
REV	DESCRIPTION	ANGULAR ± 2 °		APPROVED BY	DATE	DOCUMENT NO.	
A		DRAFT WHERE APPLICABLE MUST REMAIN WITHIN DIMENSIONS		SMILLER 2014/09/29	2014/09/29	RSD-76691-1200	
				MATERIAL NO.	SEE SHEET 1		SHEET NO.
				SIZE	THIS DRAWING CONTAINS INFORMATION THAT IS PROPRIETARY TO MOLEX INCORPORATED AND SHOULD NOT BE USED WITHOUT WRITTEN PERMISSION		2 OF 4

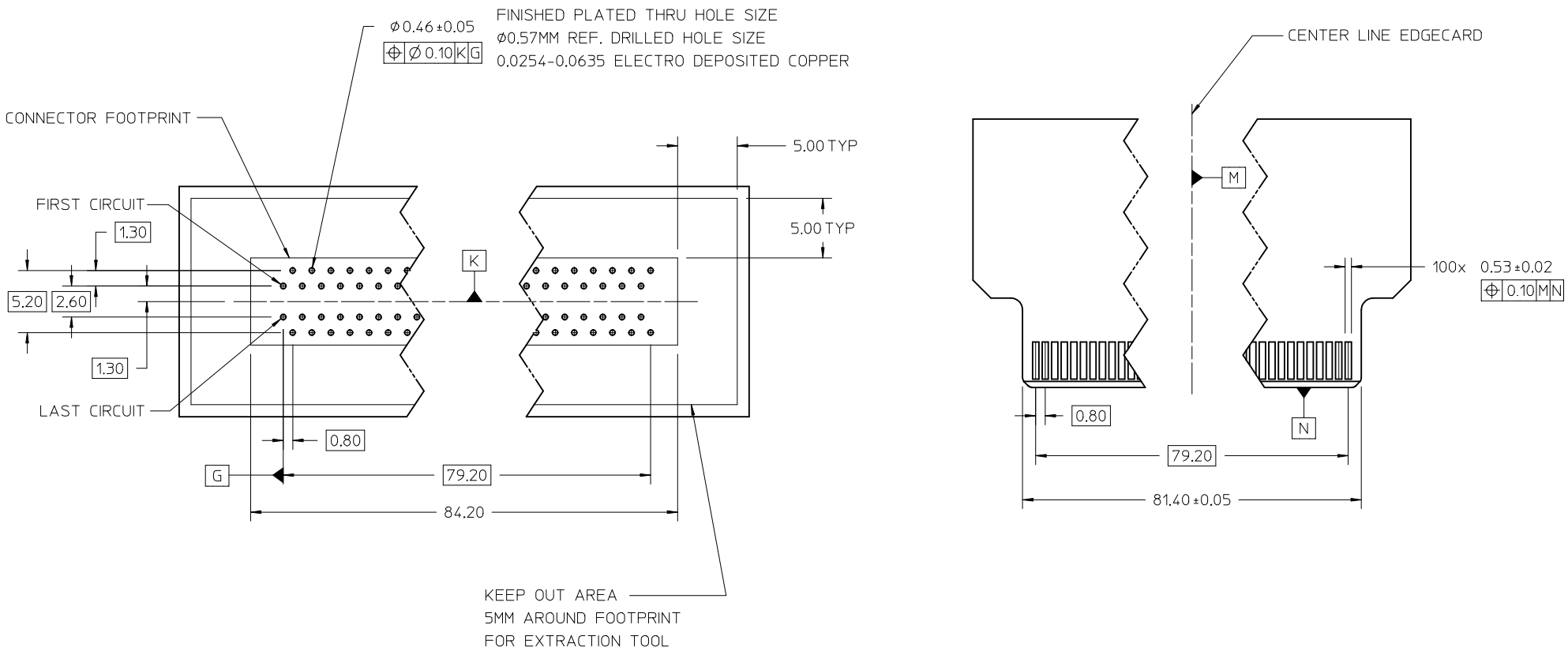

SEE SHEET 1 EC NO: UCP2015-1097 DRW:RWHIPPLE 2014/09/16 CHKD:MPOFF 2014/09/16 APPR:SMILLER 2014/09/29	QUALITY SYMBOLS	GENERAL TOLERANCES (UNLESS SPECIFIED)	DIMENSION STYLE	SCALE	DESIGN UNITS	THIRD ANGLE PROJECTION
	▽=0	mm INCH	MM ONLY	4:1	METRIC	
	▽=0	4 PLACES ± --- ± ---	DRAWN BY DATE			TITLE
	▽=0	3 PLACES ± --- ± ---	RWHIPPLE 2014/09/16			EDGELINE 12.5GB 200CKTS 0.062"PCB 0.8MM PITCH
		2 PLACES ± 0.15 ± ---	CHECKED BY DATE			
		1 PLACE ± 0.25 ± ---	MPOFF 2014/09/16			
		0 PLACE ± ±	APPROVED BY DATE			
		ANGULAR ± 2 °	SMILLER 2014/09/29			
		DRAFT WHERE APPLICABLE MUST REMAIN WITHIN DIMENSIONS	MATERIAL NO.			
			SEE SHEET 1			
			SIZE C			
			THIS DRAWING CONTAINS INFORMATION THAT IS PROPRIETARY TO MOLEX INCORPORATED AND SHOULD NOT BE USED WITHOUT WRITTEN PERMISSION			
				DOCUMENT NO.		SHEET NO.
				RSD-76691-1200		3 OF 4

MODULE EDGE CARD CONTACT DETAIL

Note:

These are generic details that describe the configuration of various PCB design elements. The customer must determine where and when to use each element to accommodate their specific application.*

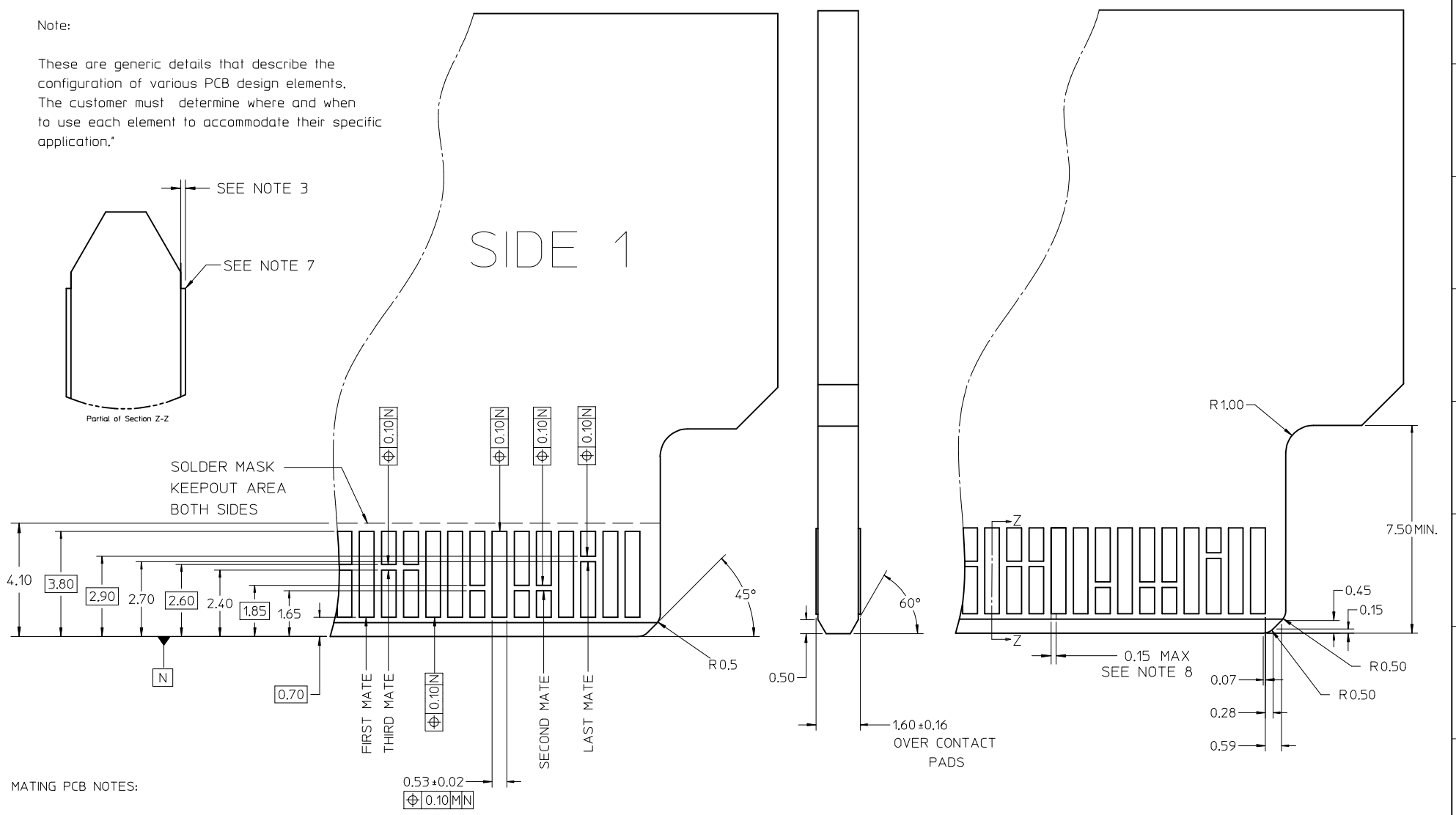

MATING PCB NOTES:

- CONNECTOR LAND CONDITIONS SHALL MEET THE MOST CURRENT REVISION OF PCB SPECIFICATION IPC-6012C-2010 SECTION 3.5.4.4.
- DIMENSIONS APPLY TO LANDS ON BOTH SIDES OF THE BOARD.
- THE THICKNESS OF THE OUTER METAL LAYERS, INCLUDING FOIL, COPPER PLATING, AND THE PROTECTIVE SURFACE FINISH, SHALL BE 0.066mm MAX.
- CHAMFER ROUGHNESS NOT TO EXCEED 3.17 MICROMETERS.
- CHAMFER PROCESS SHALL NOT DAMAGE THE GOLD EDGE LANDS.
- EDGE CARD CHAMFER NOT TO GO THRU GOLD LANDS.
- 0.03mm MAX PLATING OVERHANG ON ALL GOLD LAND EDGES.
- MOLEX RECOMMENDS NO TIE-BARS ON THE LEADING EDGE OF THE GOLD LAND. IF TIE-BARS ARE USED, THEY SHALL BE PLACED TO ONE SIDE OF THE GOLD LAND. APPLIES TO ALL GOLD LANDS.

SEE SHEET 1 EC NO: UCP2015-1097 DR: RWHIPPLE 2014/09/16 CHK: MPOFF 2014/09/16 APPR: SMILLER 2014/09/29	QUALITY SYMBOLS ▽=0 ▽=0 ▽=0	GENERAL TOLERANCES (UNLESS SPECIFIED)		DIMENSION STYLE MM ONLY	SCALE 10:1	DESIGN UNITS METRIC	THIRD ANGLE PROJECTION	
		4 PLACES ± --- ± --- 3 PLACES ± --- ± --- 2 PLACES ± 0.15 ± --- 1 PLACE ± 0.25 ± --- 0 PLACE ± ±	DRAWN BY RWHIPPLE DATE 2014/09/16	CHECKED BY MPOFF DATE 2014/09/16	APPROVED BY SMILLER DATE 2014/09/29	TITLE EDGELINE 12.5GB 200CKTS 0.062"PCB 0.8MM PITCH		
		ANGULAR ± 2 °			MATERIAL NO. SEE SHEET 1		DOCUMENT NO. RSD-76691-1200	SHEET NO. 4 OF 4
		DRAFT WHERE APPLICABLE MUST REMAIN WITHIN DIMENSIONS				THIS DRAWING CONTAINS INFORMATION THAT IS PROPRIETARY TO MOLEX INCORPORATED AND SHOULD NOT BE USED WITHOUT WRITTEN PERMISSION		