

TABLE OF CONTENTS	
SHEET NO.	SHEET DESCRIPTION
1	NOTES AND BOM
2	CONFIGURATIONS
3	SEAL PLUG DETAIL

BILL OF MATERIALS (BOM)			
DESCRIPTION	PART NUMBER	COLOR	STATUS
MX150, NATURAL	34345-0001	NATURAL	SALEABLE
MX150, BLACK	34345-0002	BLACK	SALEABLE

NOTES: VALID UNLESS OTHERWISE SPECIFIED

1. GENERAL:

- a. APPLICATION SPECIFICATION SEE: AS-33472-100
  - COMPONENTS ARE OPTIONAL AND MUST BE PURCHASED SEPERATELY
  - FOR ASSEMBLY INSTRUCTIONS SEE THE APPLICATION SPECIFICATION
  - SEAL PLUGS ARE NOT TO BE USED TO REPLACE SHORTING BAR TERMINALS.
- b. PRODUCT SPECIFICATION SEE: N/A
- c. PACKAGING SPECIFICATION PER MOLEX DRAWING: PK-31300-438
- d. PARTS MUST BE IN COMPLIANCE TO MOLEX CHEMICAL SUBSTANCES FOR PRODUCTS AND PACKAGING SPECIFICATION: QEHS-699000-300
- e. DATA MUST BE SUBMITTED UNDER THE MOLEX PART NUMBER TO IMDS (COMPANY ID#13255)

2. DESIGN - MATERIALS:

- a. MATERIAL: PBT
- b. VOLUME: SEE BOM TABLE

3. DESIGN - GEOMETRY:

- a. ALL GRAPHIC DATA IS BASIC (NO TOLERANCE) AND MUST BE TAKEN FROM THE DATA FILE AT ITS LATEST REVISION.
- b. GEOMETRIC DIMENSIONS AND TOLERANCES PER ASME Y14.5M - 2009
- c. THE BASIC DIMENSIONS OF THE COMPONENT ARE DEFINED BY THE 3-D CAD DATA. THE CAD MATHEMATICAL DATA IS THE MASTER FOR ALL FEATURES AND IS TO BE USED TO ESTABLISH DIMENSIONAL INFORMATION NOT SHOWN ON THIS DRAWING.
- d. GENERAL TOLERANCES: SEE TITLE BLOCK
- e. EDGES AND UNDIMENSIONED DETAILS PER ISO13715
- f. CORNERS SHOWN AS SHARP TO BE R 0.2 MAX.
- g. LETTERING SHALL BE 0.15 MAX RAISED.

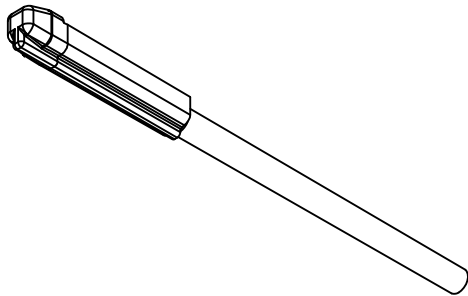
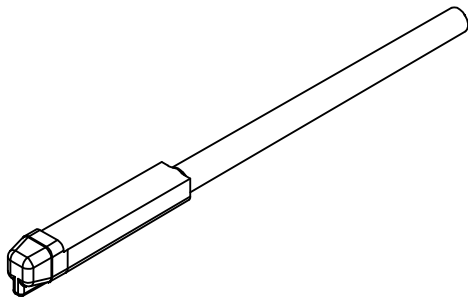

CS	UPDATED DESCRIPTIONS
REV	DESCRIPTION

ENTER DESCRIPTION IEC NO. UAU2016-0453 DRAWN BY: GURUSZENSKI, 2015/10/02 CHKD: APPR: VIOSHY 2015/10/07	QUALITY SYMBOLS ▽=0 ▽=0 ▽=0	GENERAL TOLERANCES (UNLESS SPECIFIED) mm      INCH 4 PLACES ± .010 ± .0004 3 PLACES ± .020 ± .0008 2 PLACES ± 0.10 ± .004 1 PLACE ± 0.3 ± .012 0 PLACE ± ±		DIMENSION STYLE MM ONLY		SCALE 7:1	DESIGN UNITS METRIC	THIRD ANGLE PROJECTION
		DRAFT WHERE APPLICABLE MUST REMAIN WITHIN DIMENSIONS		MATERIAL NO. SEE BOM		DOCUMENT NO. SD-34345-001		SHEET NO. 1 OF 3

MX150  
CAVITY PLUG  
SEALED



THIS DRAWING CONTAINS INFORMATION THAT IS PROPRIETARY TO MOLEX INCORPORATED AND SHOULD NOT BE USED WITHOUT WRITTEN PERMISSION

20 19 18 17 16 15 14 13 12 11 10 9 8 7 6 5 4 3 2 1

**SHEET DESCRIPTION**

CONFIGURATIONS

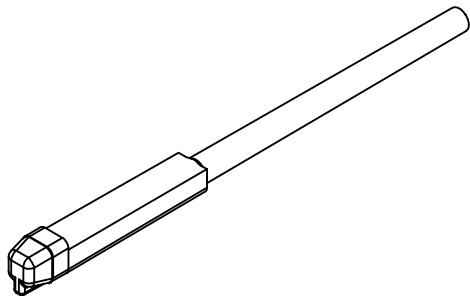

MX150, NATURAL

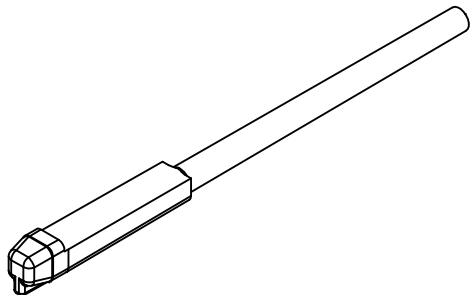

MX150, BLACK

<b>ENTER DESCRIPTION</b> IEC NO. UAU2016-0453 DRAWN BY GURUSZENSKI, 2015/10/02 CHKD: APPR: VIOSHY 2015/10/07	QUALITY SYMBOLS ▽=0 ▽=0 ▽=0	GENERAL TOLERANCES (UNLESS SPECIFIED)		DIMENSION STYLE <b>MM ONLY</b>	SCALE <b>7:1</b>	DESIGN UNITS <b>METRIC</b>	THIRD ANGLE PROJECTION
		4 PLACES ± mm ± INCH	DRAWN BY MYANSLAM	DATE 10/27/05	TITLE <b>MX150                  CAVITY PLUG                  SEALED</b>		
		3 PLACES ± 0.10 ± 0.3	CHECKED BY ABUTCHER	DATE 10/27/05	MATERIAL NO. <b>SEE BOM</b>		
		2 PLACES ± 0.3 ± 0.3	APPROVED BY SMARCEAU	DATE 10/27/05	DOCUMENT NO. <b>SD-34345-001</b>	SHEET NO. 2 OF 3	
ANGLAR ± 3 ° DRAFT WHERE APPLICABLE MUST REMAIN WITHIN DIMENSIONS		THIS DRAWING CONTAINS INFORMATION THAT IS PROPRIETARY TO MOLEX INCORPORATED AND SHOULD NOT BE USED WITHOUT WRITTEN PERMISSION					

19 18 17 16 15 14 13 12 11 10 9 8 7 6 5 4 3 2 1

20 19 18 17 16 15 14 13 12 11 10 9 8 7 6 5 4 3 2 1

CHARTED DIMENSIONS	
DESCRIPTION	DIMENSIONS
MX150, NATURAL	3.00
MX150, BLACK	2.67

MOLD CAVITY ID  
THIS LOCATION



SEALING SURFACE

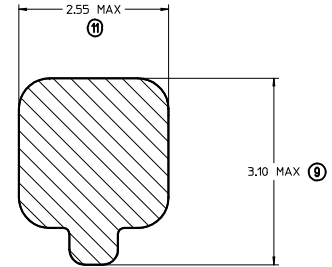
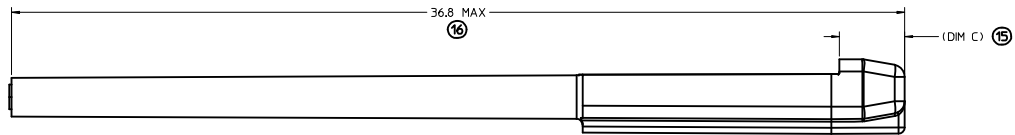
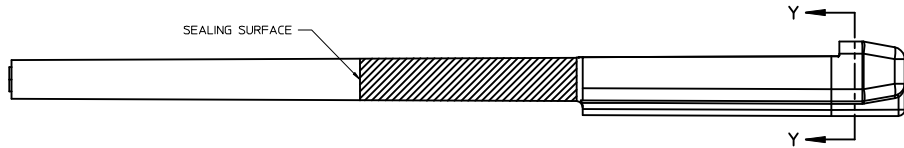

SECTION Y-Y  
SCALE 25:1

<b>ENTER DESCRIPTION</b> IEC NO. UAU2016-0453 DRAWN BY: BORBUSZSKI, 2015/10/02 CHKD: APPR: WOSHY 2015/10/07	QUALITY SYMBOLS ∇=0 ∇=0 ∇=0	GENERAL TOLERANCES (UNLESS SPECIFIED) <table border="1"> <thead> <tr> <th></th> <th>mm</th> <th>INCH</th> </tr> </thead> <tbody> <tr> <td>4 PLACES</td> <td>± 0.10</td> <td>± 0.004</td> </tr> <tr> <td>3 PLACES</td> <td>± 0.15</td> <td>± 0.006</td> </tr> <tr> <td>2 PLACES</td> <td>± 0.20</td> <td>± 0.008</td> </tr> <tr> <td>1 PLACE</td> <td>± 0.30</td> <td>± 0.012</td> </tr> <tr> <td>0 PLACE</td> <td>± 0.40</td> <td>± 0.016</td> </tr> </tbody> </table> ANGULAR ± 3 ° DRAFT WHERE APPLICABLE MUST REMAIN WITHIN DIMENSIONS		mm	INCH	4 PLACES	± 0.10	± 0.004	3 PLACES	± 0.15	± 0.006	2 PLACES	± 0.20	± 0.008	1 PLACE	± 0.30	± 0.012	0 PLACE	± 0.40	± 0.016	DIMENSION STYLE <b>MM ONLY</b>	SCALE <b>10:1</b>	DESIGN UNITS <b>METRIC</b>	THIRD ANGLE PROJECTION
		mm	INCH																					
	4 PLACES	± 0.10	± 0.004																					
	3 PLACES	± 0.15	± 0.006																					
2 PLACES	± 0.20	± 0.008																						
1 PLACE	± 0.30	± 0.012																						
0 PLACE	± 0.40	± 0.016																						
DRAWN BY MYANSLAM DATE 10/27/05	CHECKED BY ABUTCHER DATE 10/27/05	APPROVED BY SMARCEAU DATE 10/27/05	MATERIAL NO. <b>SEE BOM</b>	TITLE <b>MX150 CAVITY PLUG SEALED</b>	DOCUMENT NO. <b>SD-34345-001</b>	SHEET NO. 3 OF 3																		
<b>molex</b>						THIS DRAWING CONTAINS INFORMATION THAT IS PROPRIETARY TO MOLEX INCORPORATED AND SHOULD NOT BE USED WITHOUT WRITTEN PERMISSION																		
						SIZE <b>D</b>																		

19 18 17 16 15 14 13 12 11 10 9 8 7 6 5 4 3 2 1