

FEATURES

- Excellent low price control potentiometer.
- Based on the PT-15 / PTC-15 series.
- Available in carbon (SM-15) and cermet (SMC-15).
- Enclosed in plastic housing.
- IP54 protection according to IEC 60529.

MECHANICAL SPECIFICATIONS

- Mechanical rotation angle: $265^\circ \pm 5^\circ$
- Electrical rotation angle: $240^\circ \pm 20^\circ$
- Torque: 0.5 to 2.5 Ncm. (0.7 to 3.4 in-oz)
- Stop torque: > 10 Ncm. (14 in-oz)

ELECTRICAL SPECIFICATIONS

- Range of values (*)
 $100\Omega \leq R_n \leq 5\text{ M}$ (Decad. 1.0 - 2.0 - 2.2 - 2.5 - 4.7 - 5.0)
- Tolerance (*): $100\Omega \leq R_n \leq 1\text{M}\Omega$ $\pm 20\%$
 $1\text{M}\Omega < R_n \leq 5\text{M}$ $\pm 30\%$
- Max. Voltage: 250 VDC (lin) 125 VDC (no lin)
- Nominal Power: • 50°C (122°F) 0.25W (lin), 0.12W (no lin) carbon
• 70°C (158°F) 0.5W (lin) 0.25W (no lin.) cermet
- Power derating: 0 Watt a 100°C
- Taper (**): Lin., Log., Alog.
- Residual resistance(*): $\leq 0.5\%$ R_n (5 Ω min.)
- Operating temperature: $-25^\circ\text{C} + 70^\circ\text{C}$ (***) ($-13^\circ\text{F} + 158^\circ\text{F}$) carbon
 $-40^\circ\text{C} + 90^\circ\text{C}$ ($-40 + 194^\circ\text{F}$) cermet
- Mechanical life: ≥ 10.000 (***)

(*) Others upon request. (***) Up to 85°C depending on application
(**) Others tapers on request. No linear tapers; values higher than 1 K Ω .
(***) For Ohmic values $\geq 1\text{ K}\Omega$. Lower values upon request

HOW TO ORDER SM-15

SM-15	H04	102	A	2020					S
Series	Code	Mounting Method	Value	Taper	Cut track	Shafts	Shaft Colour	Nut and Washer	
SM-15	H04 H14 H12 H20 H24 V02 V21 V12 V22 V15 V17 H16 H26 H03 H13 H22 H30 H23 V23	H 2.5A H 5A H 2.5PA H 5 PA HC 5A V 12.5 V 12.5P VA VA P V 15 V17.5 BA BB H 2.5B H 5B H 2.5PB H 5PB HC 5B V 15P	101 = 100 Ω 102 = 1 K 504 = 500 K 505 = 5 M (See note 2)	A = Linear B = Log. C = Alog. (Other tapers on request)	PCI = Initial PCF= Final	02 = Fig.2 06 = Fig.6 07 = Fig.7 08 = Fig.8 10 = Fig.10 11 = Fig.11 12 = Fig.12 17 = Fig.17 21 = Fig.21 (See note 4)	RO = Red VE = Green AM = Yellow AZ = Blue IN = Natural MA = Brown GR = Grey NA = Orange CR = Cream (See note 5)	-TA = Loose nut and washer MTA = Assembled nut and washer -T- = Loose nut MT- = Assembled nut	
				Tolerance 2020 = + 20% 3030 = + 30% (See note 3)					

HOW TO ORDER CUSTOM DRAWING

SM-15 H04 + DRAWING NUMBER (Max. 16 digits)

This way of ordering should be used for options which are not included in the "How to order" standard and optional extras.

STANDARD OPTIONS

Cut track Non cut track
Shaft Fig. 9
Shaft colour Black
Nut and washer Without nut & washer

NOTES:

- (1) Mounting Method: Positions with "P" will be with crimped terminals.
- (2) Value: Code: $\begin{matrix} 10 & 1 & 100\Omega \\ \downarrow & \downarrow & \downarrow \\ \text{Number of zeros} & \text{2 first digits of the value.} & \end{matrix}$
• Standard values: Decades of 10, 20, 22, 25, 47, 50. Other values upon request.
- (3) Tolerance (non standard). Upon request. Code eg.: $\begin{matrix} +7 & 05 \\ -5 & \end{matrix}$ → negative tolerance
positive tolerance
- (4) Shafts: These figures coincide with the PT15 references (Standard material).
- (5) Colour: Only applicable to the shaft.

NOTE: The information contained here should be used for reference purposes only.

HOW TO ORDER SMC-15

OPTIONAL EXTRAS

SMC-15	H04	102	A	2020			
Series	Code	Mounting Method	Value	Taper	Shafts	Shaft Colour	Nut and Washer
SMC-15	H04	H 2.5A	101 = 100Ω	A = Linear	02 = Fig.2	RO = Red	-TA = Loose nut and washer
	H14	H 5A	102 = 1 K	B = Log.	06 = Fig.6	VE = Green	MTA= Assembled nut and washer
	H12	H 2.5PA	504 = 500 K	C = Alog.	07 = Fig.7	AM = Yellow	-T- = Loose nut
	H20	H 5PA	505 = 5 M	(Other tapers on request)	08 = Fig.8	AZ = Blue	MT-= Assembled nut
	H34	HA 5A	000 = C M	(See note 2)	10 = Fig.10	IN = Natural	
	V02	V 12.5		Tolerance	11 = Fig.11	MA = Brown	
	V21	V 12.5P		1010 = ± 10%	12 = Fig.12	GR = Grey	
	V12	VA		2020 = ± 20%	17 = Fig.17	NA = Orange	
	V22	VA P		3030 = ± 30%	21 = Fig.21	CR = Cream	
	V15	V 15		(See note 3)			
	V17	V 17.5					
	H16	BA					
	H26	BB					
	H03	H 2.5B					
	H13	H 5B					
	H22	H 2.5PB					
	H30	H 5PB					
	H33	HA 5B					
	V23	V 15P					

HOW TO ORDER CUSTOM DRAWING

SMC-15 H04 + DRAWING NUMBER (Max. 16 digits)

This way of ordering should be used for options which are not included in the "How to order" standard and optional extras.

STANDARD OPTIONS

Shaft Fig. 9
 Shaft colour Black
 Nut and washer Without nut and washer

NOTES:

- Mounting Method: Positions with "P" are with crimped terminals.
- Value: Code: 10 1 100 Ω
 • Standard values: Decades of 10, 20, 22, 25, 47, 50. Other values upon request.
 • 000 = CM = Switch 45° (see PTC-15).
- Tolerance (non standard). Upon request. Code eg.: +7 = 07 05
 -5 negative tolerance
 positive tolerance
- Shafts: The figures coincide with the numbers for PT15. (Standard material).
- Colour: Only applicable to the shaft.

COMMON DIMENSIONS

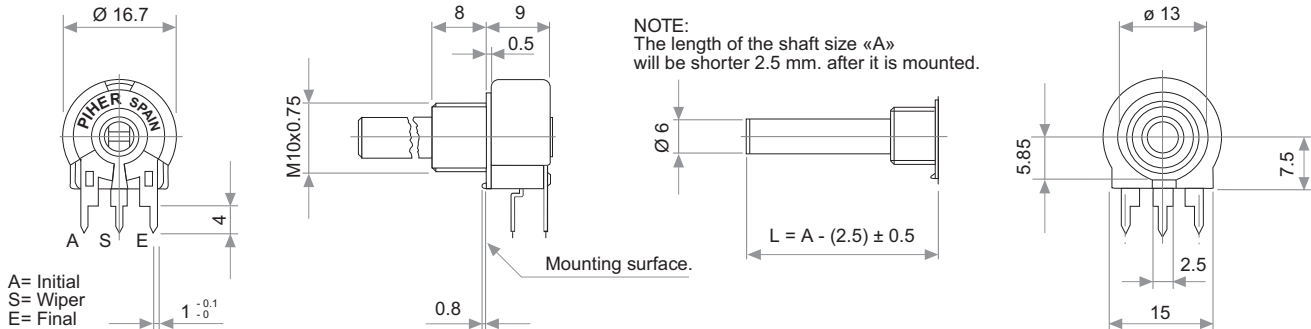

SHAFTS

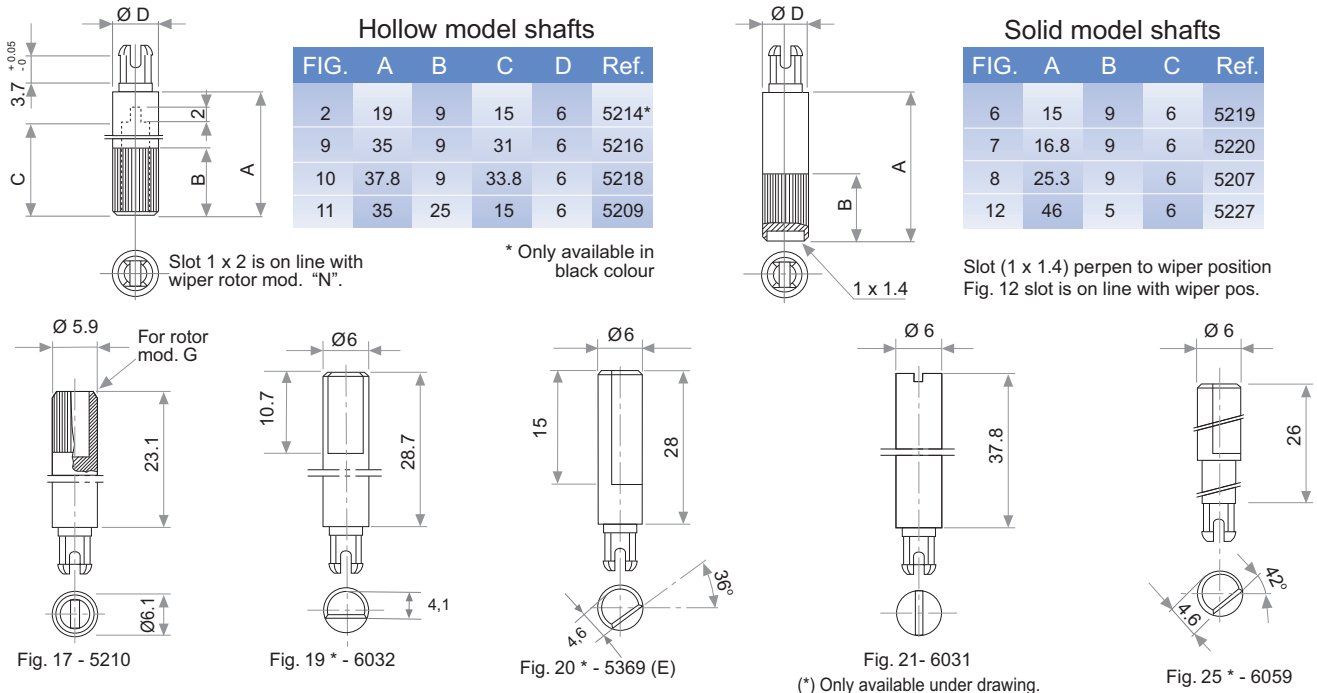

SNAP IN TERMINAL

PACKAGING

P

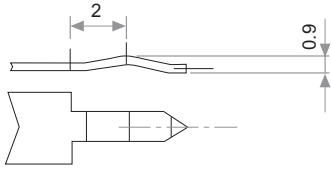

QUANTITY: 100 units

TERMINAL STYLES

h 2.5

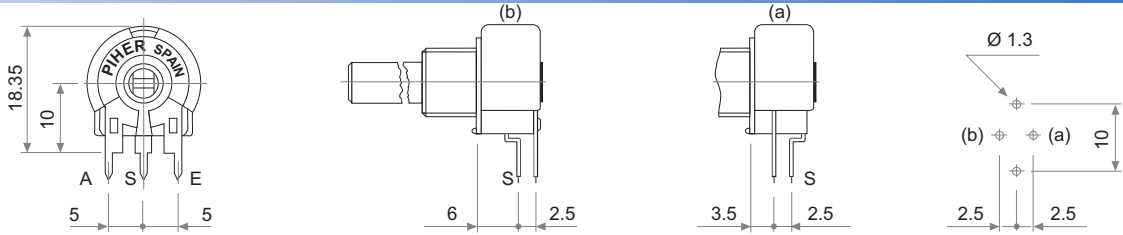

h 5

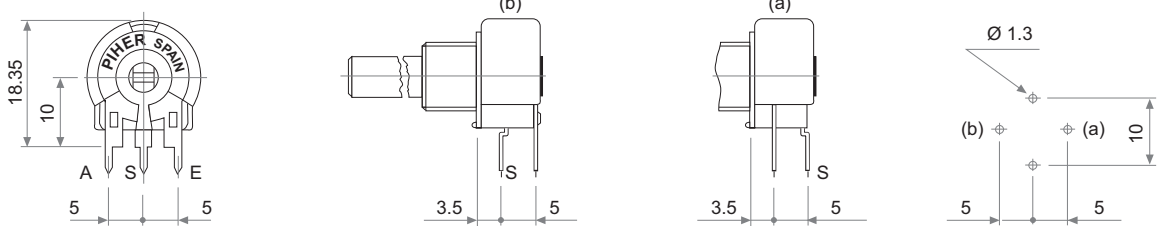

B

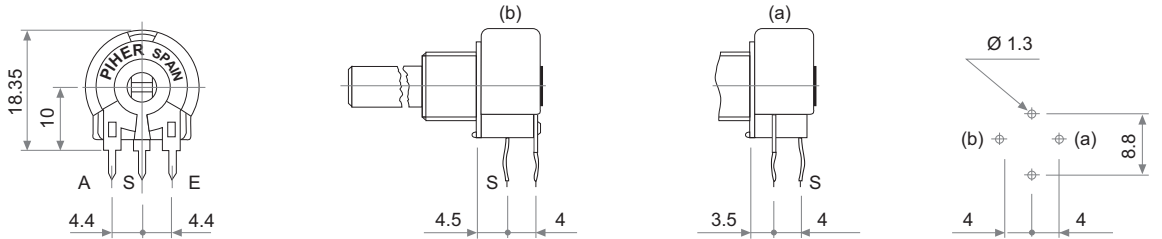

h C 5

Only SM-15

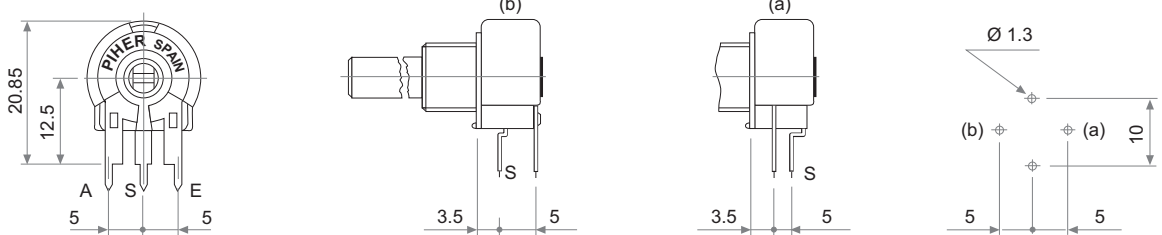

h A 5

Only SMC-15

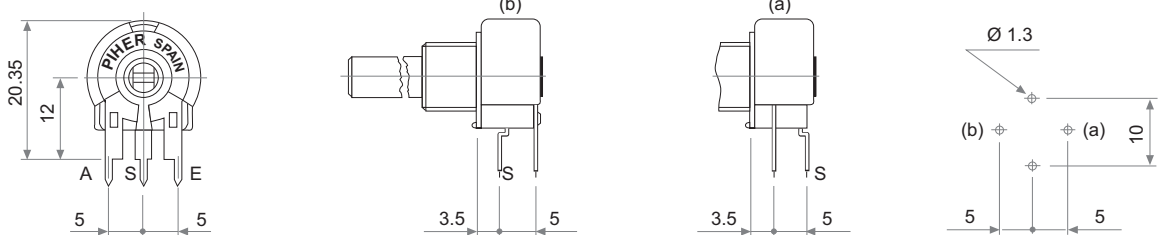

v 12.5

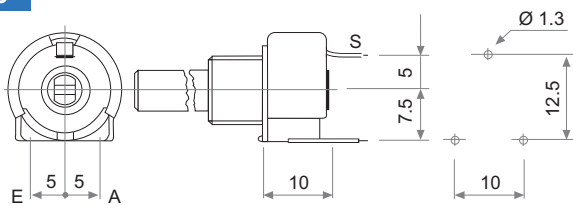

v 15

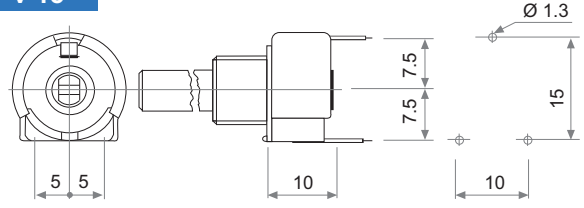

va 12.5

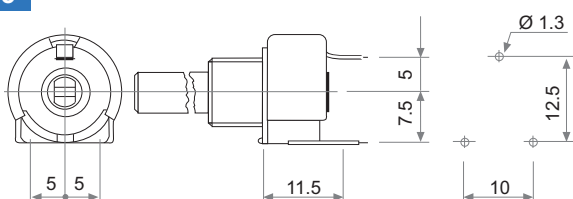

v 17.5

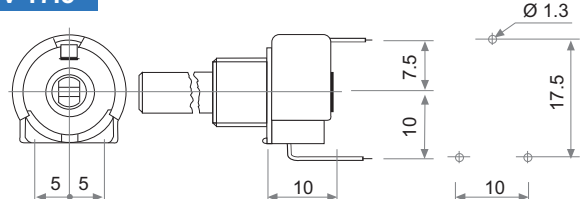

Disclaimer

The product information in this catalogue is for reference purposes. Please consult for the most up to date and accurate design information.

Piher Sensors & Controls S.A., its affiliates, agents, and employees, and all persons acting on its or their behalf (collectively, "Piher"), disclaim any and all liability for any errors, inaccuracies or incompleteness contained herein or in any other disclosure relating to any product described herein.

Piher disclaims any and all liability arising out of the use or application of any product described herein or of any information provided herein to the maximum extent permitted by law. The product specifications do not expand or otherwise modify Piher's terms and conditions of sale, including but not limited to the warranty expressed therein, which apply to these products.

No licence, express or implied, by estoppel or otherwise, to any intellectual property rights is granted by this document or by any conduct of Piher.

The products shown herein are not designed for use in medical, life-saving, or life-sustaining applications unless otherwise expressly indicated. Customers using or selling Piher products not expressly indicated for use in such applications do so entirely at their own risk and agree to fully indemnify Piher for any damages arising or resulting from such use or sale. Please contact authorised Piher personnel to obtain written terms and conditions regarding products designed for such applications.

Product names and markings noted herein may be trademarks of their respective owners.

Information contained in and/or attached to this catalogue may be subject to export control regulations of the European Community, USA, or other countries. Each recipient of this document is responsible to ensure that usage and/or transfer of any information contained in this document complies with all relevant export control regulations. If you are in any doubt about the export control restrictions that apply to this information, please contact the sender immediately. For any Piher International Corp. Exports, Note: All products / technologies are EAR99 Classified commodities. Exports from the United States are in accordance with the Export Administration Regulations. Diversion contrary to US law is prohibited.



Mouser Electronics

Authorized Distributor

Click to View Pricing, Inventory, Delivery & Lifecycle Information:

Piher:

[SM15V15-103A2020-2-TA](#) [SM15H24-103A2020-08VE-MTA](#)