

8 | 7 | 6 | 5 | 4 | 3 | 2 | 1

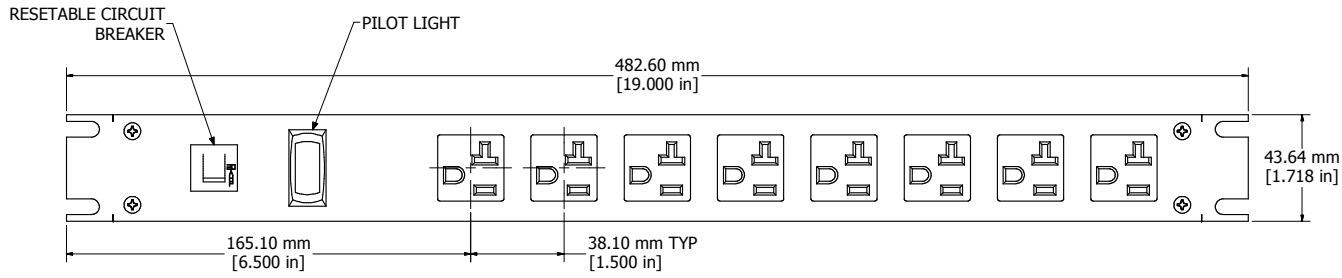

ASSEMBLY - VIEW FROM FRONT

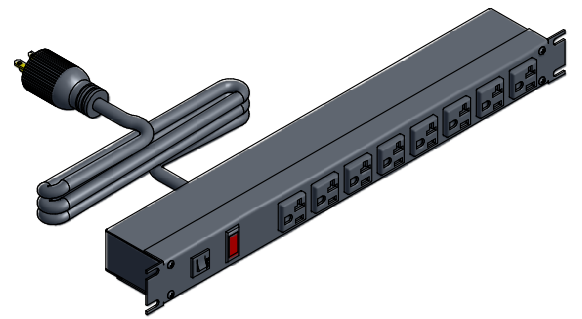

ISOMETRIC VIEW

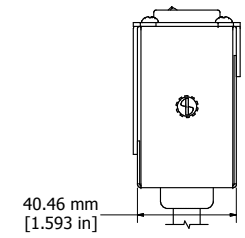
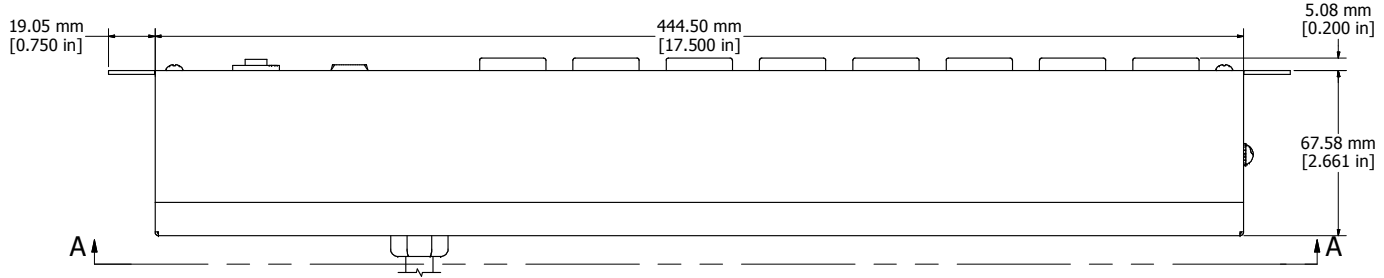

ASSEMBLY - VIEW FROM SIDE

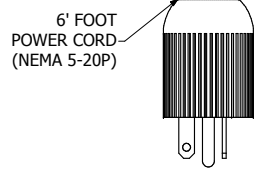

ASSEMBLY - VIEW FROM BOTTOM

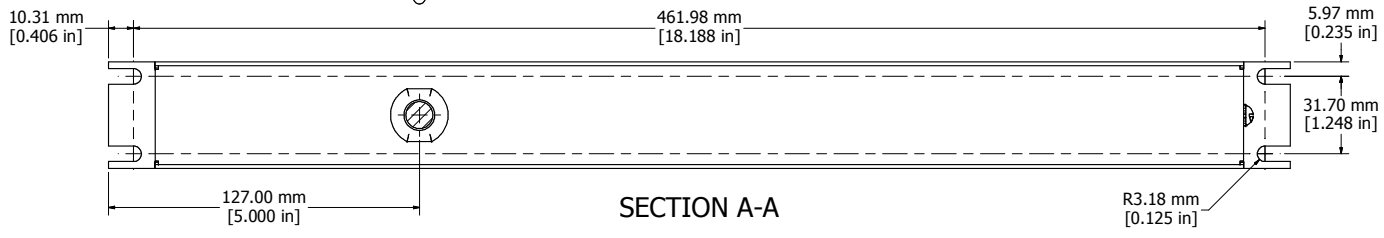

SECTION A-A

1589T8F1BKRF
Finish - Front - Black Painted Steel
Back - Black Painted Steel
Rated - 125 VAC, 60 Hz, 20 Amps
Approvals - CSA Certified Standards C22.2 (No. 21-95, 42-99)
- UL Recognized Standard UL1363
Cord Length
1589T8F1BKRF - 6' Foot Power Cord (NEMA 5-20P)
1589T8G1BKRF - 15' Foot Power Cord (NEMA 5-20P)

HAMMOND MANUFACTURING™

1589T8F1BKRF

www.hammondmfg.com

8 | 7 | 6 | 5 | 4 | 3 | 2 | 1

Mouser Electronics

Authorized Distributor

Click to View Pricing, Inventory, Delivery & Lifecycle Information:

[Hammond:](#)

[1589T8G1BKRF](#) [1589T8F1BKRF](#)