

| | |
|-----------------|-------------|
| ASSEMBLY NUMBER | FINISH |
| 73656-0000 | SEE NOTE 2. |
| 73656-0001 | SEE NOTE 3. |

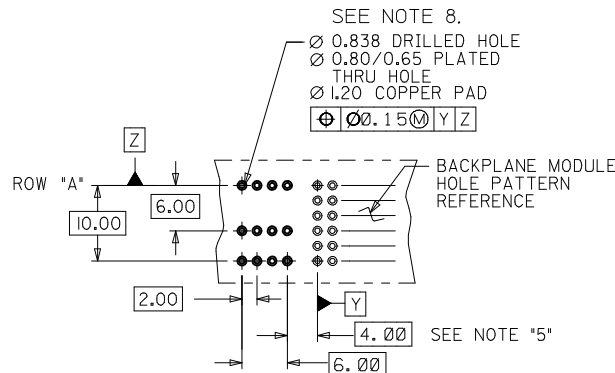
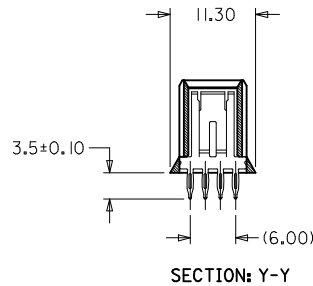
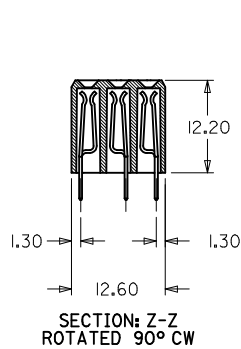
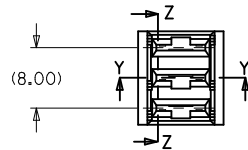
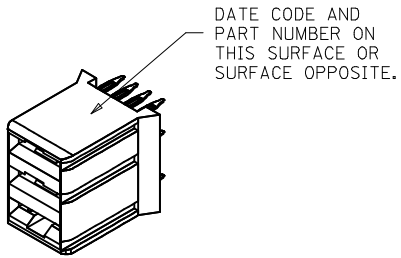

PCB LAYOUT: COMPONENT SIDE
RECOMMENDED PCB THICKNESS: 2.50 MIN

NOTES:

1. MATERIALS: HOUSING - LIQUID CRYSTAL POLYMER (LCP), GLASS-FILLED, UL94V-0, COLOR: BLACK
TERMINAL - COPPER ALLOY
2. FINISH: SELECTIVE GOLD (Au) IN CONTACT AREA, 0.76 micrometer MINIMUM THICKNESS: NICKEL (Ni) AND GOLD FLASH OVERALL
3. FINISH: SELECTIVE GOLD (Au) IN CONTACT AREA, 0.76 micrometer MINIMUM THICKNESS: MATTE TIN (Sn) OVER NICKEL (Ni) IN COMPLIANT AREA: NICKEL (Ni) OVERALL ON REMAINING WITH SELECTIVE GOLD (Au) FLASH.
4. THIS DIMENSION MUST BE A MULTIPLE OF 4.00 mm.
5. DIMENSIONS ARE IN MILLIMETERS.
6. THIS PART CONFORMS TO MOLEX PRODUCT SPECIFICATION PS-73670-9999.
7. PACKAGE ASSEMBLIES PER PK-70873-0819.
8. HOLE SIZE SPECIFICATION IS FOR TIN/LEAD PLATED HOLES ONLY. FOR OTHER PLATING TYPES SEE MOLEX APPLICATION AS-73670-9996.
9. THIS PART CONFORMS TO MOLEX COSMETIC SPECIFICATION PS-45499-002 CLASS B.

| | | | | | | | | |
|---|--------------------------------------|---------------------------------------|------|--|---------------------|---|------------------------|--|
| LEAD FREE CONVERSION EC NO: UCP2013-3253 DRAWN:WHIPPLE 2013/02/04 CHKD:WOLFE 2013/02/04 APPR:SMILLER 2013/08/05 | QUALITY SYMBOLS ▽=0 ▽=0 ▽=0 | GENERAL TOLERANCES (UNLESS SPECIFIED) | | DIMENSION STYLE MM ONLY | SCALE 1:1 | DESIGN UNITS METRIC | THIRD ANGLE PROJECTION | |
| | | mm | INCH | DRAWN BY ELO | DATE 1998/05/21 | TITLE SALES ASSY, HDM BACKPLANE POWER MODULE (PRESSFIT) | | |
| REV: 1 | DESCRIPTION | 4 PLACES ±--- | ±--- | CHECKED BY SMR | DATE 1998/05/21 | | | |
| | | 3 PLACES ±--- | ±--- | APPROVED BY CAB | DATE 1998/05/21 | | | |
| | | 2 PLACES ±0.13 | ±--- | MATERIAL NO. SEE TABLE | | DOCUMENT NO. SDA-73656-*00* | SHEET NO. 1 OF 4 | |
| | | 1 PLACE ±0.25 | ±--- | DRAFT WHERE APPLICABLE MUST REMAIN WITHIN DIMENSIONS | | | | |
| | | 0 PLACE ±--- | ±--- | SIZE C THIS DRAWING CONTAINS INFORMATION THAT IS PROPRIETARY TO MOLEX INCORPORATED AND SHOULD NOT BE USED WITHOUT WRITTEN PERMISSION | | | | |

10 9 8 7 6 5 4 3 2 1

DATE CODE AND
PART NUMBER ON
THIS SURFACE OR
SURFACE OPPOSITE.

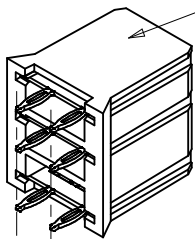

73656-100*

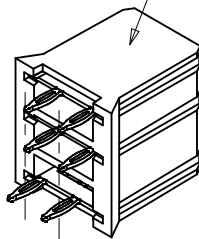

73656-200*

MIDPLANE OPTION

| ASSEMBLY NUMBER | FINISH (SEE SHT 1) |
|-----------------|-----------------------------------|
| 73656-1000 | SEE NOTE 2. (GOLD TAILS) |
| 73656-2000 | |
| 73656-1001 | SEE NOTE 3. *(MATTE TIN TAILS) |
| 73656-2001 | |

* FORMERLY TIN/LEAD

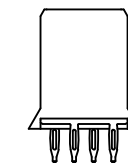
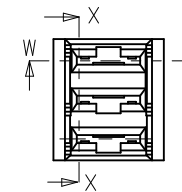
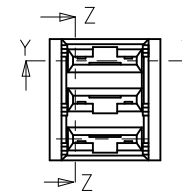

73656-200*

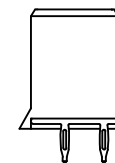

73656-100*

USE BACKPLANE MODULE
HOLE REFERENCE PATTERN
FROM SHEET 1

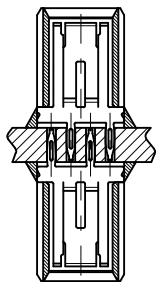

3.50
MIN

BACK-TO-BACK
MOUNTING APPLICATION

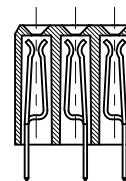

SECTION X-X
SECTION Z-Z
ROTATED 90° CW

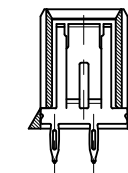

(4.00)
SECTION: Y-Y

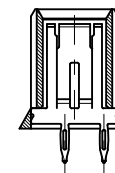

(4.00)
SECTION: W-W

| | | | | | | |
|---|-----------------------|---------------------------------------|---|--|--------------|------------------------|
| SEE SHEET 1 EC NO: UCP2013-3253 DRAWN: RWHIPPLE 2013/02/04 CHKD: MWOLFE 2013/02/04 APPR: SMILLER 2013/08/05 | QUALITY SYMBOLS | GENERAL TOLERANCES (UNLESS SPECIFIED) | DIMENSION STYLE | SCALE | DESIGN UNITS | THIRD ANGLE PROJECTION |
| | ▽=0 | mm INCH | MM ONLY | 1:1 | METRIC | ⊙ |
| | ▽=0 | 4 PLACES ± --- ± --- | DRAWN BY DATE | TITLE | | |
| | ▽=0 | 3 PLACES ± --- ± --- | ELO 1998/05/21 | SALES ASSY , HDM BACKPLANE POWER MODULE (PRESSFIT) | | |
| ▽=0 | 2 PLACES ± 0.13 ± --- | CHECKED BY DATE | DOCUMENT NO. | | | SHEET NO. |
| | 1 PLACE ± 0.25 ± --- | SMR 1998/05/21 | SDA-73656-*00* | | | 2 OF 4 |
| | 0 PLACE ± --- ± --- | APPROVED BY DATE | MATERIAL NO. | | | |
| | | CAB 1998/05/21 | SEE TABLE | | | |
| | | | SIZE B | | | |
| | | | THIS DRAWING CONTAINS INFORMATION THAT IS PROPRIETARY TO MOLEX INCORPORATED AND SHOULD NOT BE USED WITHOUT WRITTEN PERMISSION | | | |

9 8 7 6 5 4 3 2 1

| | | | | | | | | | |
|-----------------|---|----------------|---|---|---|---|---|---|---|
| 10 | 9 | 8 | 7 | 6 | 5 | 4 | 3 | 2 | 1 |
| ASSEMBLY NUMBER | | FINISH (SHT 1) | | | | | | | |
| 73656-5000 | | SEE NOTE 2. | | | | | | | |
| 73656-5001 | | SEE NOTE 3. | | | | | | | |

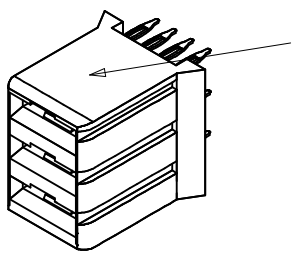

DATE CODE AND PART NUMBER ON THIS SURFACE OR SURFACE OPPOSITE.

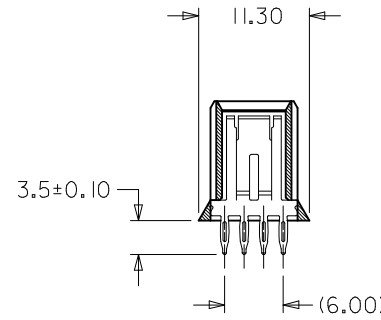
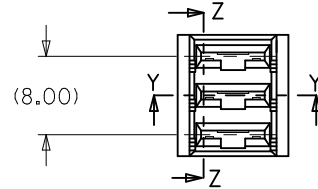

SECTION: Y-Y

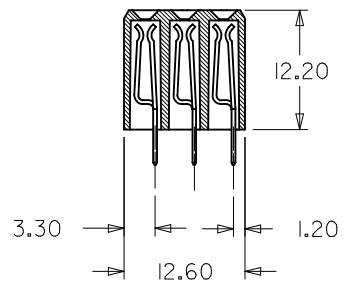

SECTION: Z-Z
ROTATED 90° CW

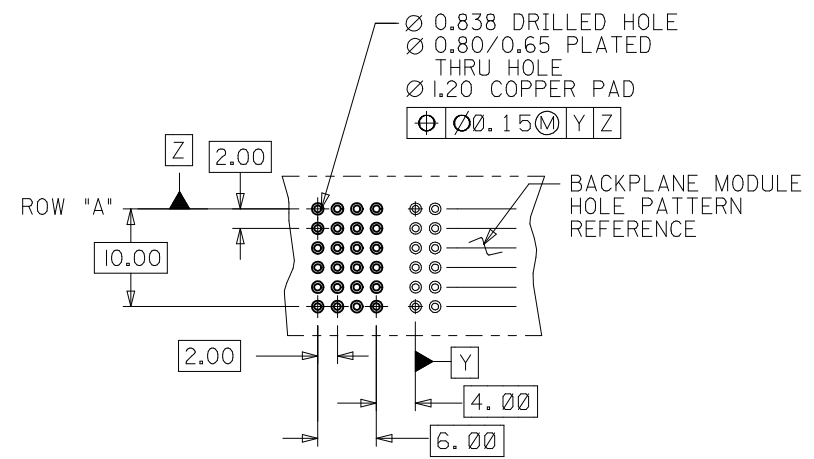
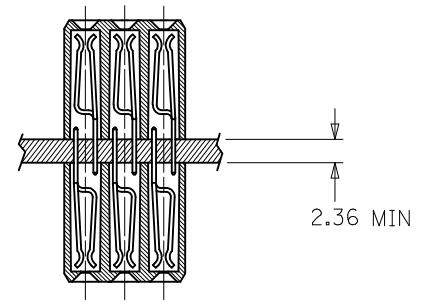

BACKPLANE MODULE HOLE PATTERN REFERENCE

| SEE SHEET 1 EC NO: UCP2013-3253 DRW:RWHIPPLE 2013/02/04 CHKD:MWOLFE 2013/02/04 APPR:SMILLER 2013/08/05 | QUALITY SYMBOLS | GENERAL TOLERANCES (UNLESS SPECIFIED) | DIMENSION STYLE | SCALE | DESIGN UNITS | THIRD ANGLE PROJECTION | | | | | | | | | | | | | | | | | | |
|--|--|---|--------------------------------|---------------------|--------------|------------------------|-------|-------|----------|-------|-------|----------|--------|-------|---------|--------|-------|---------|-------|-------|---------|-----|--------|--|
| | $\nabla = 0$ $\nabla = 0$ $\nabla = 0$ | <table border="1"> <tr> <th></th> <th>mm</th> <th>INCH</th> </tr> <tr> <td>4 PLACES</td> <td>± ---</td> <td>± ---</td> </tr> <tr> <td>3 PLACES</td> <td>± ---</td> <td>± ---</td> </tr> <tr> <td>2 PLACES</td> <td>± 0.13</td> <td>± ---</td> </tr> <tr> <td>1 PLACE</td> <td>± 0.25</td> <td>± ---</td> </tr> <tr> <td>0 PLACE</td> <td>± ---</td> <td>± ---</td> </tr> </table> | | mm | INCH | 4 PLACES | ± --- | ± --- | 3 PLACES | ± --- | ± --- | 2 PLACES | ± 0.13 | ± --- | 1 PLACE | ± 0.25 | ± --- | 0 PLACE | ± --- | ± --- | MM ONLY | 1:1 | METRIC | |
| | | mm | INCH | | | | | | | | | | | | | | | | | | | | | |
| | 4 PLACES | ± --- | ± --- | | | | | | | | | | | | | | | | | | | | | |
| 3 PLACES | ± --- | ± --- | | | | | | | | | | | | | | | | | | | | | | |
| 2 PLACES | ± 0.13 | ± --- | | | | | | | | | | | | | | | | | | | | | | |
| 1 PLACE | ± 0.25 | ± --- | | | | | | | | | | | | | | | | | | | | | | |
| 0 PLACE | ± --- | ± --- | | | | | | | | | | | | | | | | | | | | | | |
| DRAWN BY: ELO CHECKED BY: SMR APPROVED BY: CAB DATE: 1998/05/21 | MATERIAL NO. SEE TABLE SIZE: B | TITLE SALES ASSY, HDM BACKPLANE POWER MODULE (PRESSFIT) | DOCUMENT NO. SDA-73656-*00* | SHEET NO. 3 OF 4 | | | | | | | | | | | | | | | | | | | | |
| ANGULAR ±1/2° DRAFT WHERE APPLICABLE MUST REMAIN WITHIN DIMENSIONS | | THIS DRAWING CONTAINS INFORMATION THAT IS PROPRIETARY TO MOLEX INCORPORATED AND SHOULD NOT BE USED WITHOUT WRITTEN PERMISSION | | | | | | | | | | | | | | | | | | | | | | |

| | | | | | | | | | |
|-----------------|---|-------------|---|---|---|---|---|---|---|
| 10 | 9 | 8 | 7 | 6 | 5 | 4 | 3 | 2 | 1 |
| ASSEMBLY NUMBER | | FINISH | | | | | | | |
| 73656-0180 | | SEE NOTE 2. | | | | | | | |
| 73656-0181 | | SEE NOTE 3. | | | | | | | |

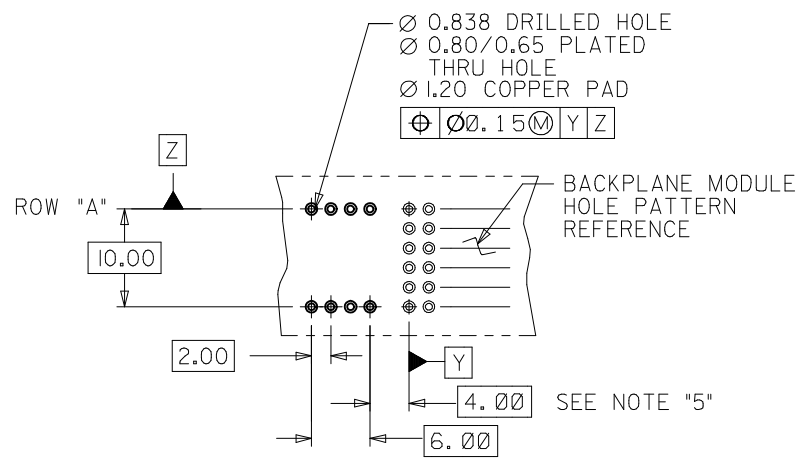
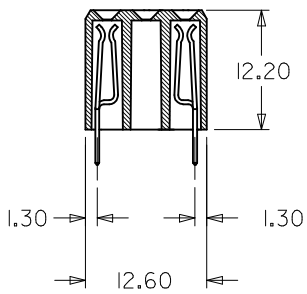
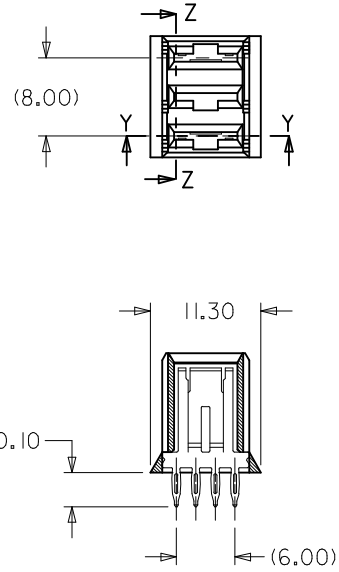
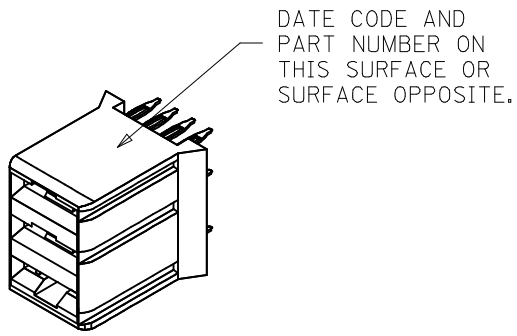

| | | | | | | |
|--|----------------------|---|-----------------|---|--------------|------------------------|
| SEE SHEET 1 EC NO: UCP2013-3253 DRWN:RWH/PPLE 2013/02/04 CHKD:MMOLFE 2013/02/04 APPR:SMILLER 2013/08/05 | QUALITY SYMBOLS | GENERAL TOLERANCES (UNLESS SPECIFIED) | DIMENSION STYLE | SCALE | DESIGN UNITS | THIRD ANGLE PROJECTION |
| | ▽=0 | mm INCH | MM ONLY | 1:1 | METRIC | ⊕ |
| | ▽=0 | 4 PLACES ± --- ± --- | DRAWN BY DATE | TITLE | | |
| | ▽=0 | 3 PLACES ± --- ± --- | ELO 1998/05/21 | SALES ASSY, HDM BACKPLANE POWER MODULE (PRESSFIT) | | |
| | ▽=0 | 2 PLACES ± 0.13 ± --- | CHECKED BY DATE | | | |
| | 1 PLACE ± 0.25 ± --- | SMR 1998/05/21 | | | | |
| | 0 PLACE ± --- ± --- | APPROVED BY DATE | MATERIAL NO. | DOCUMENT NO. | SHEET NO. | |
| | | CAB 1998/05/21 | SEE TABLE | SDA-73656-*00* | 4 OF 4 | |
| | | ANGULAR ± 1/2° DRAFT WHERE APPLICABLE MUST REMAIN WITHIN DIMENSIONS | SIZE B | THIS DRAWING CONTAINS INFORMATION THAT IS PROPRIETARY TO MOLEX INCORPORATED AND SHOULD NOT BE USED WITHOUT WRITTEN PERMISSION | | |

DATE CODE AND
PART NUMBER ON
THIS SURFACE OR
SURFACE OPPOSITE.

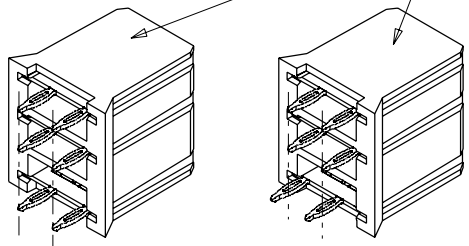

73656-100*

73656-200*

MIDPLANE OPTION

| ASSEMBLY NUMBER | FINISH (SEE SHT 1) |
|-----------------|---------------------------------|
| 73656-1000 | SEE NOTE 2. (GOLD TAILS) |
| 73656-2000 | |
| 73656-1001 | SEE NOTE 3. (TIN/LEAD TAILS) |
| 73656-2001 | |

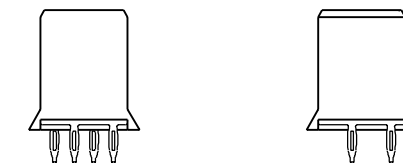
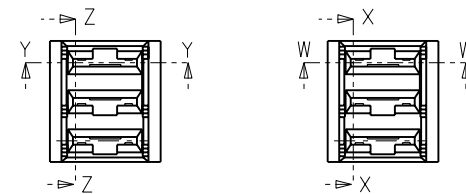

73656-200*

73656-100*

USE BACKPLANE MODULE
HOLE REFERENCE PATTERN
FROM SHEET 1

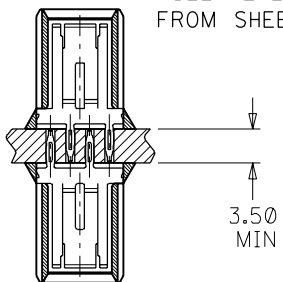

BACK-TO-BACK
MOUNTING APPLICATION

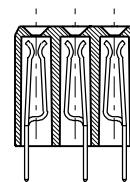

SECTION X-X
SECTION Z-Z
ROTATED 90° CW

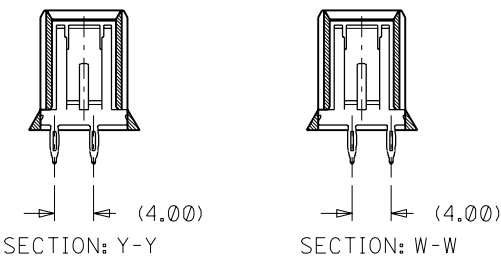

SECTION: Y-Y

SECTION: W-W

A

| | | | |
|------|-----------|------|-------------|
| | | D | SEE SHEET 1 |
| | | B | SEE SHEET 1 |
| | | A | SEE SHEET 1 |
| LTR. | REVISIONS | LTR. | REVISIONS |

DIMENSIONS SHOWN (METRIC) INCH

UNLESS OTHERWISE SPECIFIED
TOLERANCES: ANGULAR = 1/2°

| | INCH | METRIC |
|---------|-------|--------|
| 3 PLACE | ± N/A | --- |
| 2 PLACE | ± N/A | ± --- |
| 1 PLACE | --- | ± --- |

DRAFT WHERE APPLICABLE MUST
REMAIN WITHIN DIMENSIONS

| | |
|----------------|----------------|
| DRWG. BY: ELO | CHK'D. BY: SMR |
| APP'D. BY: CAB | SCALE: 2 : 1 |

REVISE ONLY ON CAD SYSTEM

| | | | |
|--|--|-----------------------------|------------------|
| TITLE SALES ASSY, HDM BACKPLANE POWER MODULE (PRESS FIT) | | SHEET NO. 2 | DATE 98/05/21 |
| MOLEX INCORPORATED LISLE, ILL. 60532 U.S.A. | | PART NO. | DRWG. NO. |
| FILE NAME S73656X2.DGN | | SEE CHART SDA-73656-*00* | |
| THIS DRAWING CONTAINS INFORMATION THAT IS PROPRIETARY TO MOLEX INC. AND SHOULD NOT BE USED WITHOUT WRITTEN PERMISSION. | | DIV. DA | SIZE B |

| ASSEMBLY NUMBER | FINISH (SHT 1) |
|-----------------|----------------|
| 73656-5000 | SEE NOTE 2. |
| 73656-5001 | SEE NOTE 3. |

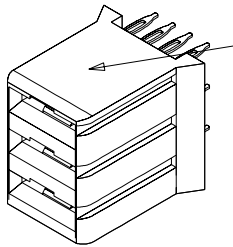

DATE CODE AND PART NUMBER ON THIS SURFACE OR SURFACE OPPOSITE.

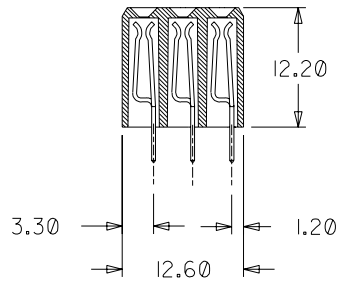
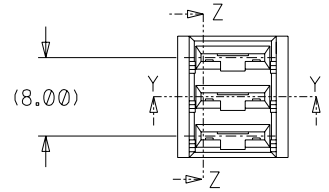
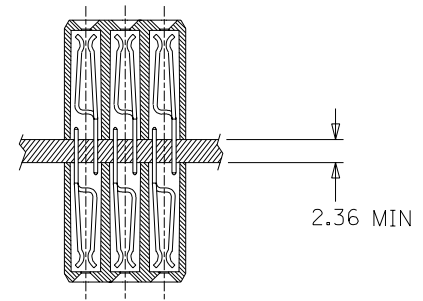

SECTION: Z-Z
ROTATED 90° CW

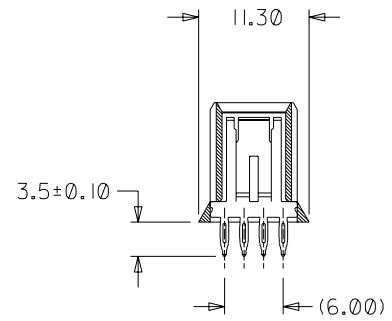

SECTION: Y-Y

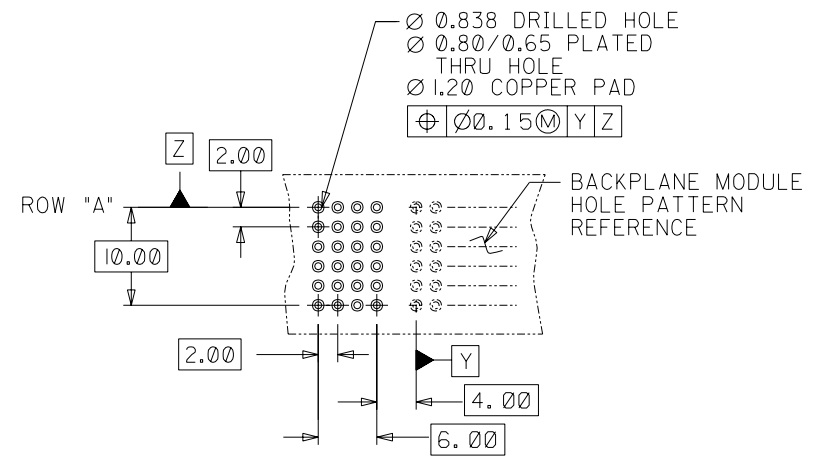

| | | | |
|------|-------------|------|-------------|
| | | B | SEE SHEET I |
| G | SEE SHEET I | AI | SEE SHEET I |
| E | SEE SHEET I | A | SEE SHEET I |
| LTR. | REVISIONS | LTR. | REVISIONS |

| | |
|---|----------------|
| DIMENSIONS SHOWN (METRIC) INCH | |
| UNLESS OTHERWISE SPECIFIED TOLERANCES: ANGULAR ± 1/2° | |
| 3 PLACE | ± N/A --- |
| 2 PLACE | ± N/A ± --- |
| 1 PLACE | --- ± --- |
| DRAFT WHERE APPLICABLE MUST REMAIN WITHIN DIMENSIONS | |
| DRWG. BY: ELO | CHK'D. BY: SMR |
| APP'D BY: BIXLER | SCALE: 2 : 1 |

| | | | |
|---|--------|--|---------------|
| REVISIONS | | REVISE ONLY ON CAD SYSTEM | |
| TITLE: SALES ASSY, HDM BACKPLANE POWER MODULE (PRESS FIT) | | | |
| MOLEX INCORPORATED LISLE, ILL. 60532 U.S.A. | | SHEET NO. 3 | DATE 98/05/21 |
| PART NO. [REDACTED] | | DRWG. NO. SDA-73656-*00* | |
| FILE NAME: S73656X3 DGN | | THIS DRAWING CONTAINS INFORMATION THAT IS PROPRIETARY TO MOLEX INC. AND SHOULD NOT BE USED WITHOUT WRITTEN PERMISSION. | |
| DIV. DA | SIZE B | | |

| | |
|-----------------|-------------|
| ASSEMBLY NUMBER | FINISH |
| 73656-0000 | SEE NOTE 2. |
| 73656-0001 | SEE NOTE 3. |

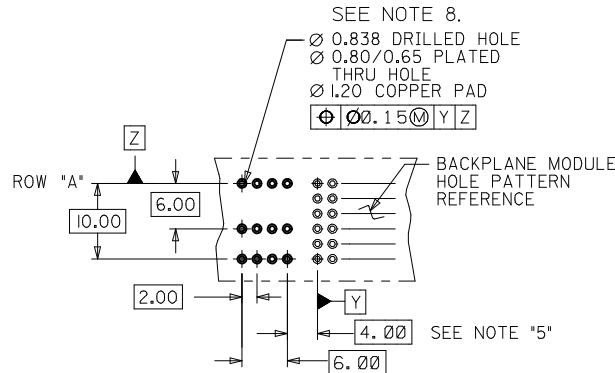
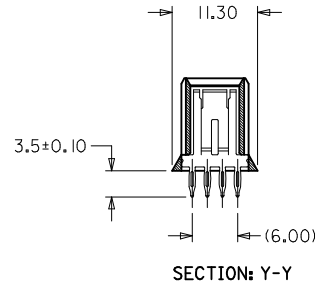
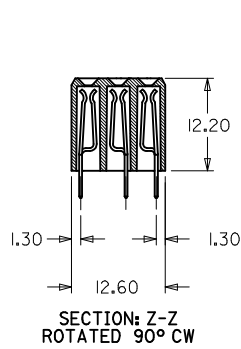
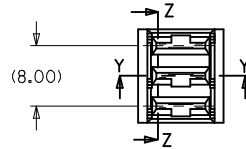
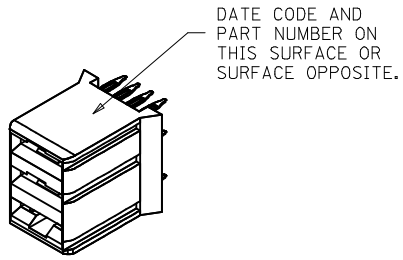

PCB LAYOUT: COMPONENT SIDE
RECOMMENDED PCB THICKNESS: 2.50 MIN

NOTES:

1. MATERIALS: HOUSING - LIQUID CRYSTAL POLYMER (LCP), GLASS-FILLED, UL94V-0, COLOR: BLACK
TERMINAL - COPPER ALLOY
2. FINISH: SELECTIVE GOLD (Au) IN CONTACT AREA, 0.76 micrometer MINIMUM THICKNESS: NICKEL (Ni) AND GOLD FLASH OVERALL
3. FINISH: SELECTIVE GOLD (Au) IN CONTACT AREA, 0.76 micrometer MINIMUM THICKNESS: MATTE TIN (Sn) OVER NICKEL (Ni) IN COMPLIANT AREA: NICKEL (Ni) OVERALL ON REMAINING WITH SELECTIVE GOLD (Au) FLASH.
4. THIS DIMENSION MUST BE A MULTIPLE OF 4.00 mm.
5. DIMENSIONS ARE IN MILLIMETERS.
6. THIS PART CONFORMS TO MOLEX PRODUCT SPECIFICATION PS-73670-9999.
7. PACKAGE ASSEMBLIES PER PK-70873-0819.
8. HOLE SIZE SPECIFICATION IS FOR TIN/LEAD PLATED HOLES ONLY. FOR OTHER PLATING TYPES SEE MOLEX APPLICATION AS-73670-9996.
9. THIS PART CONFORMS TO MOLEX COSMETIC SPECIFICATION PS-45499-002 CLASS B.

| | | | | | | | | | |
|--|--------------------------------------|---------------------------------------|-------|---|---------------------|---|----------------------------------|---------------------------------------|---------------------|
| LEAD FREE CONVERSION EC NO: UCP2013-3253 DRAWN:WHIPPLE 2013/02/04 CHKD:MMOLFE 2013/02/04 APPR:SMILLER 2013/08/05 | QUALITY SYMBOLS ▽=0 ▽=0 ▽=0 | GENERAL TOLERANCES (UNLESS SPECIFIED) | | DIMENSION STYLE MM ONLY | SCALE 1:1 | DESIGN UNITS METRIC | THIRD ANGLE PROJECTION | | |
| | | mm | INCH | DRAWN BY ELO | DATE 1998/05/21 | TITLE SALES ASSY, HDM BACKPLANE POWER MODULE (PRESSFIT) | | | |
| REV: 1 | DESCRIPTION | 4 PLACES | ± --- | ± --- | CHECKED BY SMR | DATE 1998/05/21 | MATERIAL NO. SEE TABLE | DOCUMENT NO. SDA-73656-*00* | SHEET NO. 1 OF 4 |
| | | 3 PLACES | ± --- | ± --- | APPROVED BY CAB | DATE 1998/05/21 | | | |
| DRAFT WHERE APPLICABLE MUST REMAIN WITHIN DIMENSIONS | | ANGULAR ±1/2° | | THIS DRAWING CONTAINS INFORMATION THAT IS PROPRIETARY TO MOLEX INCORPORATED AND SHOULD NOT BE USED WITHOUT WRITTEN PERMISSION | | | | | |

10 9 8 7 6 5 4 3 2 1

DATE CODE AND
PART NUMBER ON
THIS SURFACE OR
SURFACE OPPOSITE.

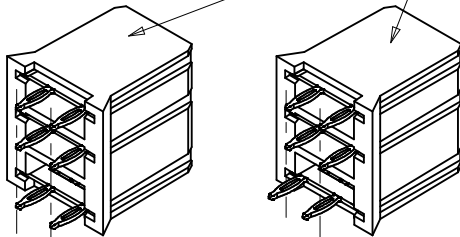

73656-100*

73656-200*

MIDPLANE OPTION

| ASSEMBLY NUMBER | FINISH (SEE SHT 1) |
|-----------------|-----------------------------------|
| 73656-1000 | SEE NOTE 2. (GOLD TAILS) |
| 73656-2000 | |
| 73656-1001 | SEE NOTE 3. *(MATTE TIN TAILS) |
| 73656-2001 | |

* FORMERLY TIN/LEAD

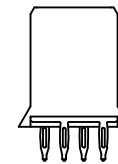
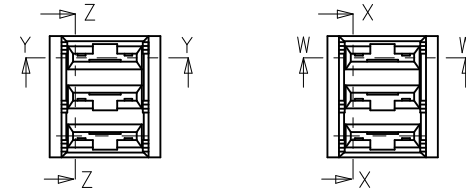

73656-200*

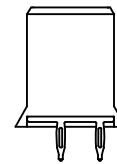

73656-100*

USE BACKPLANE MODULE
HOLE REFERENCE PATTERN
FROM SHEET 1

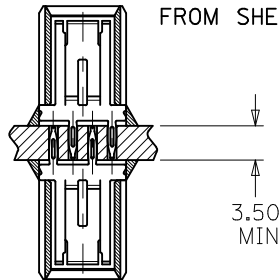

BACK-TO-BACK
MOUNTING APPLICATION

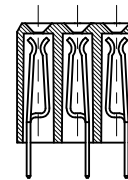

SECTION X-X
SECTION Z-Z
ROTATED 90° CW

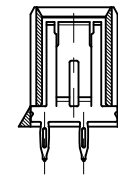

(4.00)
SECTION: Y-Y

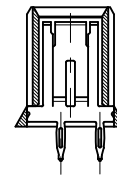

(4.00)
SECTION: W-W

| | | | | | | |
|---|--|--|---|-----------|---|------------------------------------|
| SEE SHEET 1 EC NO: UCP2013-3253 DRAWN: RWHIPPLE 2013/02/04 CHKD: MWOLFE 2013/02/04 APPR: SMILLER 2013/08/05 | QUALITY SYMBOLS | GENERAL TOLERANCES (UNLESS SPECIFIED) | DIMENSION STYLE | SCALE | DESIGN UNITS | THIRD ANGLE PROJECTION |
| | $\nabla = 0$ $\nabla = 0$ $\nabla = 0$ | mm INCH 4 PLACES ± --- ± --- 3 PLACES ± --- ± --- 2 PLACES ± 0.13 ± --- 1 PLACE ± 0.25 ± --- 0 PLACE ± --- ± --- | MM ONLY | 1:1 | METRIC | |
| | DESCRIPTION | ANGULAR ± 1/2° DRAFT WHERE APPLICABLE MUST REMAIN WITHIN DIMENSIONS | DRAWN BY DATE ELO 1998/05/21 CHECKED BY DATE SMR 1998/05/21 APPROVED BY DATE CAB 1998/05/21 | TITLE | SALES ASSY, HDM BACKPLANE POWER MODULE (PRESSFIT) | |
| | REV | | MATERIAL NO. | SEE TABLE | DOCUMENT NO. | SDA-73656-*00* SHEET NO. 2 OF 4 |
| | | | THIS DRAWING CONTAINS INFORMATION THAT IS PROPRIETARY TO MOLEX INCORPORATED AND SHOULD NOT BE USED WITHOUT WRITTEN PERMISSION | | | |

9 8 7 6 5 4 3 2 1

| | | | | | | | | | |
|-----------------|---|----------------|---|---|---|---|---|---|---|
| 10 | 9 | 8 | 7 | 6 | 5 | 4 | 3 | 2 | 1 |
| ASSEMBLY NUMBER | | FINISH (SHT 1) | | | | | | | |
| 73656-5000 | | SEE NOTE 2. | | | | | | | |
| 73656-5001 | | SEE NOTE 3. | | | | | | | |

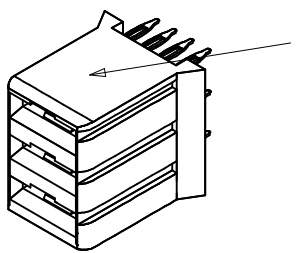

DATE CODE AND PART NUMBER ON THIS SURFACE OR SURFACE OPPOSITE.

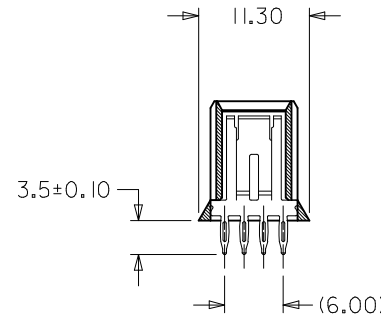
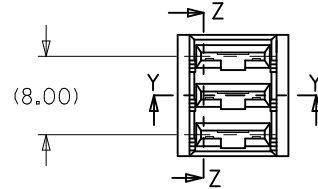

SECTION: Y-Y

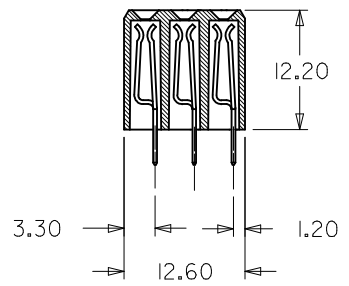

SECTION: Z-Z ROTATED 90° CW

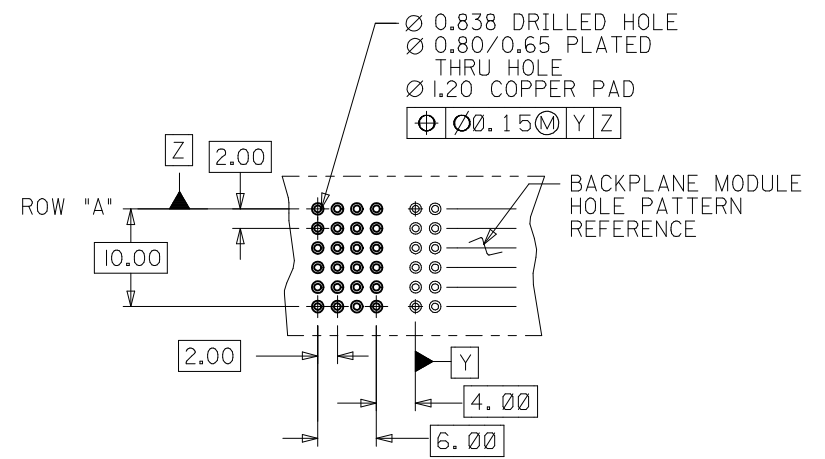
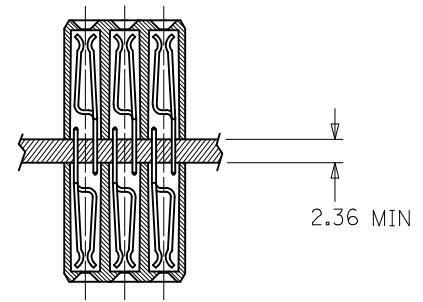

| SEE SHEET 1 EC NO: UCP2013-3253 DRW:RWHIPPLE 2013/02/04 CHKD:MWOLFE 2013/02/04 APPR:SMILLER 2013/08/05 | QUALITY SYMBOLS | GENERAL TOLERANCES (UNLESS SPECIFIED) | DIMENSION STYLE | SCALE | DESIGN UNITS | THIRD ANGLE PROJECTION | | | | | | | | | | | | | | | | | | |
|--|--|---|--------------------------------|---------------------|--------------|---|-------|-------|----------|-------|-------|----------|--------|-------|---------|--------|-------|---------|-------|-------|---------|-----|--------|--|
| | $\nabla = 0$ $\nabla = 0$ $\nabla = 0$ | <table border="1"> <tr> <th></th> <th>mm</th> <th>INCH</th> </tr> <tr> <td>4 PLACES</td> <td>± ---</td> <td>± ---</td> </tr> <tr> <td>3 PLACES</td> <td>± ---</td> <td>± ---</td> </tr> <tr> <td>2 PLACES</td> <td>± 0.13</td> <td>± ---</td> </tr> <tr> <td>1 PLACE</td> <td>± 0.25</td> <td>± ---</td> </tr> <tr> <td>0 PLACE</td> <td>± ---</td> <td>± ---</td> </tr> </table> | | mm | INCH | 4 PLACES | ± --- | ± --- | 3 PLACES | ± --- | ± --- | 2 PLACES | ± 0.13 | ± --- | 1 PLACE | ± 0.25 | ± --- | 0 PLACE | ± --- | ± --- | MM ONLY | 1:1 | METRIC | |
| | | mm | INCH | | | | | | | | | | | | | | | | | | | | | |
| | 4 PLACES | ± --- | ± --- | | | | | | | | | | | | | | | | | | | | | |
| 3 PLACES | ± --- | ± --- | | | | | | | | | | | | | | | | | | | | | | |
| 2 PLACES | ± 0.13 | ± --- | | | | | | | | | | | | | | | | | | | | | | |
| 1 PLACE | ± 0.25 | ± --- | | | | | | | | | | | | | | | | | | | | | | |
| 0 PLACE | ± --- | ± --- | | | | | | | | | | | | | | | | | | | | | | |
| DRAWN BY: ELO CHECKED BY: SMR APPROVED BY: CAB DATE: 1998/05/21 | MATERIAL NO. SEE TABLE SIZE: B | TITLE SALES ASSY, HDM BACKPLANE POWER MODULE (PRESSFIT) | DOCUMENT NO. SDA-73656-*00* | SHEET NO. 3 OF 4 | | | | | | | | | | | | | | | | | | | | |
| ANGULAR ±1/2° DRAFT WHERE APPLICABLE MUST REMAIN WITHIN DIMENSIONS | | | | | | THIS DRAWING CONTAINS INFORMATION THAT IS PROPRIETARY TO MOLEX INCORPORATED AND SHOULD NOT BE USED WITHOUT WRITTEN PERMISSION | | | | | | | | | | | | | | | | | | |

| | | | | | | | | | |
|-----------------|---|-------------|---|---|---|---|---|---|---|
| 10 | 9 | 8 | 7 | 6 | 5 | 4 | 3 | 2 | 1 |
| ASSEMBLY NUMBER | | FINISH | | | | | | | |
| 73656-0180 | | SEE NOTE 2. | | | | | | | |
| 73656-0181 | | SEE NOTE 3. | | | | | | | |

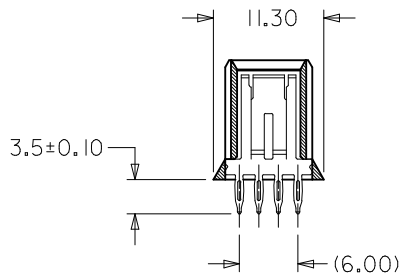
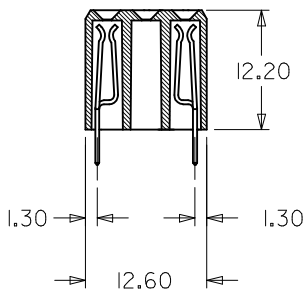
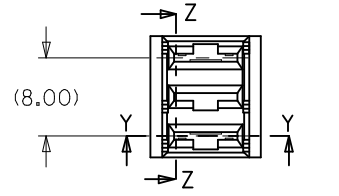
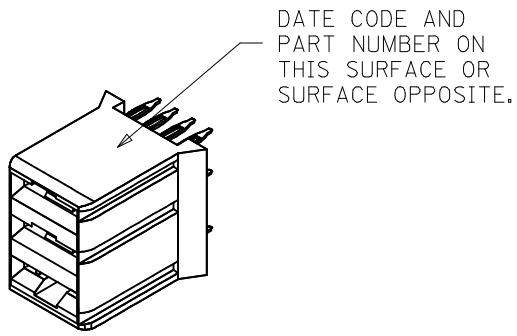

SECTION: Y-Y

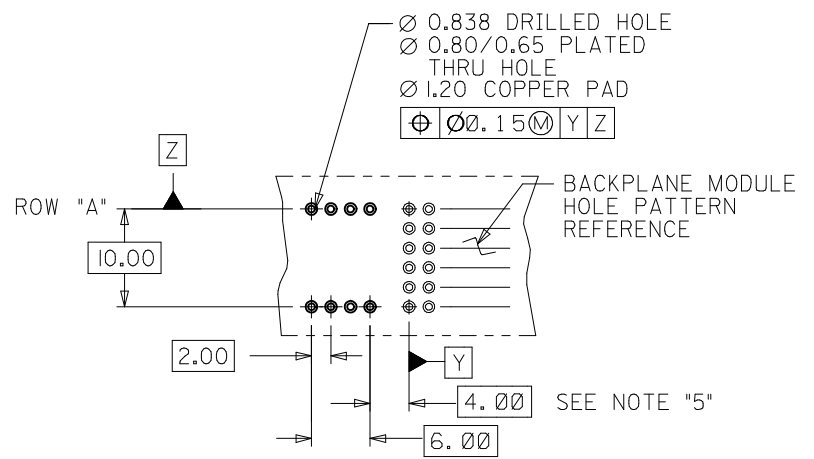

PCB LAYOUT: COMPONENT SIDE
RECOMMENDED PCB THICKNESS: 2.50 MIN

| | | | | | | |
|--|-----------------------|--|-----------------|---|--|------------------------|
| SEE SHEET 1 EC NO: UCP2013-3253 DRWN:RWH/PPLE 2013/02/04 CHKD:MM/LFE 2013/02/04 APPR:SMILLER 2013/08/05 | QUALITY SYMBOLS | GENERAL TOLERANCES (UNLESS SPECIFIED) | DIMENSION STYLE | SCALE | DESIGN UNITS | THIRD ANGLE PROJECTION |
| | ▽=0 | mm INCH | MM ONLY | 1:1 | METRIC | THIRD ANGLE PROJECTION |
| | ▽=0 | 4 PLACES ± --- ± --- | DRAWN BY DATE | TITLE | SALES ASSY, HDM BACKPLANE POWER MODULE (PRESSFIT) | |
| | ▽=0 | 3 PLACES ± --- ± --- | ELO 1998/05/21 | | | |
| ▽=0 | 2 PLACES ± 0.13 ± --- | CHECKED BY DATE | SMR 1998/05/21 | | | |
| ▽=0 | 1 PLACE ± 0.25 ± --- | APPROVED BY DATE | CAB 1998/05/21 | | | |
| REV | DESCRIPTION | ANGULAR ±1/2° DRAFT WHERE APPLICABLE MUST REMAIN WITHIN DIMENSIONS | MATERIAL NO. | DOCUMENT NO. | SHEET NO. | |
| | | | SEE TABLE | SDA-73656-*00* | 4 OF 4 | |
| | | | SIZE B | THIS DRAWING CONTAINS INFORMATION THAT IS PROPRIETARY TO MOLEX INCORPORATED AND SHOULD NOT BE USED WITHOUT WRITTEN PERMISSION | | |