

# PLUGGABLE WITH PIN STRIPS

These unique modular terminal blocks are convenient and easy to use. They may be interlocked to achieve the required number of positions. The header pins, for both the 6 and 10 Amp models are

supplied in strips of 24. Simply snap off the desired number of positions required and insert into PC board. The modular terminal block can be plugged into the header strip at anytime.

- Space saving low profile design
- Easy access horizontal wire entry
- Convenient screw head access on top of terminal block
- Headers mount easily in pre-drilled or stamped holes
- Wire guards help prevent damage to conductors

- Accepts #22-16 AWG wire
- Because of accumulating tolerances, we recommend a maximum of 24 positions per row
- Header strips and terminal blocks sold separately

## SPECIFICATIONS

### MATERIAL:

**Contact:** Brass, Tin Plate  
**Header Pins:** Brass, Tin Plate  
**Housing:** Blue PBT, UL Rated 94V-0  
**Screw:** Steel, Zinc Plate & Clear Chromate (captivated)

### ELECTRICAL:

**Dielectric Strength:** 2500V  
**Insulation Breakdown:** 1500V AC/min.  
**Rated voltage:** 250V

### MECHANICAL:

**Operating Temp:** 22°F to 248°F (-30°C to 120°C)  
**Peak Temp:** +393°F (+200°C)

### HORIZONTAL ENTRY

- Use header strip to connect to PCB

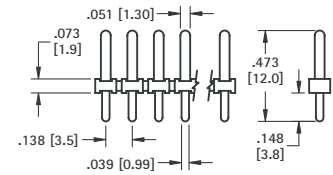
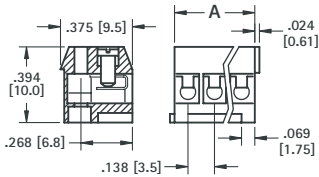

Recommended Mtg. Hole Size: .047(1.19)



Pin Header Strips  
(24 pins per strip)

**CAT. NO. 8724**

3.5mm SPACING			
CAT. NO.	POSITIONS	A DIM.	CURRENT RATING
8722	2	.276 (7.0)	6 Amps
8723	3	.413 (10.5)	

### HORIZONTAL ENTRY

- Use header strip to connect to PCB

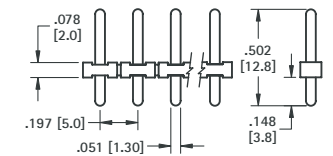
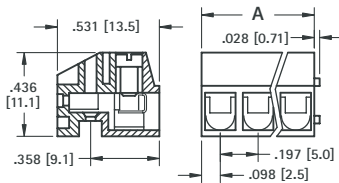

Recommended Mtg. Hole Size: .059 (1.50)



Pin Header Strips  
(24 pins per strip)

**CAT. NO. 8727**

5mm SPACING			
CAT. NO.	POSITIONS	A DIM.	CURRENT RATING
8725	2	.394 (10.0)	10 Amps
8726	3	.591 (15.0)	

### NOTES

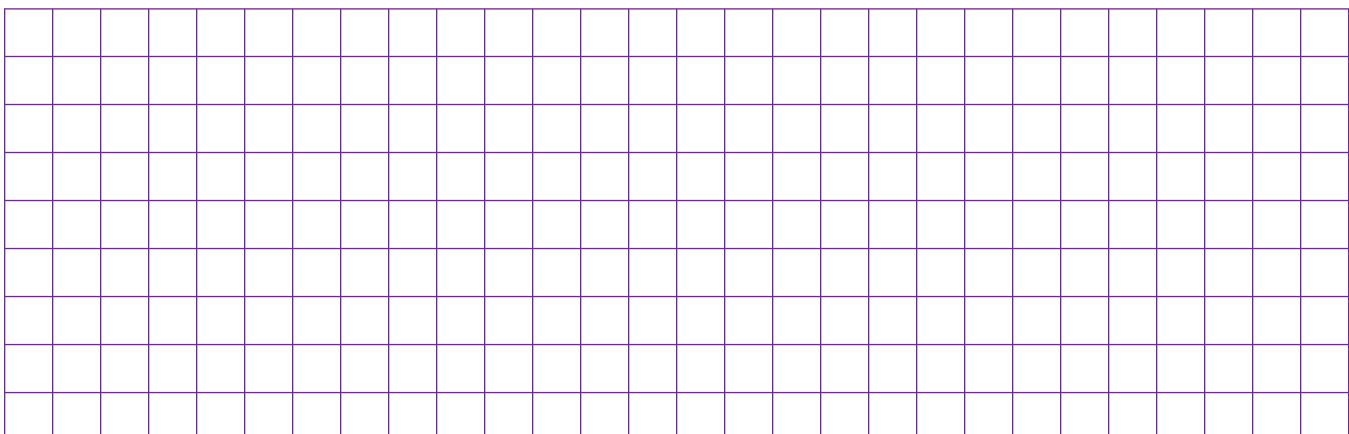

# Mouser Electronics

Authorized Distributor

Click to View Pricing, Inventory, Delivery & Lifecycle Information:

[Keystone Electronics:](#)

[8723](#) [8724](#)