

DETAILS

Product Number	C13757_STRADA-SQ-FS-NP
Family	Strada-SQ
Type	Lens
Color	clear
Diameter	25x25 mm
Height	12,4 mm
Style	square
Optic Material	PMMA
Holder Material	
Fastening	glue
Status	ready
ROHS Compliant	Yes
Date Updated	9/05/2014

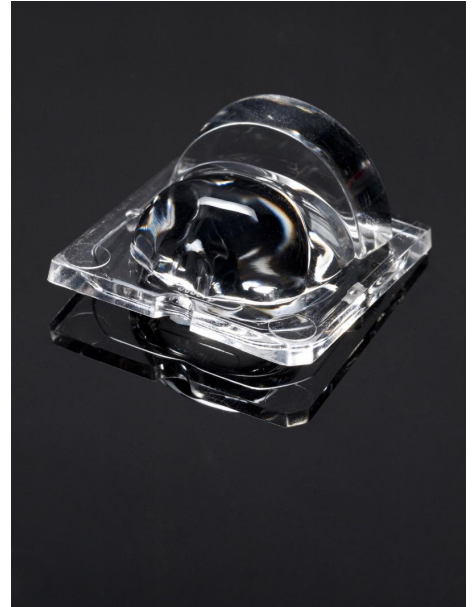

OPTICAL PROPERTIES

LED	Viewing Angle	Light Beam	Efficiency	cd/lm	connector
LUXEON M	Asym degrees		92 %	0.900	-
MK-R	Asym degrees		93 %	0.900	-
XP-L	Asymmetric degrees		94 %	1.100	-
XT-E	Asym degrees		93 %	1.200	-
XM-L	Asym degrees		93 %	1.200	-

D

C

B

A

4

4

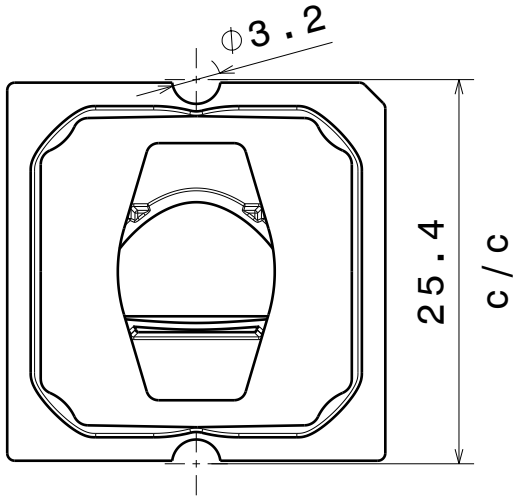

Bottom view

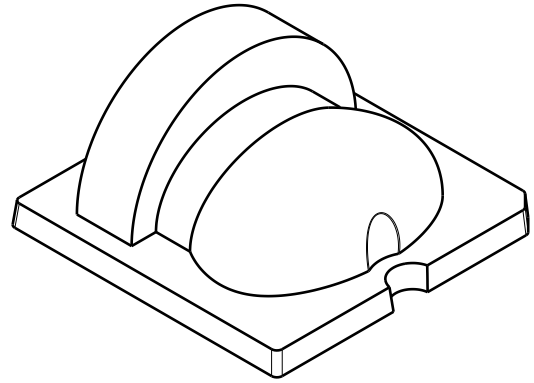

Isometric view

3

3

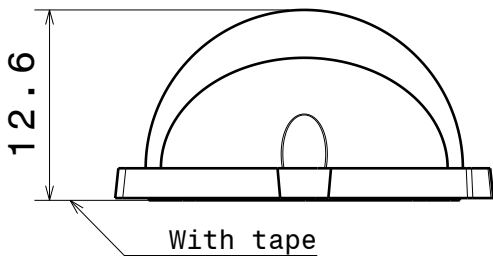

Front view

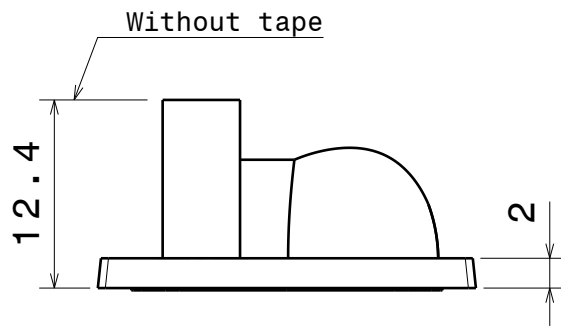

Left view

2

2

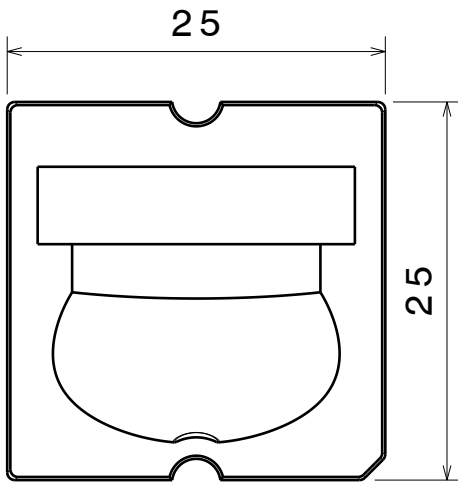

Top view

Tolerances if not otherwise shown
 According to DIN ISO 2768-1
 Linear measures:
 Up to 30mm class M, otherwise class C.
 According to DIN ISO 2768-2
 Form and position: class L

LEDiL Ledil Oy
 Salorankatu 10
 FIN 24240 SALO
 Finland

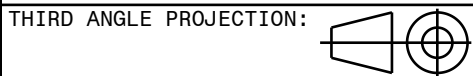

DRAWING TITLE

STRADA-SQ-FS-NP

This drawing is the property
 of LEDiL Oy. It may not be
 reproduced, copied or
 communicated without a written
 agreement with LEDiL Oy."

SIZE	PART NUMBER
A4	-

SCALE	2:1	WEIGHT	- g	SHEET	1/1
-------	-----	--------	-----	-------	-----

D

A

1

1

Luminaire: LEDiL Oy C13757_STRADA-SQ-FS-NP_(LUXEON_M) Eff.92.4%
Lamps: 1 x LUXEON_M_349.54lm@250mA_CCT=4092K_P=2.72807W_I=249.8mA

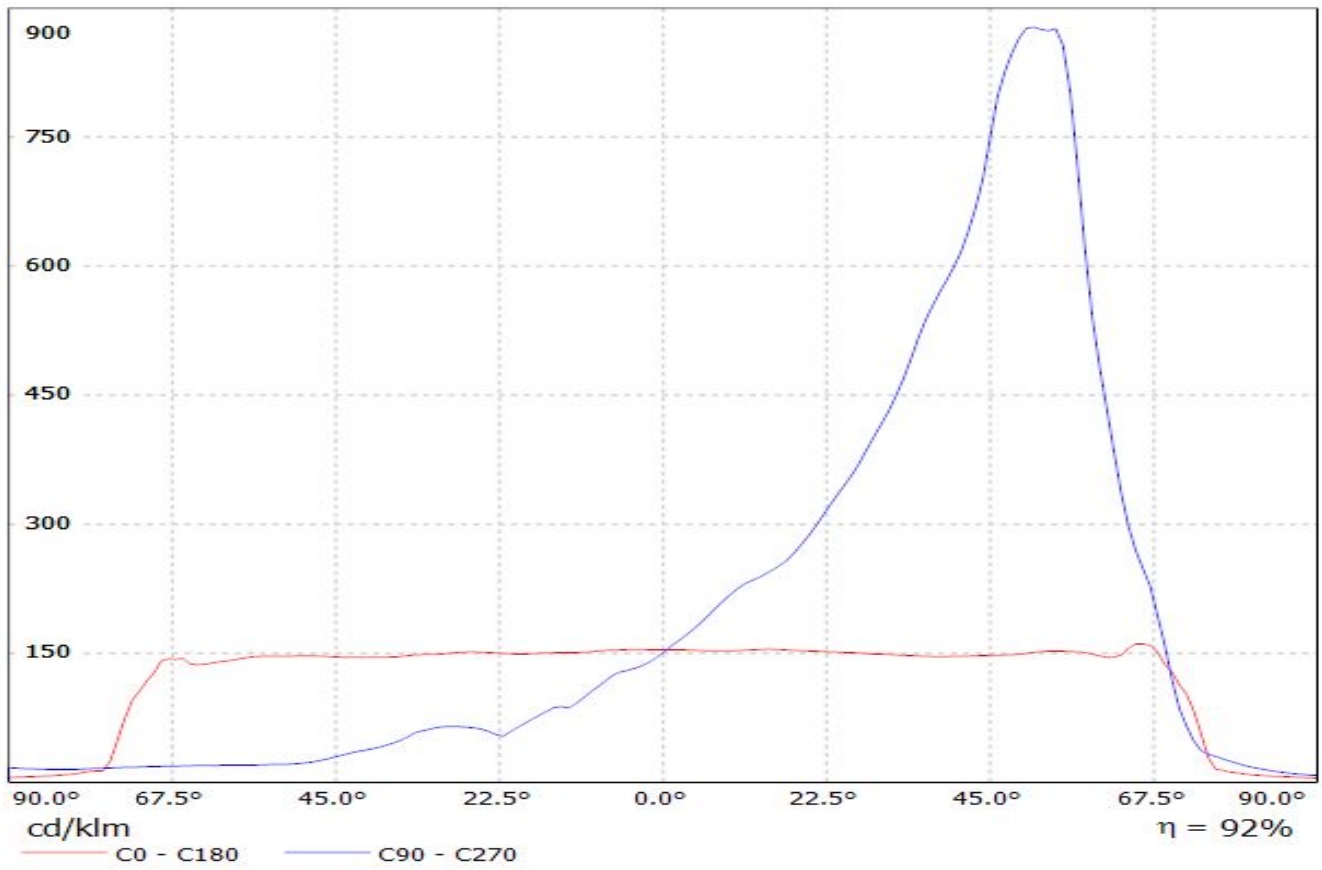

Luminaire: LEDiL Oy C13757_STRADA-SQ-FS-NP_(MK-R) Eff.92.6%
Lamps: 1 x CREE_MK-R_358.348lm@250mA_P=2.84311W_I=249.9mA

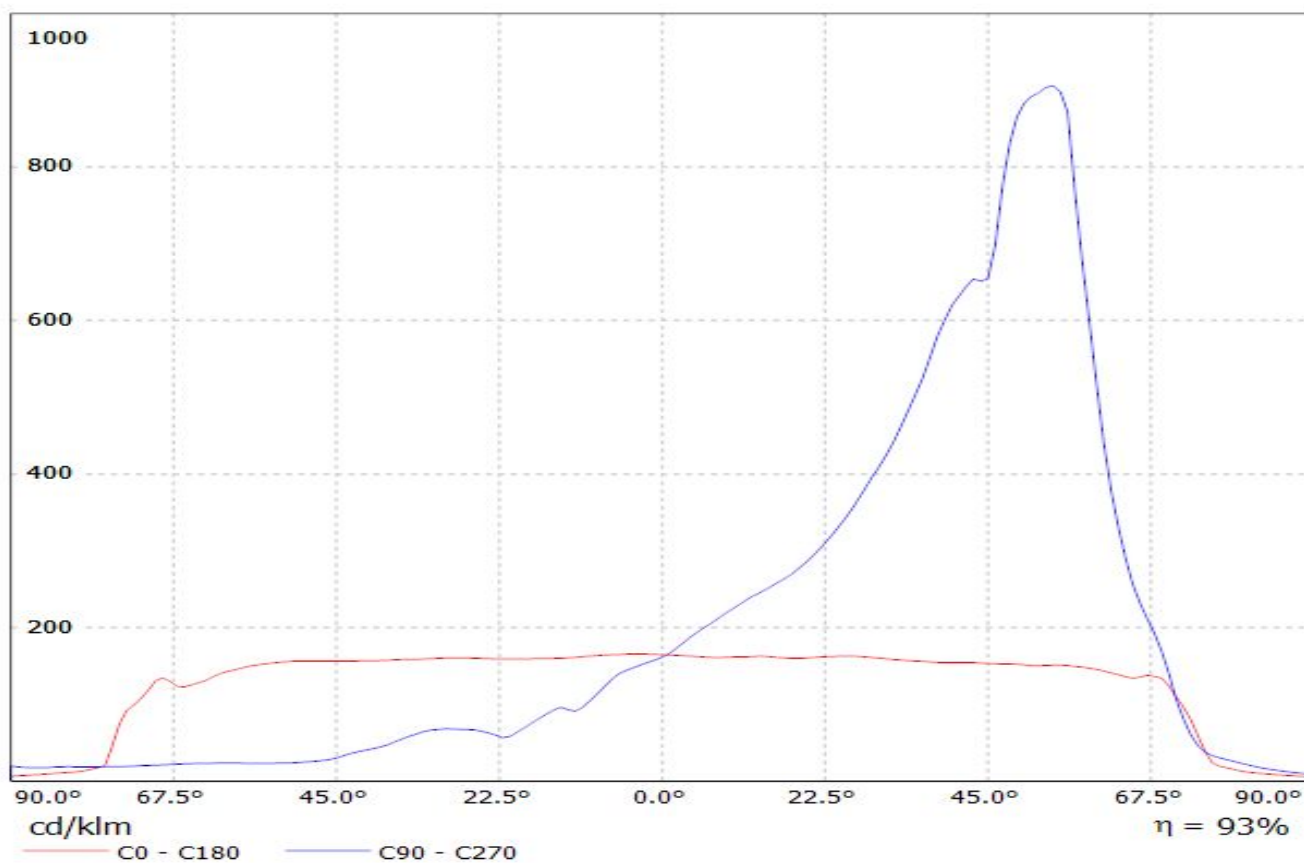

Luminaire: LEDiL Oy C13757_STRADA-SQ-FS-NP_(XP-L)
Lamps: 1 x Cree_XP-L_125.584lm@250mA_P=0.738255W_I=249.9mA

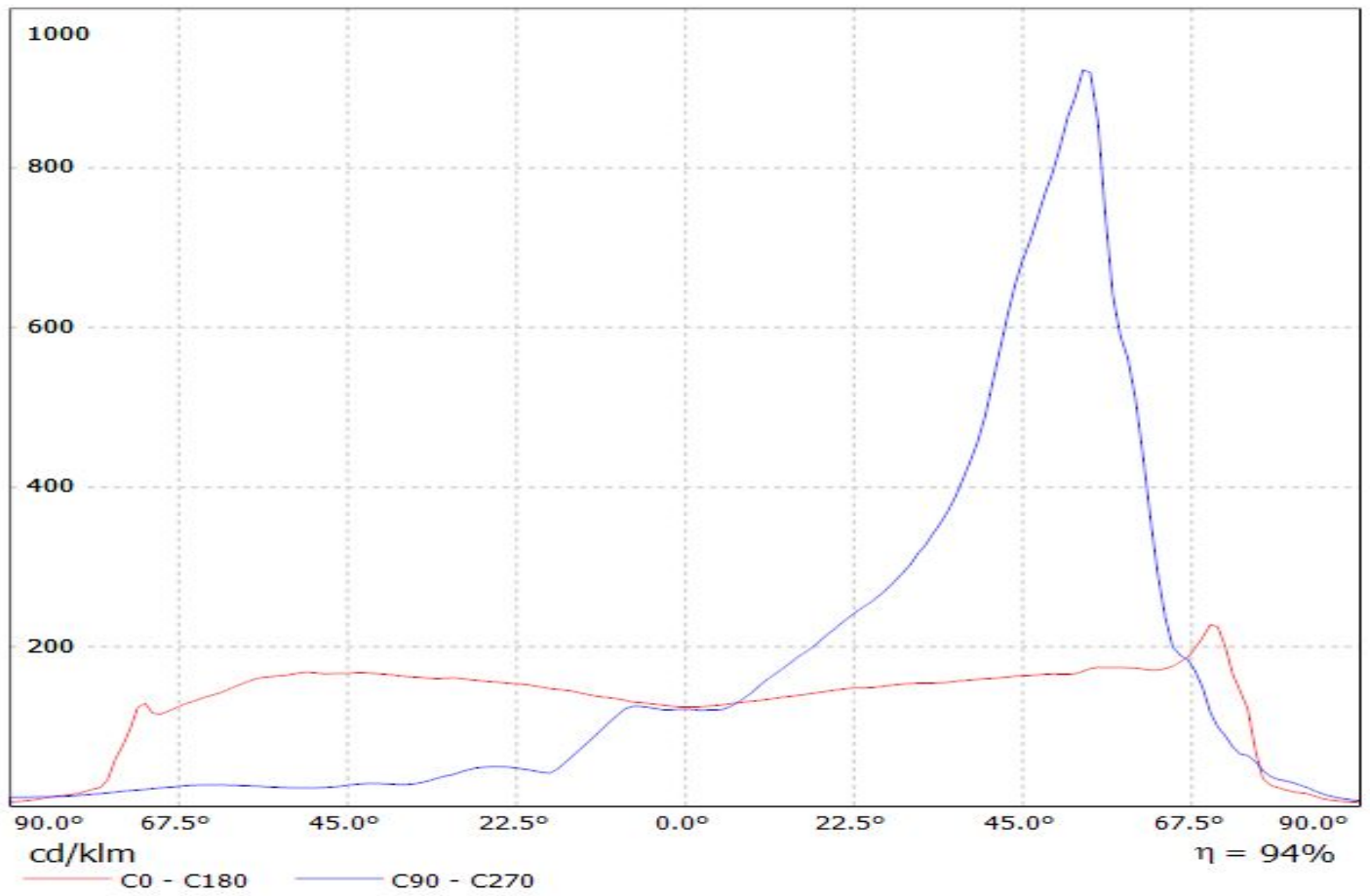

Luminaire: LEDiL Oy C13757_STRADA-SQ-FS-NP_(XM-L) Eff.93.1%
Lamps: 1 x CREE_XM-L_(XMLAWT-00-0000-0000T6051)_100.386lm@259mA_P=0.724735W_I=249.9mA

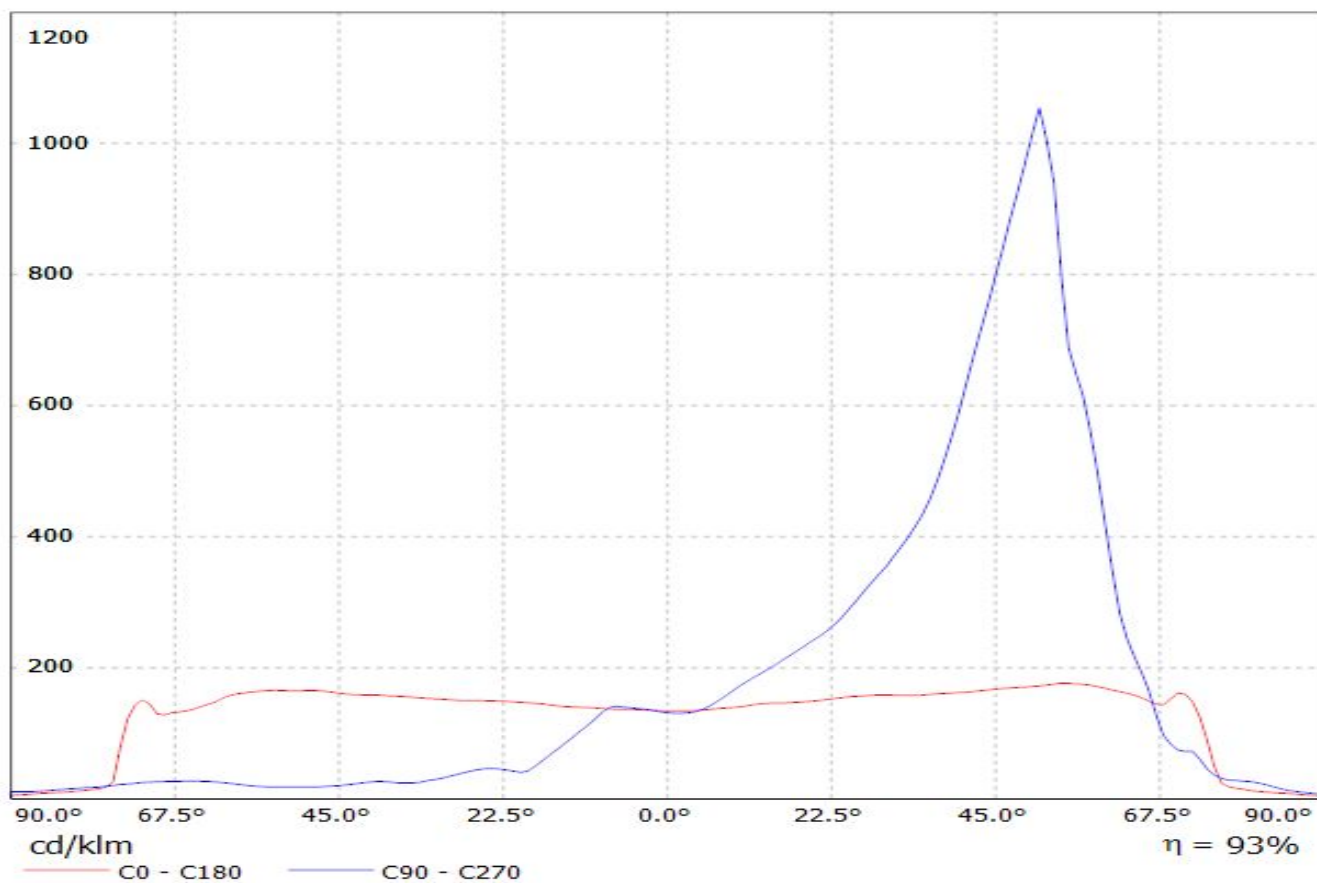

Luminaire: LEDiL Oy C13757_STRADA-SQ-FS-NP_(LUXEON_M) Eff.92.4%
Lamps: 1 x LUXEON_M_349.54lm@250mA_CCT=4092K_P=2.72807W_I=249.8mA

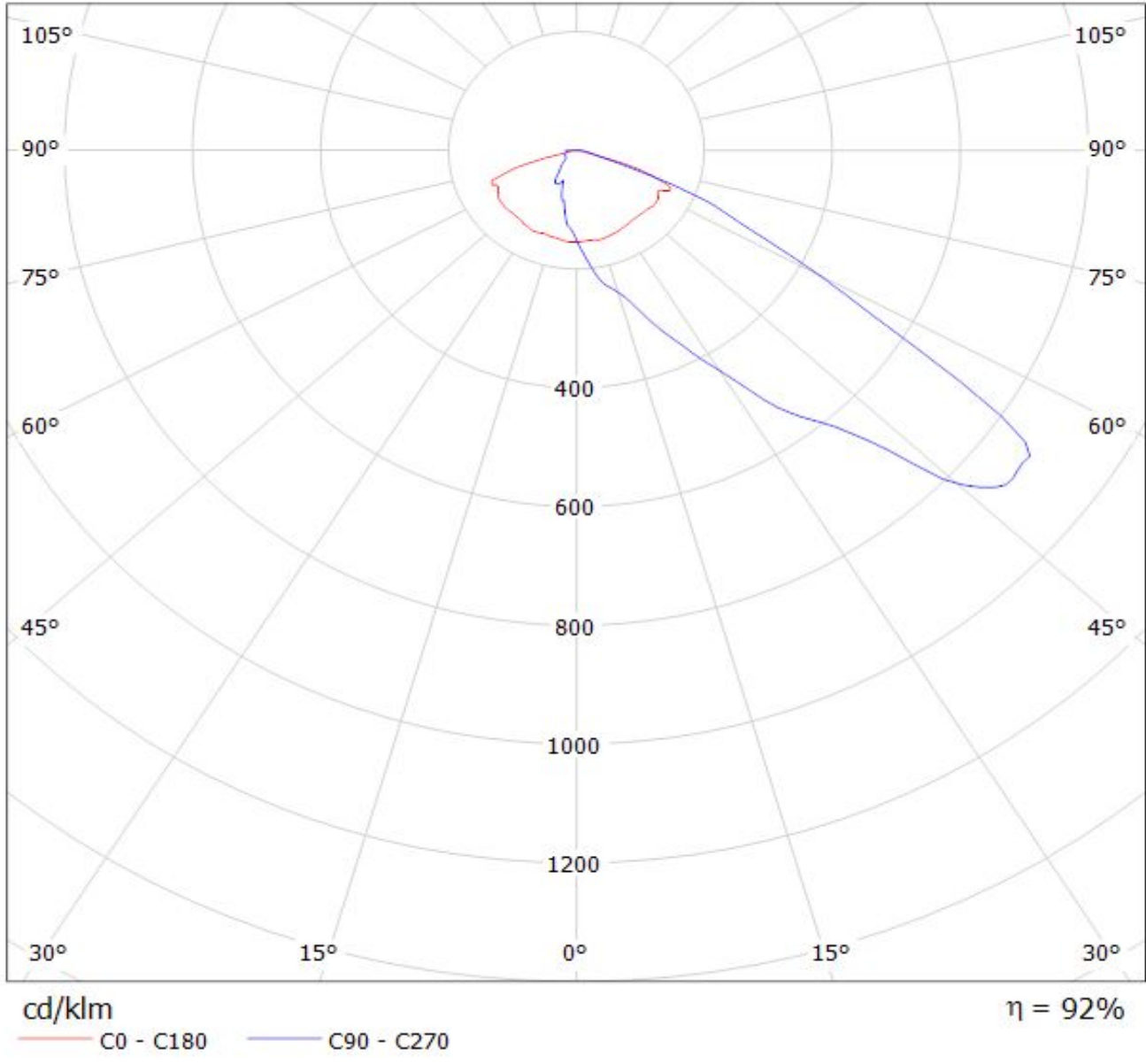

Luminaire: LEDiL Oy C13757_STRADA-SQ-FS-NP_(MK-R) Eff.92.6%
Lamps: 1 x CREE_MK-R_358.348lm@250mA_P=2.84311W_I=249.9mA

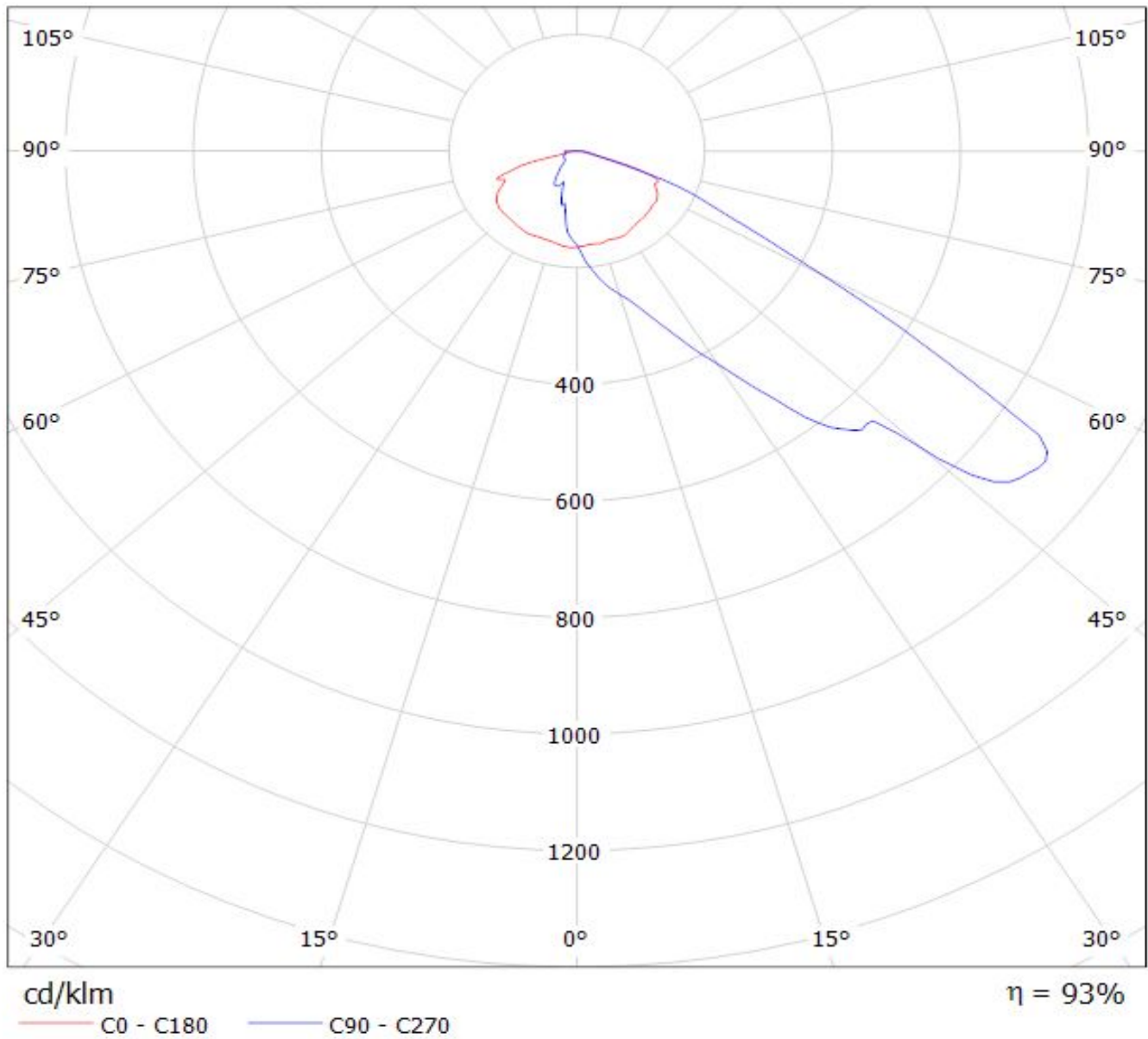

Luminaire: LEDiL Oy C13757_STRADA-SQ-FS-NP_(XP-L)

Lamps: 1 x Cree_XP-L_125.584lm@250mA_P=0.738255W_I=249.9mA

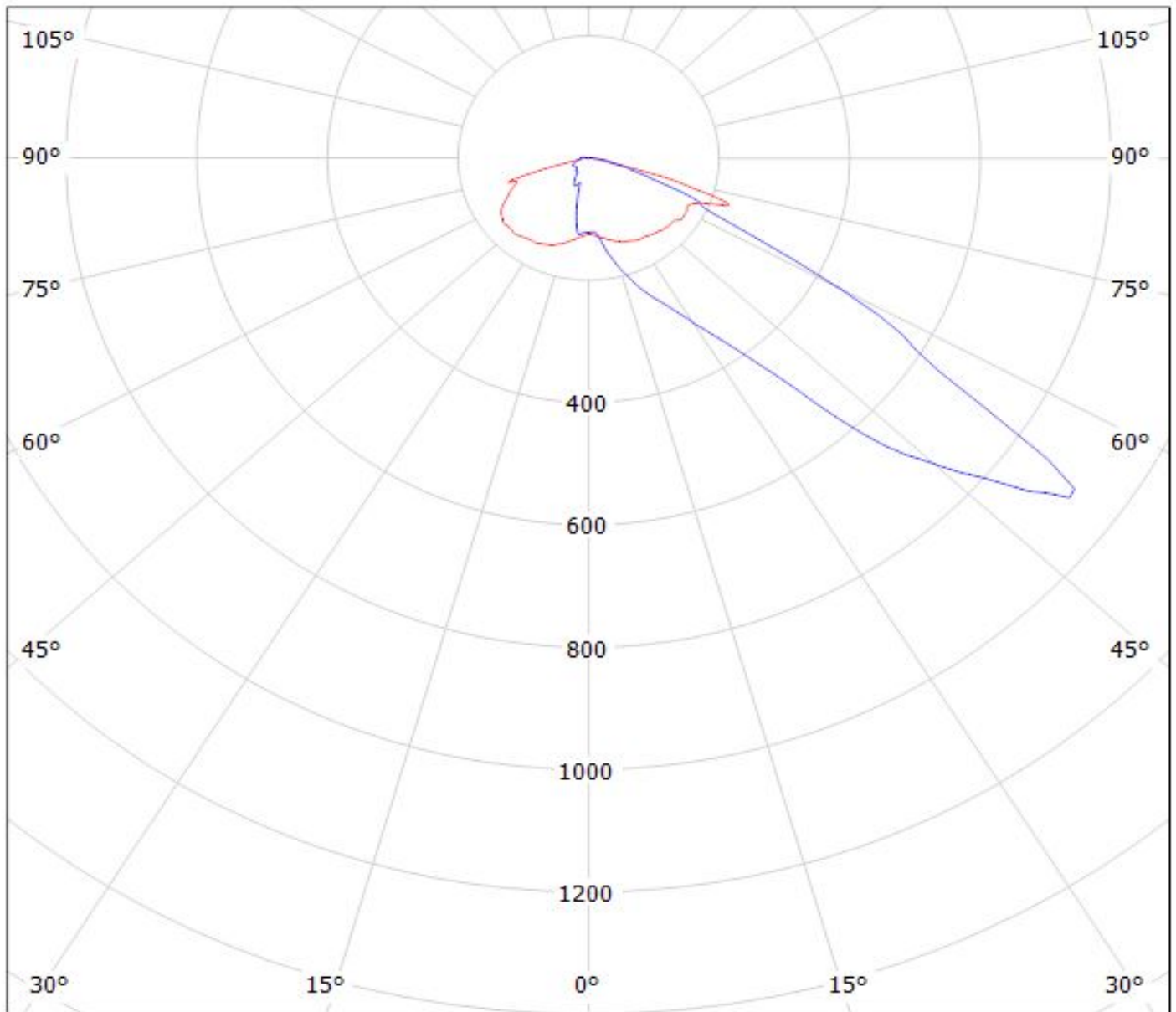

cd/klm

— C0 - C180

— C90 - C270

$\eta = 94\%$

Luminaire: LEDiL Oy C13757_STRADA-SQ-FS-NP_(XT-E) Eff.93.0%
Lamps: 1 x CREE_XT-E_(XTEAWT-00-0000-00000HBE8)_73.2149lm@250mA_P=0.779476W_I=249.9mA

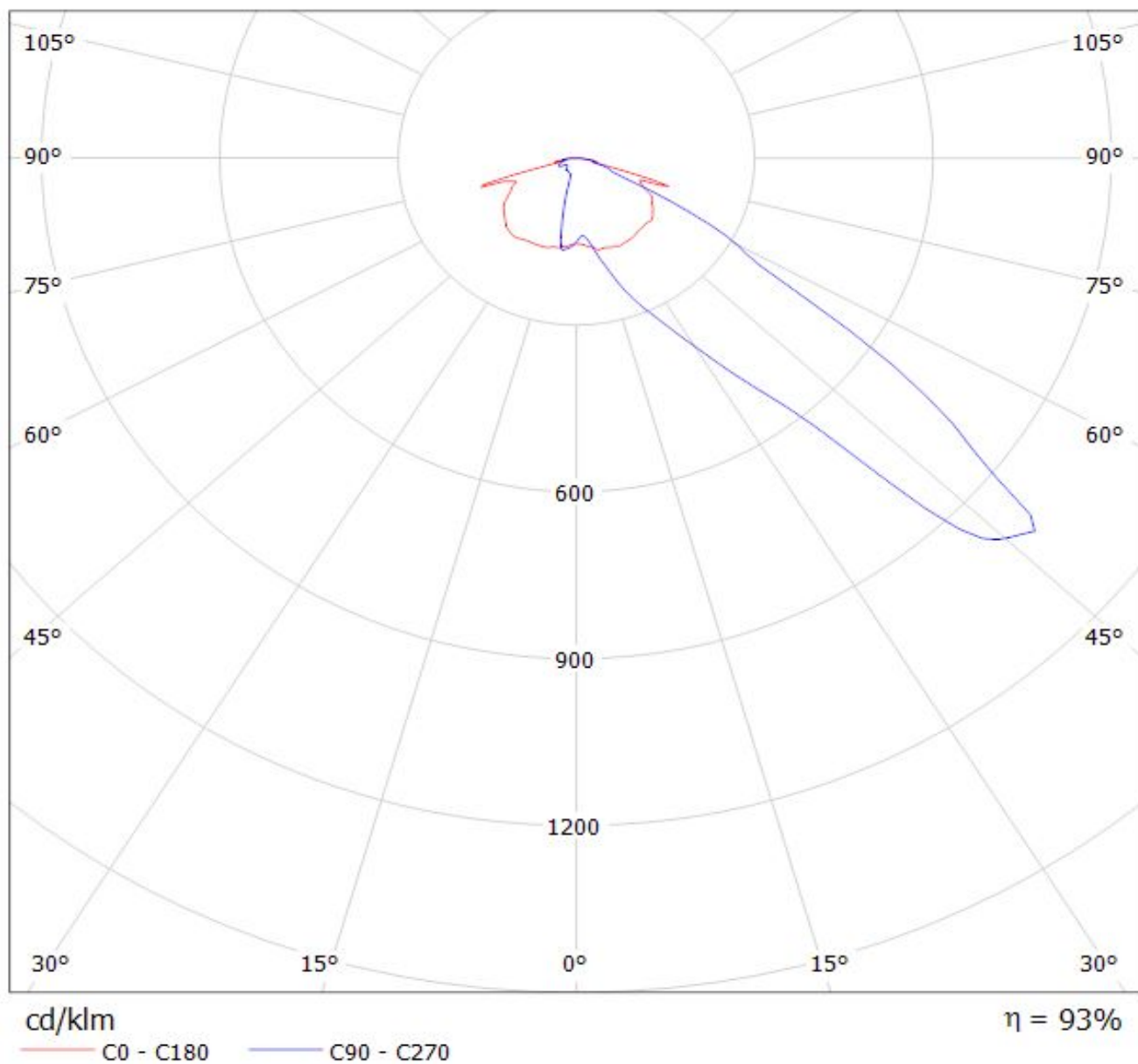

Luminaire: LEDiL Oy C13757_STRADA-SQ-FS-NP_(XM-L) Eff.93.1%

Lamps: 1 x CREE_XM-L_(XMLAWT-00-0000-0000T6051)_100.386lm@259mA_P=0.724735W_I=249.9mA

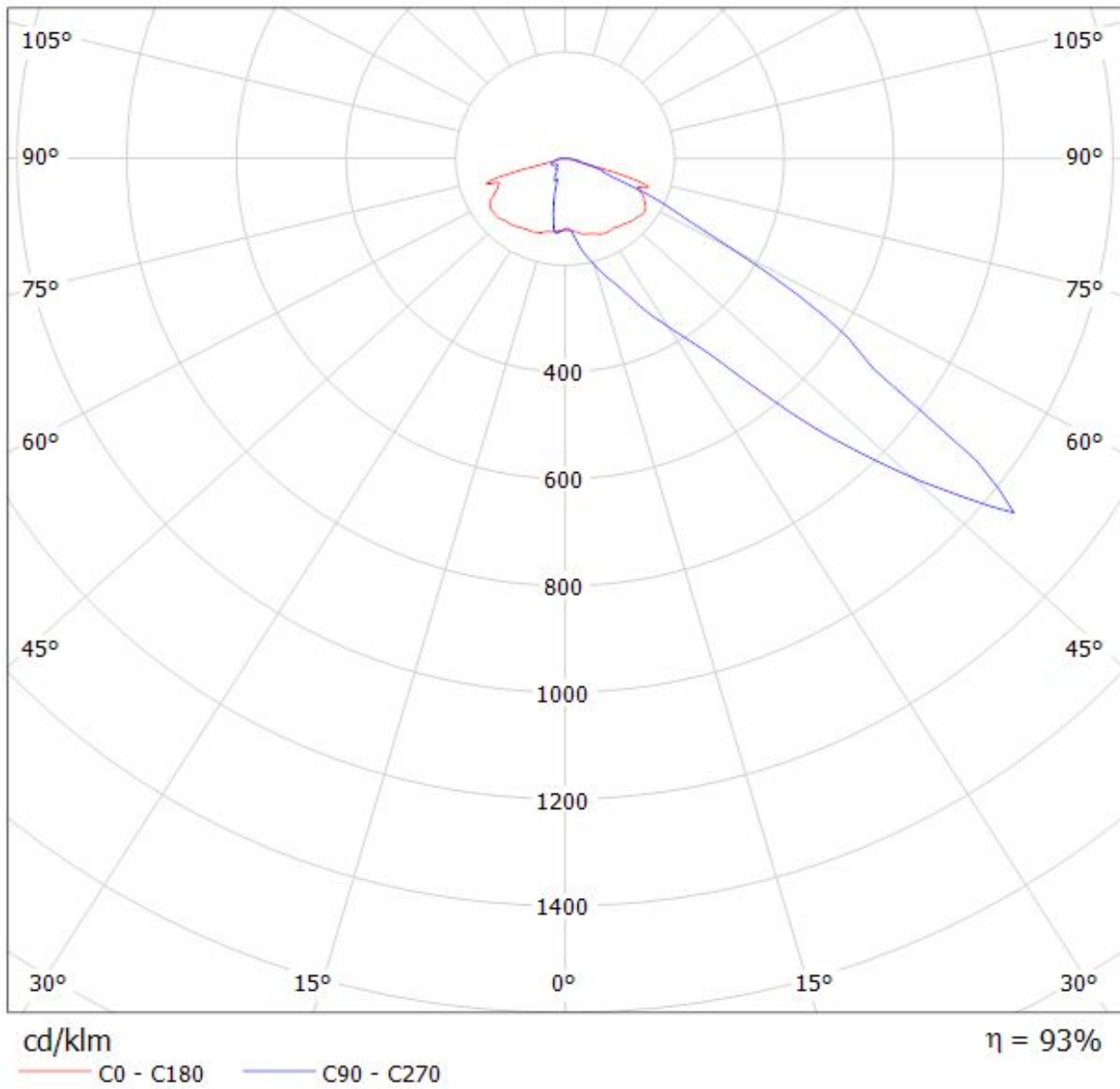

NOTE: The typical divergence will be changed by different color, chip size and chip position tolerance. The typical total divergence is the full angle measured where the luminous intensity is half of the peak value.

GENERAL INFORMATION

- Product series especially designed & optimized for series of LEDs.
- Special care taken to make light distribution as uniform as possible.
- Fastening to PCB with appropriate adhesive. By clicking link below you can find Ledil recommended glue options.
http://www.ledil.com/datasheets/DataSheet_GLUES.pdf

NOTE 1: We advise customer to ensure the suitability and sufficiency of the bond in the end product. For example, mechanical stress, vibration and holes on the surface of the circuit board weaken the strength of the glue.

NOTE 2: All surfaces where glue is applied must be clean, dry and free from grease and dirt. If cleaning of PCB surfaces is needed, please follow strictly the cleaning instructions of your LED manufacturer -this is important as cleaning shall under no circumstances damage LEDs or other electronics components on the PCB.

Further note that optical components shall not be cleaned with any chemicals - only micro fiber cloth may be used to remove fingerprints or other traces from handling.