

REVISIONS					
REV	ECO	DESCRIPTION	DATE	BY	APPR
A3	-	RELEASE NEW DWG FORMAT	10/23/13	DRP	-

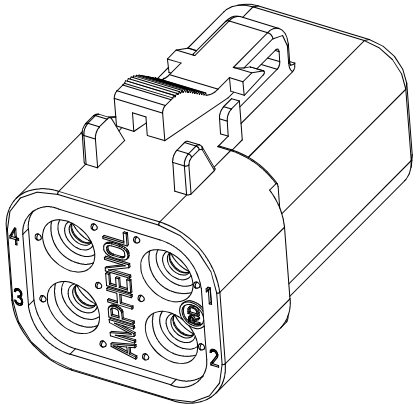
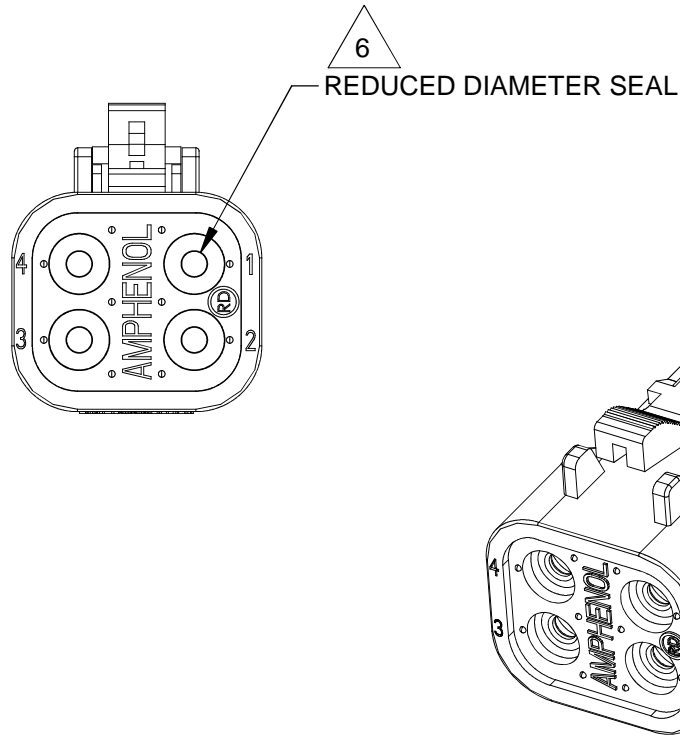
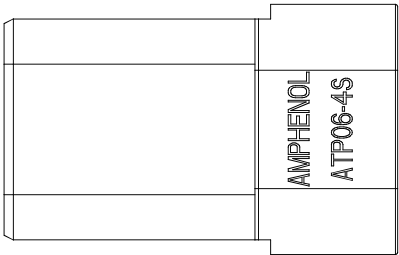
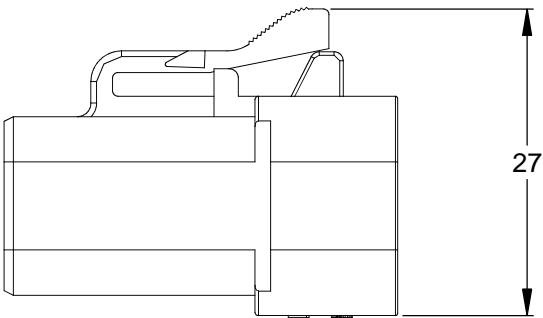
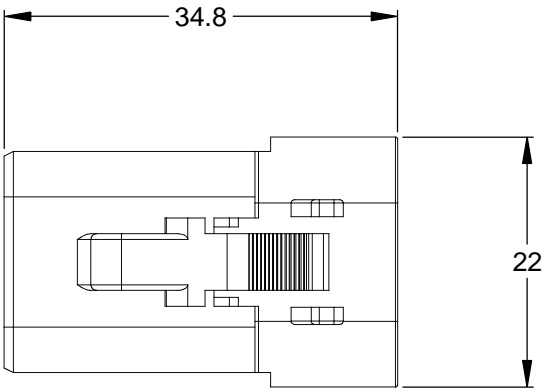

REQUIRES CONTACT
RETENTION WEDGE
AWP-4S

NOTES:

1. MATERIAL:
HOUSING: THERMOPLASTIC
SEAL: SILICONE RUBBER
2. MODIFICATIONS: REDUCED DIAMETER WIRE SEAL
3. SPECIFICATIONS:
- 3.1 CURRENT RATING: 25 AMPS
 - 3.2 OPERATING TEMPERATURE: -55°C TO +125°C
 - 3.3 DIELECTRIC WITHSTANDING VOLTAGE: LESS THAN 2 MILLIAMPS CURRENT LEAKAGE @ 1500 VOLTS AC.
 - 3.4 INSULATION RESISTANCE: 1000 MEGOHMS MIN @ 25°C.
 - 3.5 MOISTURE RESISTANCE: IP67 (MATED CONDITION)
 - 3.6 MATING CYCLE DURABILITY: 100 CYCLES
 - 3.7 RoHS COMPLIANT
4. MATING PART: ATP04-4P* RECEPTACLE.
(* = MODIFICATIONS AND COLORS)

5. ALL DIMENSIONS ARE FOR REFERENCE USE ONLY.

6 CONTACT SIZE AND REAR SEAL WIRE RANGE:

CONTACT SIZE	MIN. INSUL O.D.	MAX. INSUL O.D.	TYPICAL WIRE RANGE
12	2.46 mm (.097 in)	4.01 mm (.158 in)	12-14 AWG

PART NUMBER CHART	
COLOR	PART NUMBER
GREY	ATP06-4S-RD01
BLACK	ATP06-4S-RD01BK

STANDARD MOLDED COLOR IS GREY. ADDITIONAL
COLOR (BLACK) IS AVAILABLE VIA SPECIAL ORDER.

	SEE PART NUMBER CHART			
	PART NUMBER		DESCRIPTION	
ITEM				
QUANTITY	MATERIALS LIST			
<div>UNLESS OTHERWISE SPECIFIED</div> <div>1) All dimensions are in metric(mm).</div> <div>2) Tolerances are as follows:</div> <div>1 PL DEC ±0.30</div> <div>2 PL DEC ±0.15</div> <div>3 PL DEC ±0.08</div> <div>3) Note reference = <div><div>X</div></div></div>		<div>SIGNATURES</div> <div>DRAWN: D.PARKS</div> <div>CHECKED:</div> <div>ENGINEER:</div> <div>APPROVAL:</div> <div>CUSTOMER:</div> <div>THIS DRAWING IS SUPPLIED FOR INFORMATION ONLY. DESIGN FEATURES, SPECIFICATIONS AND PERFORMANCE DATA SHOWN HEREON ARE THE PROPERTY OF THE AMPHENOL CORPORATION. NO RIGHTS OF REPRODUCTION ARE IMPLIED. ALL DIMENSIONS ARE SUBJECT TO NORMAL MANUFACTURING VARIATIONS.</div>		<div>DATE</div> <div>10/23/13</div>
<div>MATERIAL SPECIFICATIONS:</div>		<div>SINE Systems Corporation</div> <div>A Subsidiary of Amphenol Corporation</div> <div>44724 Morley Drive</div> <div>Clinton Township, MI 48036</div>		
<div>PROCESS SPECIFICATIONS:</div>		<div>PLUG, 4 SOCKET, ATP SERIES,</div> <div>REDUCED DIAMETER SEAL</div>		
<div>NEXT ASSY:</div>		<div>SIZE</div> <div>B</div>	<div>FSCM NO.</div> <div>—</div>	<div>DWG NO:</div> <div>C- ATP06-4S-RD01XX</div>
		<div>SCALE:</div> <div>NONE</div>		<div>REVISION</div> <div>A3</div>
		<div>SHEET</div> <div>1</div> <div>OF</div> <div>1</div>		

TITLE: PLUG, 4 SOCKET, ATP SERIES, REDUCED DIAMETER SEAL
DWG NO: C- ATP06-4S-RD01XX
REV: A3
SH: 1
OF: 1

Mouser Electronics

Authorized Distributor

Click to View Pricing, Inventory, Delivery & Lifecycle Information:

[Amphenol:](#)

[ATP06-4S-RD01](#)