

POLARIZATION OPTION A
P/N: 31372-1000

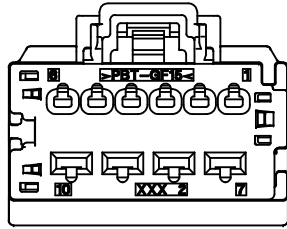

POLARIZATION OPTION B
P/N: 31372-1100

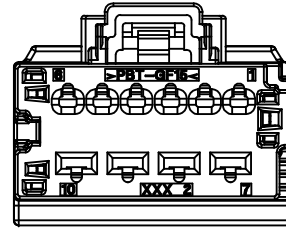

POLARIZATION OPTION C
P/N: 31372-1200

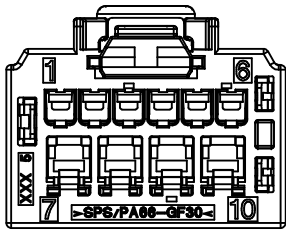

POLARIZATION OPTION A W/ CPA
P/N: 31372-1300

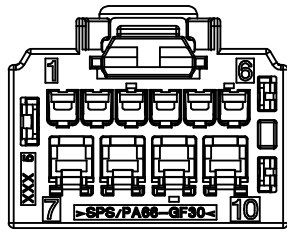

POLARIZATION OPTION B W/ CPA
P/N: 31372-1400

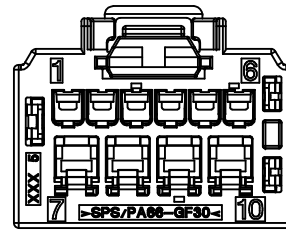

POLARIZATION OPTION C W/ CPA
P/N: 31372-1500

NOTES: VALID UNLESS OTHERWISE SPECIFIED

1. GENERAL:
 - a. APPLICATION SPECIFICATION SEE: AS-31372-100
 - b. PRODUCT SPECIFICATION SEE: PS-31372-100
 - c. PACKAGING SPECIFICATION PER MOLEX DRAWING: PK-31300-931
 - d. PARTS MUST BE IN COMPLIANCE TO MOLEX CHEMICAL SUBSTANCES FOR PRODUCTS AND PACKAGING SPECIFICATION: PS-40000-5015
 - e. DATA MUST BE SUBMITTED UNDER THE MOLEX PART NUMBER TO IMDS (COMPANY ID#13255)
2. DESIGN - MATERIALS:
 - a. SEE BOM TABLE
3. DESIGN - GEOMETRY:
 - a. THIS IS A 100% CAD GENERATED PART. THE CAD MATHEMATICAL DATA IS THE MASTER FOR THIS PART. FOR DIMENSIONAL OR ANY INFORMATION NOT SHOWN ON THIS DRAWING, ANALYZE THE CAD MODEL.
 - b. GEOMETRIC DIMENSIONS AND TOLERANCES PER ASME Y14.5M - 1994
 - c. EDGES AND UNDIMENSIONED DETAILS PER ISO13715
 - d. CORNERS SHOWN AS SHARP TO BE R 0.2 MAX.
 - e. LETTERING SHALL BE 0.15 MAX RAISED IN 0.25 MAX RECESS PAD. THIS INCLUDES RECYCLING CODE, CAVITY ID, VENDOR IDENTIFICATION, AND CUSTOMER MATERIAL NUMBER.
 - f. VISUAL DEFECTS SHALL MEET COSMETIC STANDARD PS-45499-002 (Class B)
4. DESIGN - MANUFACTURING:
 - a. TPAs MAY BECOME SEATED DURING TRANSIT. IF THIS OCCURS, REFERENCE MOLEX PRODUCT SPECIFICATION PS-34646-001

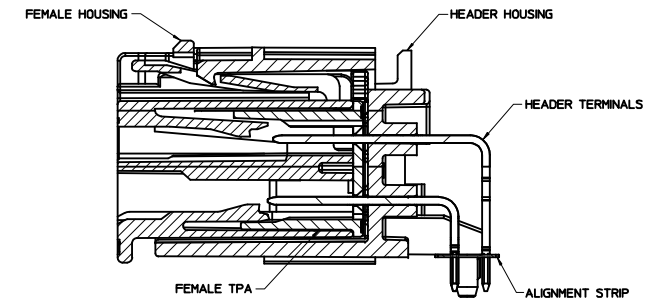

ASSEMBLY SECTION



ISOMETRIC VIEWS
SCALE 1:1
(POLARITY A SHOWN)

FIX TERMINAL TABLE DEC NO: UAU2015-0271 DRAWN: FISCHER01 2014/08/13 CHKD: APPR: RBALMAN 2014/08/19 REV:	QUALITY SYMBOLS	GENERAL TOLERANCES (UNLESS SPECIFIED)		DIMENSION STYLE	SCALE	DESIGN UNITS	THIRD ANGLE PROJECTION
	▽=0 ▽=0	mm	INCH	MM ONLY	4:1	METRIC	
		4 PLACES ±	+		DRAWN BY	DATE	TITLE
		3 PLACES ±	+		SKAROLEW	04/07/2003	10 CIRCUIT HYBRID RECEPTACLE ASSEMBLY
	2 PLACES ±	0.13	+	CHECKED BY	DATE		
	1 PLACE ±	0.25	+	MDANIELS	04/07/2003		
		ANGULAR ± 1°		APPROVED BY	DATE		
		DRAFT WHERE APPLICABLE MUST REMAIN WITHIN DIMENSIONS		BBWILSON	04/08/2003		
				MATERIAL NO.	DOCUMENT NO.		
				SEE CHART			
				MOLEX INCORPORATED			
				SD-31372-900			
				SHEET NO.			
				1 OF 3			

MOLEX ASSEMBLY PART NO.'S	MATING COMPONENT		TOOLED
	VERTICAL HEADER	RIGHT ANGLE HEADER	
31372-1000	34695-0100	34696-0100	YES
31372-1100	34695-0101	34696-0101	YES
31372-1200	34695-0102	34696-0102	YES
31372-1300	34695-0100	34696-0100	NO
31372-1400	34695-0101	34696-0101	NO
31372-1500	34695-0102	34696-0102	NO

I T E M	DESCRIPTION	COLOR	MOLEX COMPONENTS PART NO.	MATERIAL /SPEC.NO	RECYCLING CODE	WEIGHT	NO OF ITEMS REQUIRED				
1	FEMALE HOUSING POL A	BLACK	31372-2000	89992-1440	SPS/PA66-GF30	6.74g	1				
2	FEMALE HOUSING POL B	GRAY	31372-2100	89992-1451	SPS/PA66-GF30	6.73g		1			
3	FEMALE HOUSING POL C	BROWN	31372-2200	89992-1462	SPS/PA66-GF30	6.74g			1		
1	FEMALE CPA HOUSING POL A	BLACK	31372-2300	89992-1440	SPS/PA66-GF30	6.74g				1	
2	FEMALE CPA HOUSING POL B	GRAY	31372-2400	89992-1451	SPS/PA66-GF30	6.73g					1
3	FEMALE CPA HOUSING POL C	BROWN	31372-2500	89992-1462	SPS/PA66-GF30	6.74g					1
7	TPA	NATURAL	31372-3000	89992-0925	PBT-GF15	1.39g	1	1	1	1	1
8	CPA	NATURAL	31372-4000	89992-1912	PA66-GF50	1.39g				1	1

I T E M	APPLICABLE COMPONENTS		APPLICABLE WIRE SIZE		
	DESCRIPTION	TYPE	SUPPLIER COMPONENTS PART NO.	WIRE GAGE	MAXIMUM INSULATION DIAMETER
1	MOLEX MX150 TERMINAL	Sn	33012-2001	14/16 AWG	2.70mm
2		Sn	33012-2002	18/20 AWG	2.54mm
3		Sn	33012-2003	22 AWG	1.70mm
4		Sn	33012-3001	14/16 AWG	2.70mm
5		Sn	33012-3002	18/20 AWG	2.54mm
6		Sn	33012-3003	22 AWG	1.70mm
7	TYCO 2.8 TERMINAL	Sn	1326030-4	10/12 AWG	4.04mm
8		Sn	1326030-3	14/16 AWG	2.69mm
9		Sn	1326030-2	18/20 AWG	2.06mm
10		Sn	1326030-1	22 AWG	1.65mm
8	YAZAKI 2.8 TERMINAL	Sn	7116-4112-02	14 AWG	2.69mm
9		Sn	7116-4111-02	16/18 AWG	2.34mm
10		Sn	7116-4110-02	20/22 AWG	1.85mm

ENTER DESCRIPTION ELEC NO. UAU2015-0271 DRAWN BY FISCHER01 2014/08/13 CHKD: APPR:RBALMAN 2014/08/19 REV:	QUALITY SYMBOLS	GENERAL TOLERANCES (UNLESS SPECIFIED)	DIMENSION STYLE	SCALE	DESIGN UNITS	THIRD ANGLE PROJECTION
	▽=0	4 PLACES ± mm	MM ONLY	4:1	METRIC	☉
	▽=0	3 PLACES ± 0.13				
	▽=0	2 PLACES ± 0.25				
		ANGULAR ± 1 °	DRAWN BY	DATE	TITLE	
		DRAFT WHERE APPLICABLE MUST REMAIN WITHIN DIMENSIONS	SKAROLEW	04/07/2003	10 CIRCUIT HYBRID RECEPTACLE ASSEMBLY	
			CHECKED BY	DATE		
			MDANIELS	04/07/2003		
			APPROVED BY	DATE		
			BBWILSON	04/08/2003		
			MATERIAL NO.	DOCUMENT NO.		
			999999999	SD-31372-900		
			SIZE	SHEET NO.		
			D	2 OF 3		
				THIS DRAWING CONTAINS INFORMATION THAT IS PROPRIETARY TO MOLEX INCORPORATED AND SHOULD NOT BE USED WITHOUT WRITTEN PERMISSION		

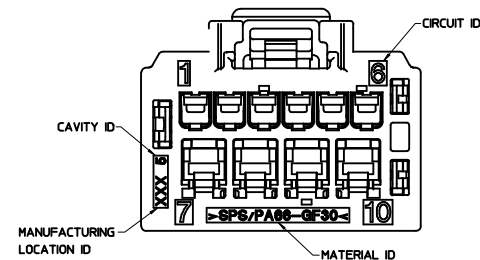
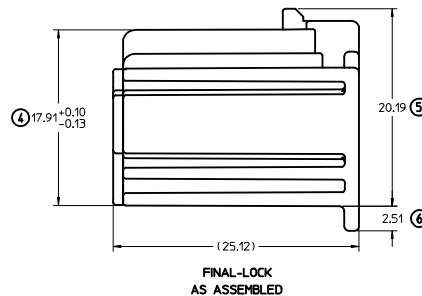
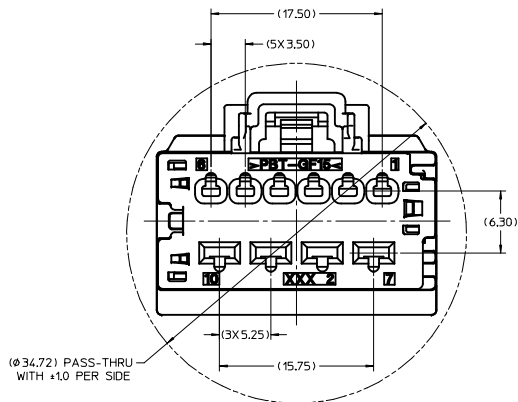
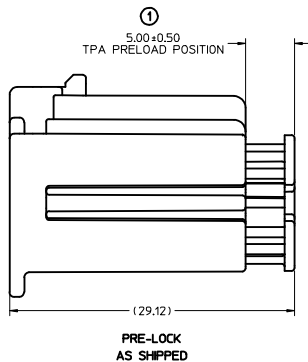
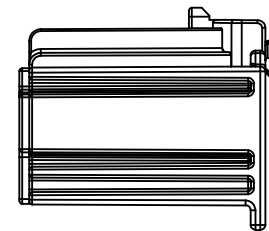
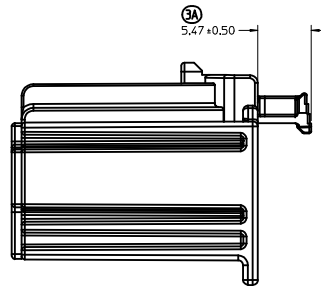
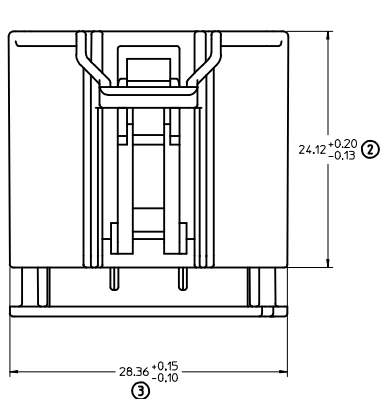

CAPACITY TOOLING EC NO. UAU2015-0271 DRAWN/FISCHER01 2014/08/13 CHKD: APPR:RBALMAN 2014/08/19	QUALITY SYMBOLS ▽=0 ▽=0	GENERAL TOLERANCES (UNLESS SPECIFIED)		DIMENSION STYLE MM ONLY	SCALE 4:1	DESIGN UNITS METRIC	THIRD ANGLE PROJECTION
		4 PLACES \pm mm \pm INCH 3 PLACES \pm --- \pm --- 2 PLACES ± 0.13 \pm --- 1 PLACE ± 0.25 \pm --- ANGULAR $\pm 1^\circ$	DRAWN BY SKAROLEW 04/07/2003 CHECKED BY MDANIELS 04/07/2003 APPROVED BY BBWILSON 04/08/2003	DATE DATE DATE	TITLE 10 CIRCUIT HYBRID RECEPTACLE ASSEMBLY		
	DRAFT WHERE APPLICABLE MUST REMAIN WITHIN DIMENSIONS	SEE CHART		MATERIAL NO. DOCUMENT NO.	MOLEX INCORPORATED SD-31372-900		
		SHEET NO. 3 OF 3		THIS DRAWING CONTAINS INFORMATION THAT IS PROPRIETARY TO MOLEX INCORPORATED AND SHOULD NOT BE USED WITHOUT WRITTEN PERMISSION			