

**Dimensions (In.)**

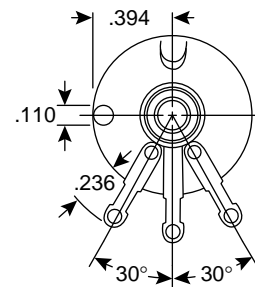
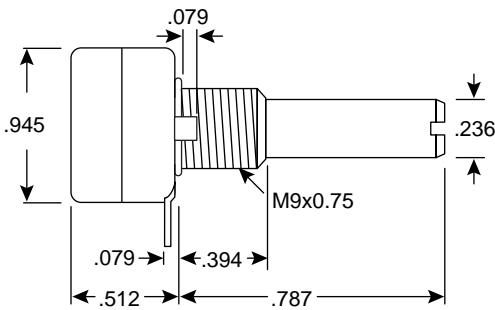

Mouser Stock No.	Value (Ω)
31YN205	500
31YN301	1K
31YN305	5K
31YN401	10K
31YN405	50K
31YN501	100K

**Specifications:**

- Taper: linear
- Wattage rating: <math><1K=.4W, 1K\sim<10K=.3W, \leq 10K=.25W</math>
- Maxium voltage: 350V
- Rotational angle: 300°
- Rotational torque: 50~300gf-cm
- Rotational life: 15,000 cycles