

ASSEMBLY NUMBER	FINISH
73656-0000	SEE NOTE 2.
73656-0001	SEE NOTE 3.

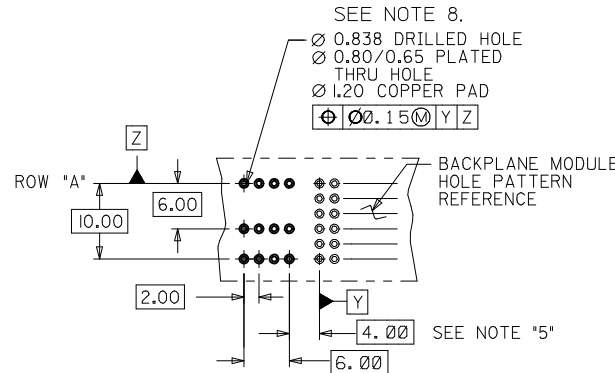
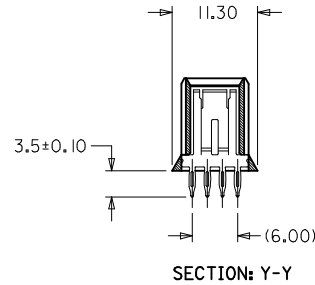
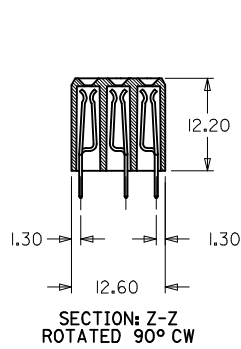
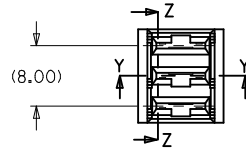
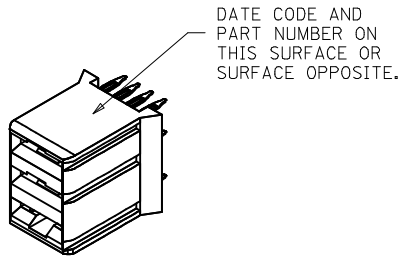

PCB LAYOUT: COMPONENT SIDE
RECOMMENDED PCB THICKNESS: 2.50 MIN

NOTES:

1. MATERIALS: HOUSING - LIQUID CRYSTAL POLYMER (LCP), GLASS-FILLED, UL94V-0, COLOR: BLACK
TERMINAL - COPPER ALLOY
2. FINISH: SELECTIVE GOLD (Au) IN CONTACT AREA, 0.76 micrometer MINIMUM THICKNESS: NICKEL (Ni) AND GOLD FLASH OVERALL
3. FINISH: SELECTIVE GOLD (Au) IN CONTACT AREA, 0.76 micrometer MINIMUM THICKNESS: MATTE TIN (Sn) OVER NICKEL (Ni) IN COMPLIANT AREA: NICKEL (Ni) OVERALL ON REMAINING WITH SELECTIVE GOLD (Au) FLASH.
4. THIS DIMENSION MUST BE A MULTIPLE OF 4.00 mm.
5. DIMENSIONS ARE IN MILLIMETERS.
6. THIS PART CONFORMS TO MOLEX PRODUCT SPECIFICATION PS-73670-9999.
7. PACKAGE ASSEMBLIES PER PK-70873-0819.
8. HOLE SIZE SPECIFICATION IS FOR TIN/LEAD PLATED HOLES ONLY. FOR OTHER PLATING TYPES SEE MOLEX APPLICATION AS-73670-9996.
9. THIS PART CONFORMS TO MOLEX COSMETIC SPECIFICATION PS-45499-002 CLASS B.

REV	DESCRIPTION	QUALITY SYMBOLS	GENERAL TOLERANCES (UNLESS SPECIFIED)		DIMENSION STYLE		SCALE	DESIGN UNITS	THIRD ANGLE PROJECTION		
			mm	INCH	MM ONLY		1:1	METRIC			
LEAD FREE CONVERSION	EC NO: UCP2013-3253	DRW:RWHP/PPLE 2013/02/04	4 PLACES	± ---	± ---	DRAWN BY	DATE	SALES ASSY, HDM BACKPLANE POWER MODULE (PRESSFIT) molex DOCUMENT NO. SDA-73656-*00* SHEET NO. 1 OF 4			
	CHKD:MMOLFE 2013/02/04	3 PLACES	± ---	± ---	CHECKED BY	DATE					
	APPR:SMILLER 2013/08/05	2 PLACES	± 0.13	± ---	SMR	1998/05/21					
		1 PLACE	± 0.25	± ---	APPROVED BY	DATE					
		0 PLACE	± ---	± ---	CAB	1998/05/21					
			ANGULAR ±1/2°		MATERIAL NO.						
			DRAFT WHERE APPLICABLE MUST REMAIN WITHIN DIMENSIONS		SEE TABLE						
					SIZE C		THIS DRAWING CONTAINS INFORMATION THAT IS PROPRIETARY TO MOLEX INCORPORATED AND SHOULD NOT BE USED WITHOUT WRITTEN PERMISSION				

10 9 8 7 6 5 4 3 2 1

DATE CODE AND
PART NUMBER ON
THIS SURFACE OR
SURFACE OPPOSITE.

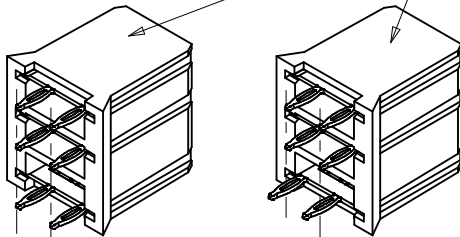

73656-100*

73656-200*

MIDPLANE OPTION

ASSEMBLY NUMBER	FINISH (SEE SHT 1)
73656-1000	SEE NOTE 2. (GOLD TAILS)
73656-2000	
73656-1001	SEE NOTE 3. *(MATTE TIN TAILS)
73656-2001	

* FORMERLY TIN/LEAD

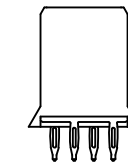
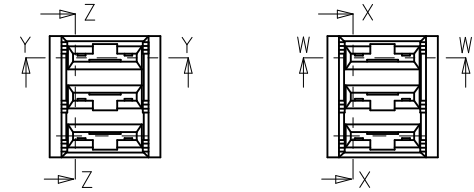

73656-200*

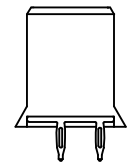

73656-100*

USE BACKPLANE MODULE
HOLE REFERENCE PATTERN
FROM SHEET 1

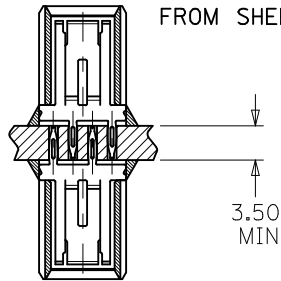

BACK-TO-BACK
MOUNTING APPLICATION

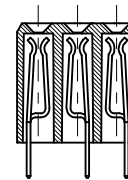

SECTION X-X
SECTION Z-Z
ROTATED 90° CW

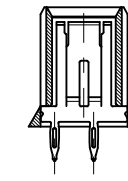

(4.00)
SECTION: Y-Y

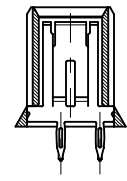

(4.00)
SECTION: W-W

SEE SHEET 1	EC NO: UCP2013-3253	QUALITY SYMBOLS	GENERAL TOLERANCES (UNLESS SPECIFIED)	DIMENSION STYLE MM ONLY		SCALE 1:1	DESIGN UNITS METRIC	THIRD ANGLE PROJECTION	
	DRWN:RWHIPPLE 2013/02/04	▽=0		mm	INCH	DRAWN BY ELO	DATE 1998/05/21	TITLE SALES ASSY , HDM BACKPLANE POWER MODULE (PRESSFIT)	
	CHKD:MMOLFE 2013/02/04	▽=0	4 PLACES ± --- ± ---			CHECKED BY SMR	DATE 1998/05/21		
	APPR:SMILLER 2013/08/05	▽=0	3 PLACES ± --- ± ---			APPROVED BY CAB	DATE 1998/05/21	DOCUMENT NO. SDA-73656-*00*	
REV		2 PLACES ± 0.13 ± ---			MATERIAL NO.		SHEET NO. 2 OF 4		
		1 PLACE ± 0.25 ± ---			SIZE B	THIS DRAWING CONTAINS INFORMATION THAT IS PROPRIETARY TO MOLEX INCORPORATED AND SHOULD NOT BE USED WITHOUT WRITTEN PERMISSION			
		0 PLACE ± --- ± ---							

9 8 7 6 5 4 3 2 1

10	9	8	7	6	5	4	3	2	1
ASSEMBLY NUMBER		FINISH (SHT 1)							
73656-5000		SEE NOTE 2.							
73656-5001		SEE NOTE 3.							

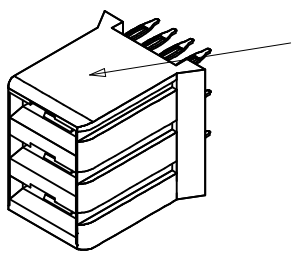

DATE CODE AND PART NUMBER ON THIS SURFACE OR SURFACE OPPOSITE.

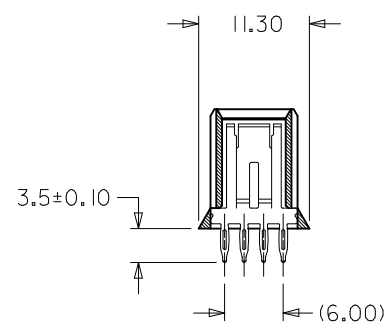
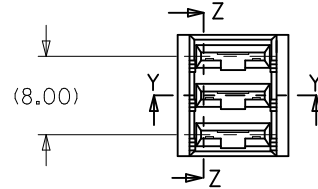

SECTION: Y-Y

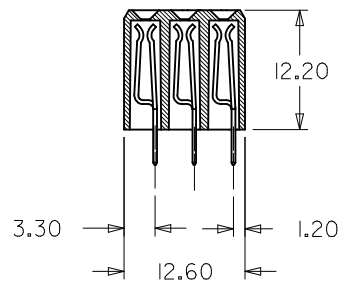

SECTION: Z-Z ROTATED 90° CW

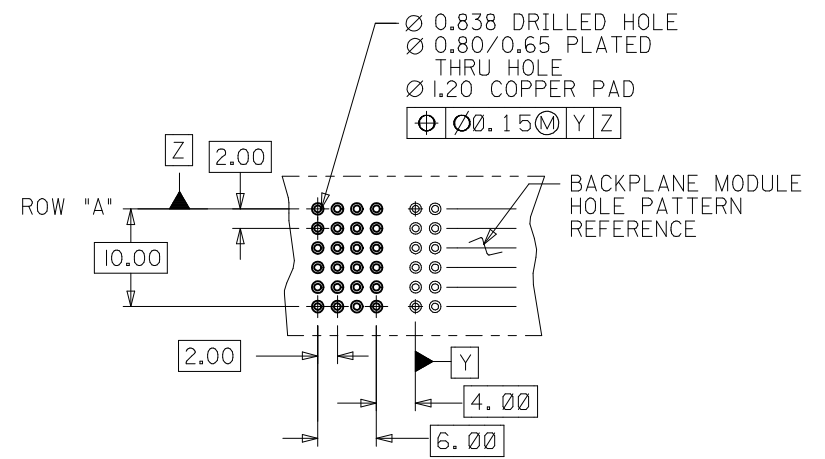
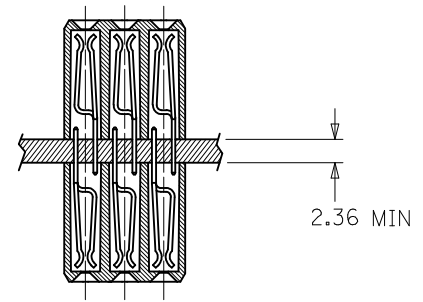

SEE SHEET 1 EC NO: UCP2013-3253 DRW:RWHIPPLE 2013/02/04 CHKD:MWOLFE 2013/02/04 APPR:SMILLER 2013/08/05	QUALITY SYMBOLS	GENERAL TOLERANCES (UNLESS SPECIFIED)	DIMENSION STYLE	SCALE	DESIGN UNITS	THIRD ANGLE PROJECTION																		
	$\nabla = 0$ $\nabla = 0$ $\nabla = 0$	<table border="1"> <tr> <th></th> <th>mm</th> <th>INCH</th> </tr> <tr> <td>4 PLACES</td> <td>± ---</td> <td>± ---</td> </tr> <tr> <td>3 PLACES</td> <td>± ---</td> <td>± ---</td> </tr> <tr> <td>2 PLACES</td> <td>± 0.13</td> <td>± ---</td> </tr> <tr> <td>1 PLACE</td> <td>± 0.25</td> <td>± ---</td> </tr> <tr> <td>0 PLACE</td> <td>± ---</td> <td>± ---</td> </tr> </table>		mm	INCH	4 PLACES	± ---	± ---	3 PLACES	± ---	± ---	2 PLACES	± 0.13	± ---	1 PLACE	± 0.25	± ---	0 PLACE	± ---	± ---	MM ONLY	1:1	METRIC	
		mm	INCH																					
	4 PLACES	± ---	± ---																					
3 PLACES	± ---	± ---																						
2 PLACES	± 0.13	± ---																						
1 PLACE	± 0.25	± ---																						
0 PLACE	± ---	± ---																						
DRAWN BY: ELO CHECKED BY: SMR APPROVED BY: CAB DATE: 1998/05/21	MATERIAL NO. SEE TABLE SIZE: B	TITLE SALES ASSY, HDM BACKPLANE POWER MODULE (PRESSFIT)	DOCUMENT NO. SDA-73656-*00*	SHEET NO. 3 OF 4																				
ANGULAR ±1/2° DRAFT WHERE APPLICABLE MUST REMAIN WITHIN DIMENSIONS						THIS DRAWING CONTAINS INFORMATION THAT IS PROPRIETARY TO MOLEX INCORPORATED AND SHOULD NOT BE USED WITHOUT WRITTEN PERMISSION																		

10	9	8	7	6	5	4	3	2	1
ASSEMBLY NUMBER		FINISH							
73656-0180		SEE NOTE 2.							
73656-0181		SEE NOTE 3.							

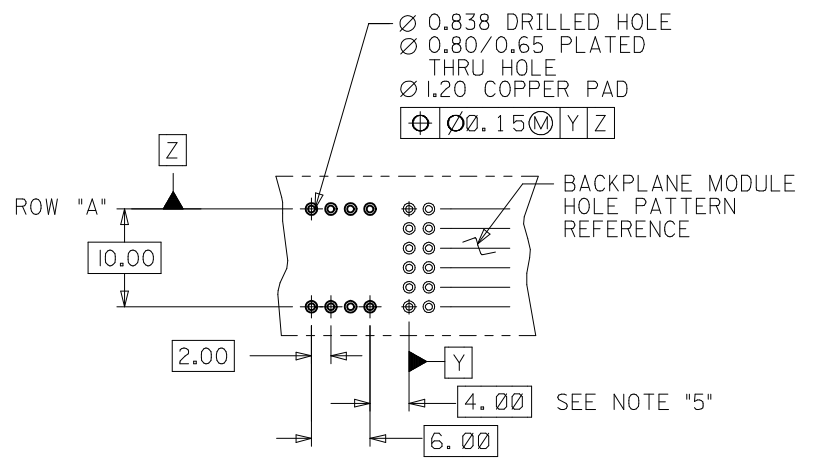
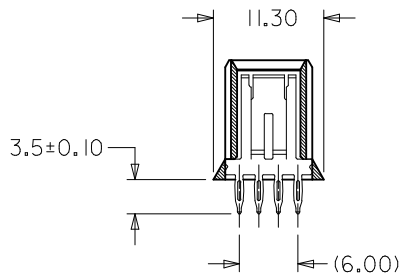
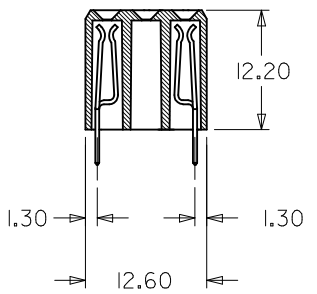
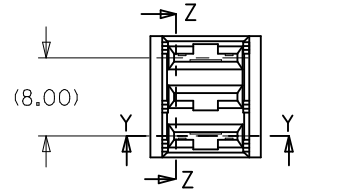
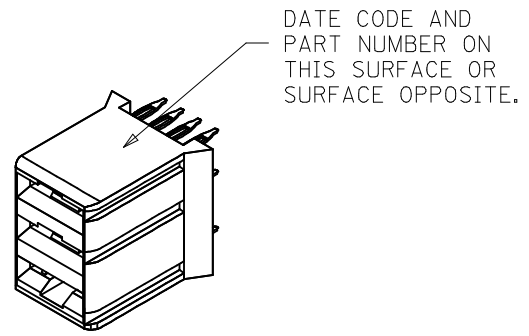

SEE SHEET 1 EC NO: UCP2013-3253 DRWN:RWH/PPLE 2013/02/04 CHKD:MM/LFE 2013/02/04 APPR:SMILLER 2013/08/05	QUALITY SYMBOLS	GENERAL TOLERANCES (UNLESS SPECIFIED)	DIMENSION STYLE	SCALE	DESIGN UNITS	THIRD ANGLE PROJECTION
	▽=0	mm INCH	MM ONLY	1:1	METRIC	
	▽=0	4 PLACES ± --- ± ---	DRAWN BY DATE	TITLE		
	▽=0	3 PLACES ± --- ± ---	ELO 1998/05/21	SALES ASSY, HDM BACKPLANE POWER MODULE (PRESSFIT)		
	2 PLACES ± 0.13 ± ---	CHECKED BY DATE	DOCUMENT NO.			
	1 PLACE ± 0.25 ± ---	SMR 1998/05/21	SDA-73656-*00*			
	0 PLACE ± --- ± ---	APPROVED BY DATE	SHEET NO.			
		CAB 1998/05/21	4 OF 4			
		MATERIAL NO.	THIS DRAWING CONTAINS INFORMATION THAT IS PROPRIETARY TO MOLEX INCORPORATED AND SHOULD NOT BE USED WITHOUT WRITTEN PERMISSION			
		SEE TABLE				
		ANGULAR ± 1/2°				
		DRAFT WHERE APPLICABLE				
		MUST REMAIN WITHIN DIMENSIONS				

DATE CODE AND PART NUMBER ON THIS SURFACE OR SURFACE OPPOSITE.

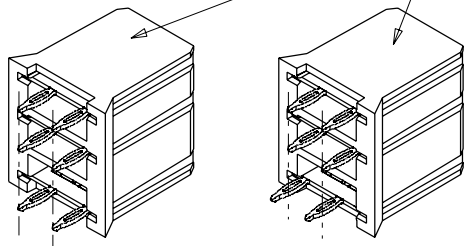

73656-100*

73656-200*

MIDPLANE OPTION

ASSEMBLY NUMBER	FINISH (SEE SHT 1)
73656-1000	SEE NOTE 2. (GOLD TAILS)
73656-2000	
73656-1001	SEE NOTE 3. (TIN/LEAD TAILS)
73656-2001	

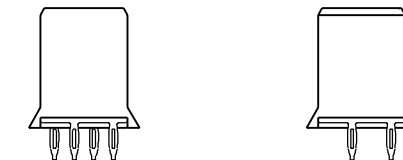
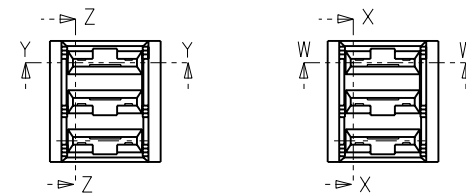

73656-200*

73656-100*

USE BACKPLANE MODULE HOLE REFERENCE PATTERN FROM SHEET 1

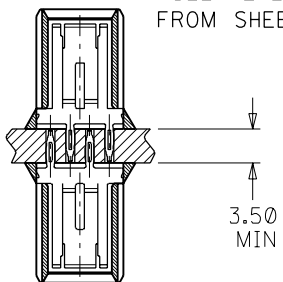

BACK-TO-BACK MOUNTING APPLICATION

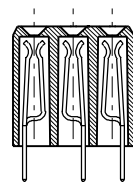

SECTION X-X
SECTION Z-Z
ROTATED 90° CW

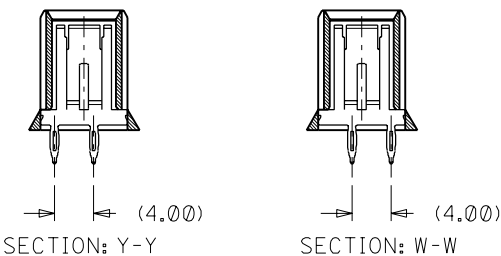

SECTION: Y-Y (4.00)

SECTION: W-W (4.00)

F
E
D
C
B
A

F
E
D
C
B
A

LTR.	REVISIONS	LTR.	REVISIONS
		D	SEE SHEET 1
		B	SEE SHEET 1
		A	SEE SHEET 1

DIMENSIONS SHOWN (METRIC) INCH	
UNLESS OTHERWISE SPECIFIED TOLERANCES: ANGULAR = 1/2°	
3 PLACE	± N/A ---
2 PLACE	± N/A ±---
1 PLACE	--- ±---

DRAFT WHERE APPLICABLE MUST REMAIN WITHIN DIMENSIONS

DRWG. BY: ELO	CHK'D. BY: SMR
APP'D. BY: CAB	SCALE: 2 : 1

REVISE ONLY ON CAD SYSTEM	
TITLE: SALES ASSY, HDM BACKPLANE POWER MODULE (PRESS FIT)	
MOLEX INCORPORATED LISLE, ILL. 60532	SHEET NO. 2 DATE 98/05/21
PART NO. S73656X2 DGN	DRWG. NO. SDA-73656-*00*
FILE NAME: S73656X2 DGN	THIS DRAWING CONTAINS INFORMATION THAT IS PROPRIETARY TO MOLEX INC. AND SHOULD NOT BE USED WITHOUT WRITTEN PERMISSION.
DIV. DA	SIZE B