

Features

- ❑ The faston blade was chosen acc. to DIN 46 330 - A 2.8
- ❑ Each type is delivered with a termination element consisting of a nut, a seal and a splice ring
- ❑ Splice ring with Pg 9
- ❑ For assembly in openings without threads a Pg 9 locknut is available
- ❑ Diameter of the mounting cutout: d = 15.5 mm

Technical characteristics

Working voltage	32 V
Working current (see current carrying capacity)	4 A
Wire gauge	0.25 - 0.5 mm ² 24/7 AWG - 22 AWG
Diameter of individual strands	≥ 0.1 mm
Conductor insulation material	PVC
Conductor diameter	1.2 - 1.6 mm
Cable diameter	4.0 - 5.1 mm
Working temperature	- 25 °C ... + 85 °C
Temperature during connection	- 5 °C ... + 50 °C
Degree of protection	IP 67
Number of terminations with same cable cross section	10

Assembly manual

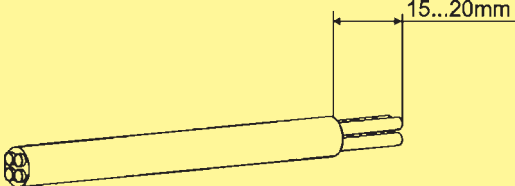
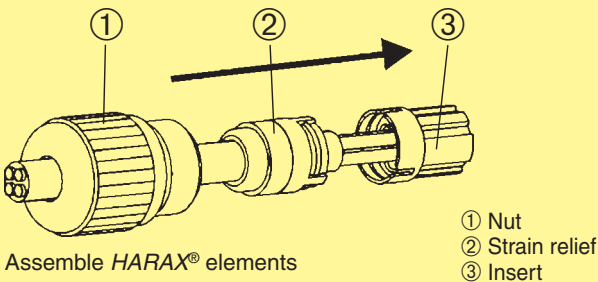
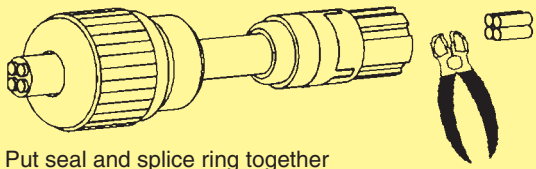
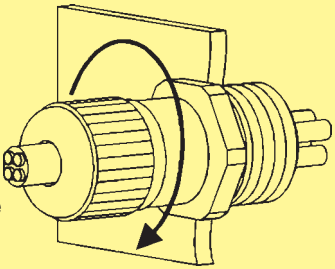
1. 
Strip cable jacket
2. 
Assemble HARAX[®] elements
① Nut
② Strain relief
③ Insert
3. 
Put seal and splice ring together
Cut off cable ends
4. 
Twist the nut onto the insert until a stop is noticeable

Current carrying capacity

The current carrying capacity is limited by maximum temperature of materials for inserts and contacts including terminals. The current capacity-curve is valid for continuous, not interrupted current-loaded contacts of connectors when simultaneous power on all contacts is given, without exceeding the maximum temperature.

Control and test procedures according to DIN IEC 60 512-3.

Pg 9, 3 contacts

1 = wire gauge
3 x 0.25 mm²

2 = wire gauge
3 x 0.5 mm²

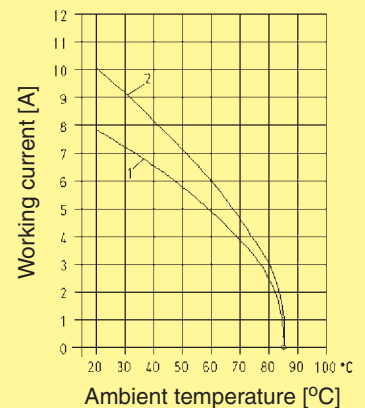

Pg 9, 4 contacts

1 = wire gauge
4 x 0.25 mm²

2 = wire gauge
4 x 0.5 mm²

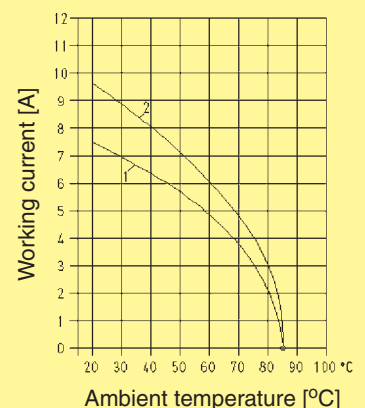

Technical characteristics

Specifications	IEC 60352-4 DIN 61984	
Approvals	VDE	
Construction type	Pg 13.5 3 contacts	Pg 13.5 / M20 4 contacts
Working voltage	250 V 4 kV 3 with faston terminals with insulation cap 600 V	230/400 V 4 kV 3
acc. to UL/CSA	600 V	
Working current (see current carrying capacity)	16 A	16 A
Testing voltage	4 kV (1.2/50)	4 kV (1.2/50)
Conductor cross section	0.75 - 1.5 mm ²	0.75 - 1.5 mm ²
Diameter of individual strands	≥ 0.2 mm	≥ 0.2 mm
Outer cable diameter	6.0 - 9.0 mm	6.0 - 9.0 mm
Termination cycles with the same cross section	10	10
Limiting temperature	- 25 / + 85 °C	- 25 / + 85 °C
Temperature during connection	- 5 ... + 50 °C	- 5 ... + 50 °C
Degree of protection	IP 67	IP 67
Insulation material	PVC	PVC
Max. tightening torque	8 Nm	8 Nm

Pg 13.5 3 contacts

- 1 = wire gauge
0.75 mm²
- 2 = wire gauge
1.5 mm²

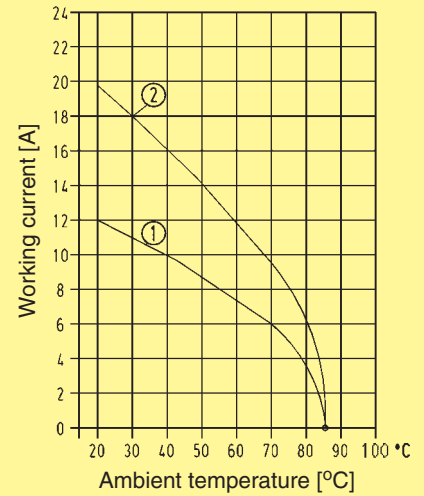

Pg 13.5 / M20 4 contacts

- 1 = wire gauge
0.75 mm²
- 2 = wire gauge
1.5 mm²

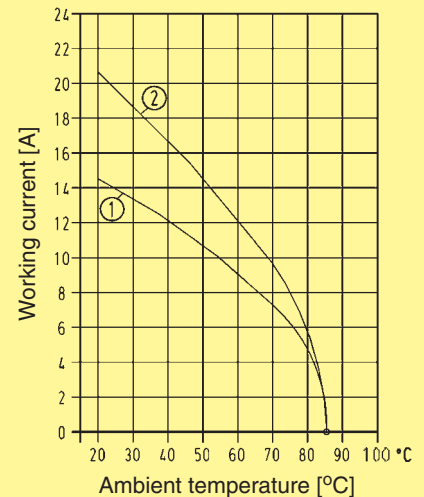

Current carrying capacity

The current carrying capacity is limited by maximum temperature of materials for inserts and contacts including terminals. The current capacity-curve is valid for continuous, not interrupted current-loaded contacts of connectors when simultaneous power on all contacts is given, without exceeding the maximum temperature.

Control and test procedures according to DIN IEC 60512-3.

Assembly manual

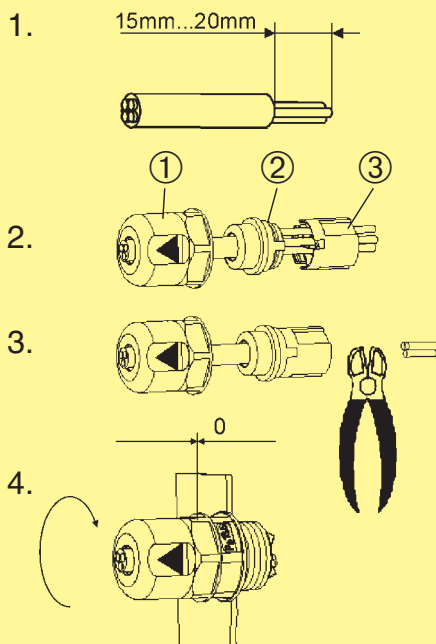

Connection and disconnection of the cable must only be performed by suitably qualified persons when supply is isolated.

- ① Nut
- ② Strain relief
- ③ Insert

HARAX® Pg 13.5 – 3 contacts – is supplied with either faston blades or solder terminals.

HARAX® Pg 13.5 / M20 – 4 contacts – is supplied only with solder termination.

The nut must be tightened completely down so that the notches engage on the contact carrier.

The opening of the gland always requires a wrench.

Note: For reconnection cut off the used cable ends and repeat steps 1 to 4.

Panel feed-through



Identification

Part number

Drawing

Dimensions in mm

HARAX® Pg 9 panel feed-through

3 contacts, with pre-assembled
0.5 m / 0.5 mm² pigtail cable



21 01 130 4241

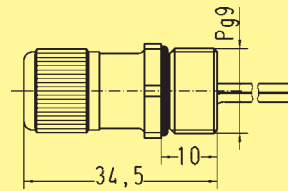

View:
Termination side

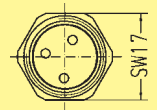

HARAX® Pg 9 panel feed-through

4 contacts, with pre-assembled
0.5 m / 0.5 mm² pigtail cable



21 01 140 4341

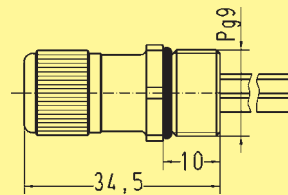

View:
Termination side

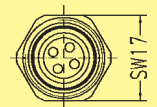

HARAX® Pg 9 panel feed-through

3 contacts
with faston blades



21 01 130 4011

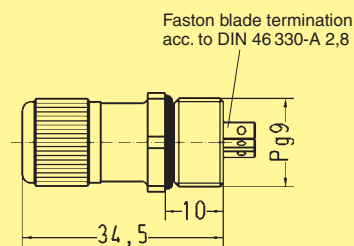

View:
Termination side

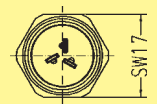

M12 panel feed-through

female, d-coded, 50 cm conductors



21 03 371 2403

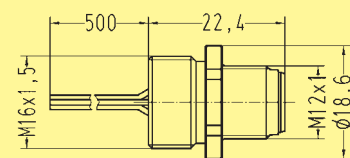

M12 panel feed-through

male, a-coded, 50 cm conductors



21 03 311 1402

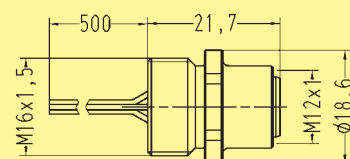

HARAX

50
15

Stock items in bold type

HARAX® Pg 13.5 / M20 panel feed-through



Rapid termination technology HARAX®

Identification	Part number	Drawing	Dimensions in mm	
HARAX® Pg 13,5 / 3 contacts with faston blades	21 01 130 1013		View: Mating side SW24	
HARAX® Pg 13,5 / 3 contacts with solder termination	21 01 130 1023			
HARAX® Pg 13,5 / 3 contacts with pre-assembled pigtail cable, l = 500 mm	21 01 130 1223			
HARAX® Pg 13,5 / 2 + PE with faston blades	21 01 130 3013		View: Mating side SW24	
HARAX® Pg 13,5 / 2 + PE with solder termination	21 01 130 3023			
HARAX® Pg 13,5 / 2 + PE with pre-assembled pigtail cable, l = 500 mm	21 01 130 3233			
HARAX® Pg 13,5 / 4 contacts with solder termination	21 01 140 1023		View: Mating side SW24	
HARAX® Pg 13,5 / 3 + PE with solder termination	21 01 140 3023			
HARAX® Pg 13,5 / 4 contacts with pre-assembled strand, l = 500 mm	21 01 140 1323			
HARAX® Pg 13,5 / 3 + PE with pre-assembled strand, l = 500 mm	21 01 140 3333			
HARAX® M20 / 4 contacts with solder termination	21 01 141 1023		View: Mating side SW24	
HARAX® M20 / 3 + PE with solder termination	21 01 141 3023			
HARAX® M20 / 4 contacts with pre-assembled strand, l = 500 mm	21 01 141 1323			
HARAX® M20 / 3 + PE with pre-assembled strand, l = 500 mm	21 01 141 3333			

HARAX

50
16

Other length on request

Stock items in bold type

Identification	Part No.	Drawing	Dimensions in mm
Seal M12	21 01 010 2001		
Seal M12-L	21 01 010 2003		
Seal M8	21 01 010 2008		for 2.5 - 3.5 mm cable Ø
	21 01 010 2004		for 3.2 - 4.4 mm cable Ø
	21 01 010 2005		for 4.2 - 5.4 mm cable Ø
Seal Pg 13.5 / M20	21 01 010 2002		
Cap M12	21 01 000 0003		
Lock nut Pg 9	21 01 000 0008		
Lock nut Pg 13.5	21 01 000 0007		
Lock nut M20	21 01 000 0009		
Socket wrench	21 01 000 0001		