

8 7 6 5 4 3 2 1

E  
D  
C  
B  
A

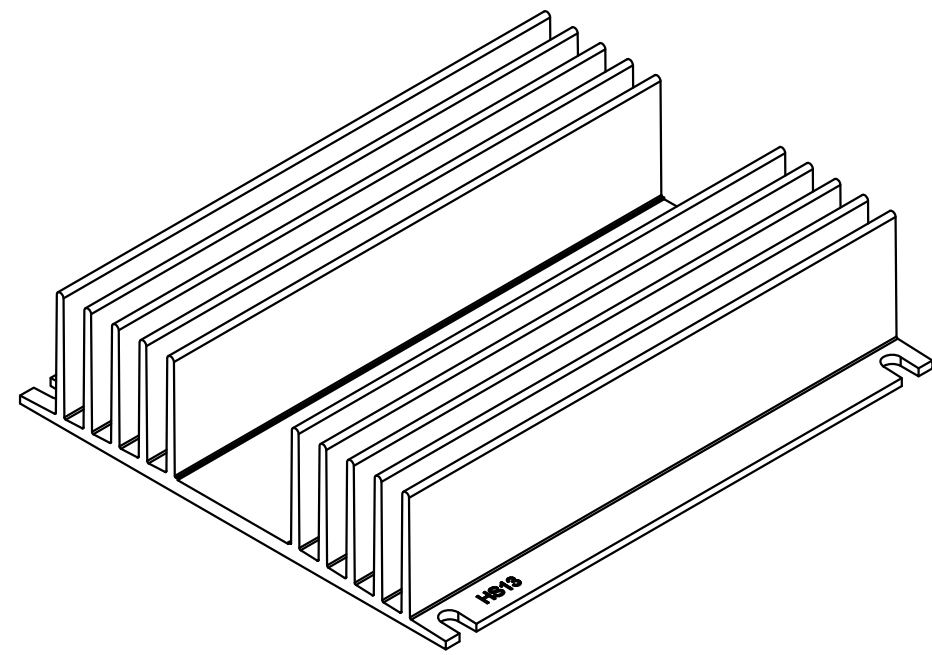

**P1 HEATSINK**  
 MAT'L: 6063-T5 ALUMINUM (AAVID EXTRUSION #60840)  
 FINISH: ANODIZE PER MIL-A-8625, TYPE II, CL 2, BLACK  
 TYPICAL BREAKDOWN VOLTAGE > 300V

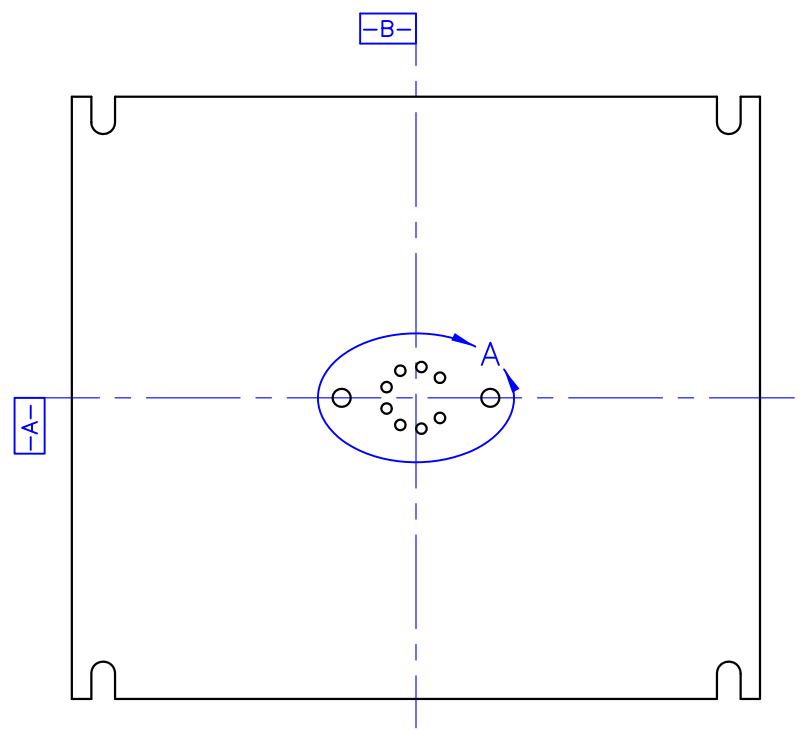
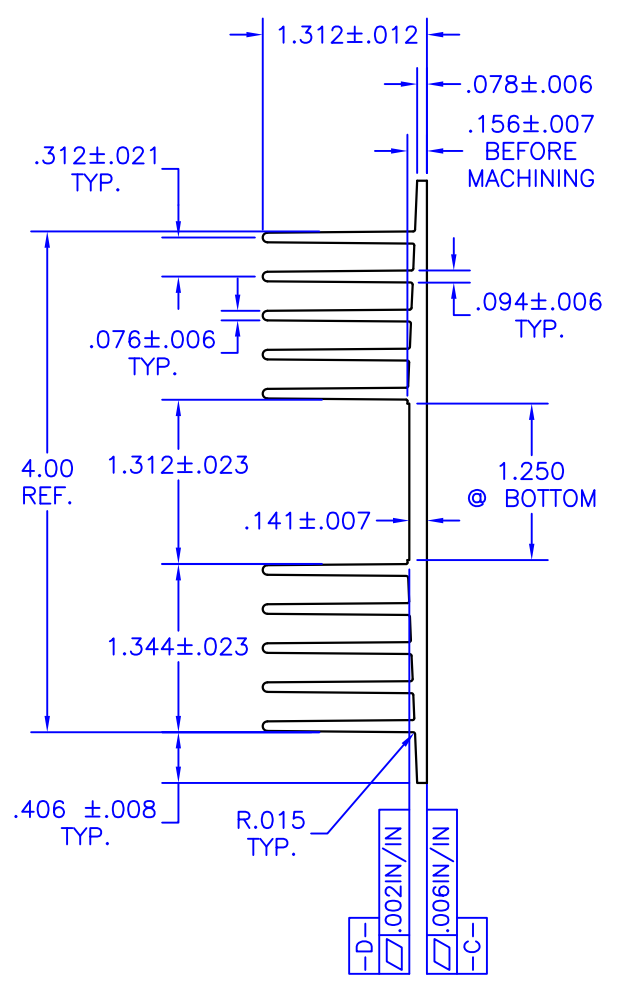
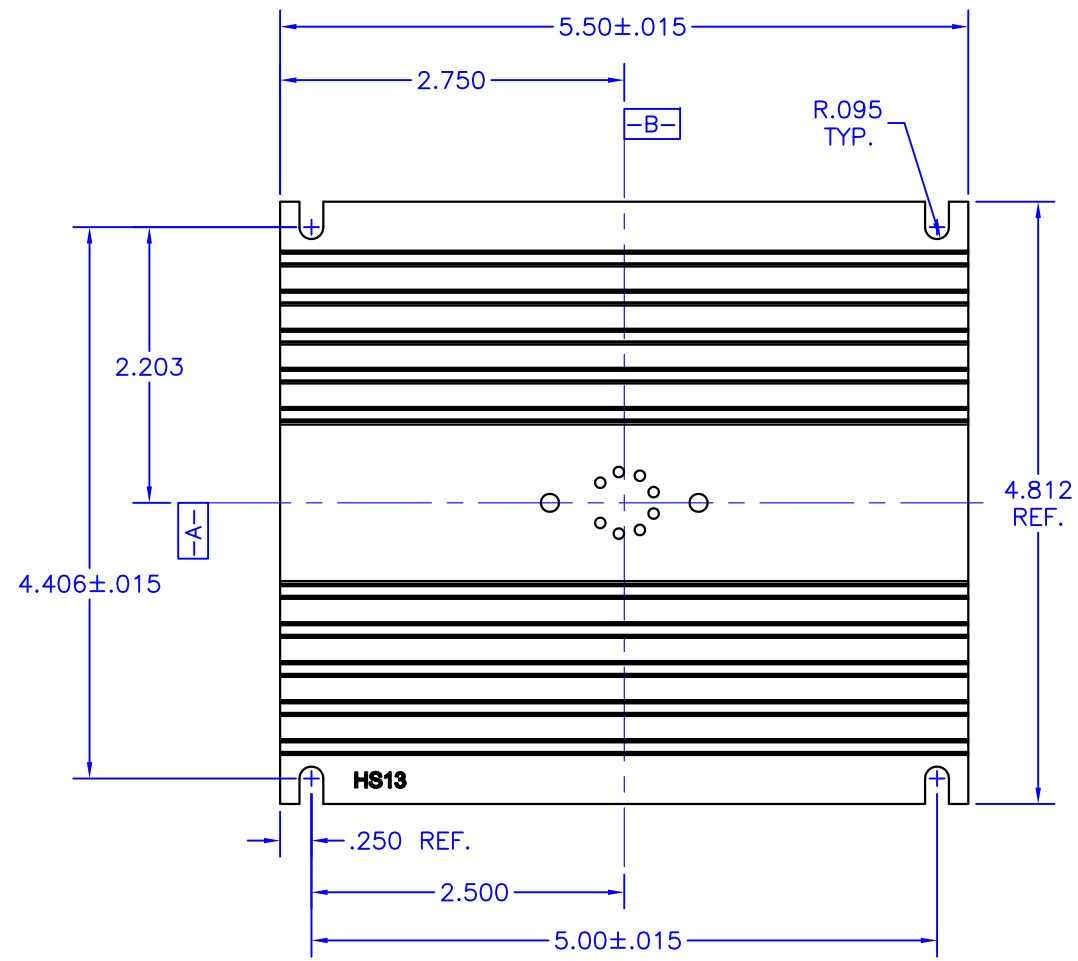
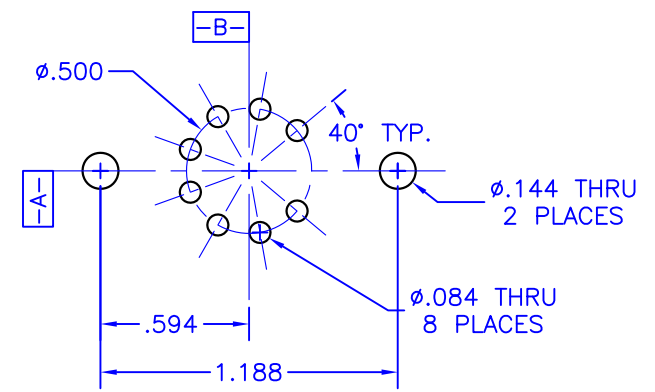

DETAIL A  
SCALE: 2X

- NOTES:**
1. UNLESS OTHERWISE NOTED, ALL DIMENSIONS ARE IN INCHES.
  2. BREAK ALL SHARP EDGES, DE-BURR & REMOVE LOOSE CHIPS.
  3. MARK WITH CONTRASTING INK AS SHOWN, IF SPECIFIED BY PURCHASE ORDER.

TOLERANCES - UNLESS OTHERWISE SPECIFIED .XX = ±.05 [.002] .XXX = ±.005 [.0002] ANG. = ±2°	 MICROTECHNOLOGY PRECISION POWER SOLUTIONS	TITLE: TO-3 HEATSINK	MODEL: HS13
		SUBJECT: MECHANICAL DRAWING	REV: H
ENGINEER: D-M	DRAWN BY: P.ECK	DCAL: 12435	SIL: 1 OF 1
FILENAME: HS13			DATE: 14NOV12

8 7 6 5 4 3 2 1