

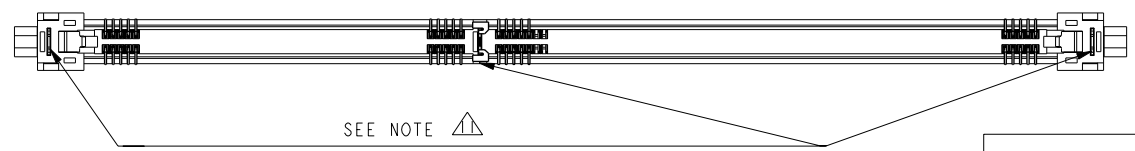

Copyright FCI.

A  
B  
C  
D

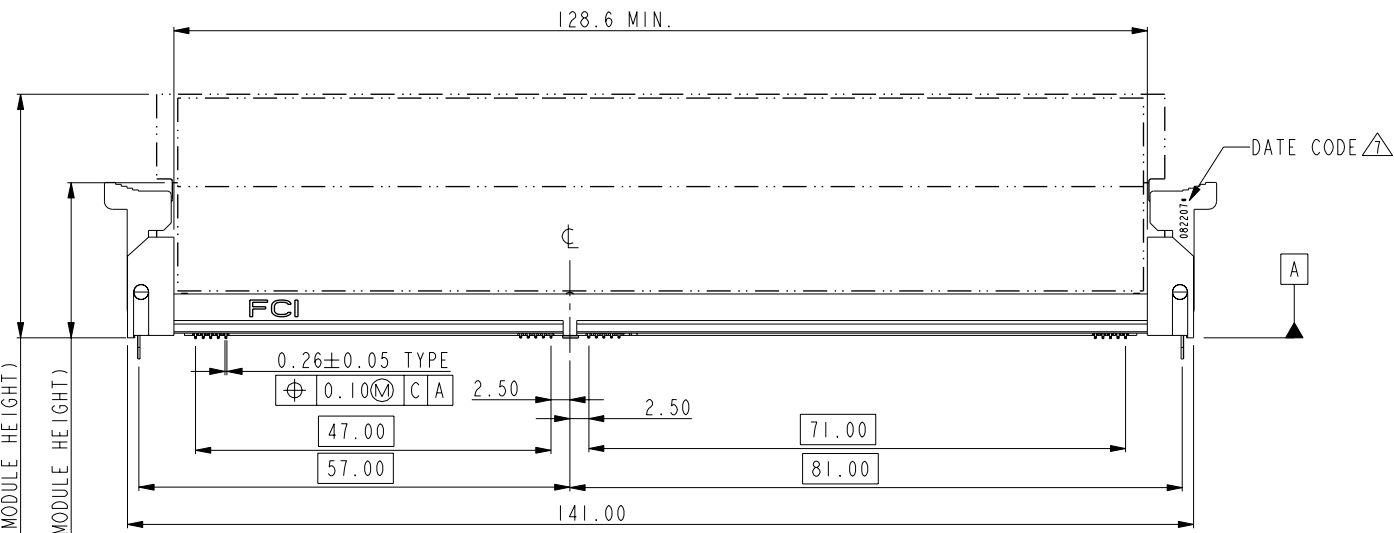
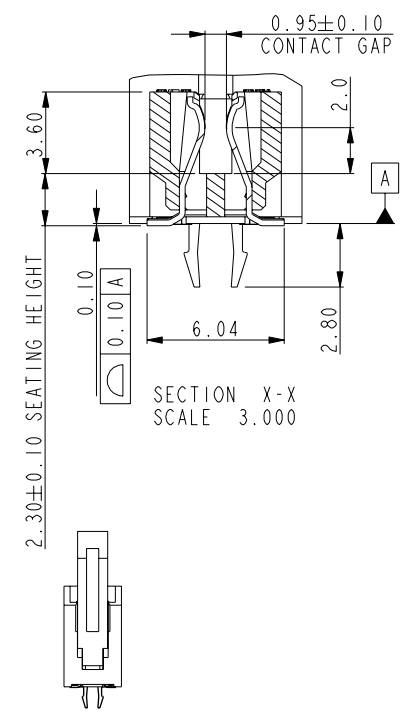
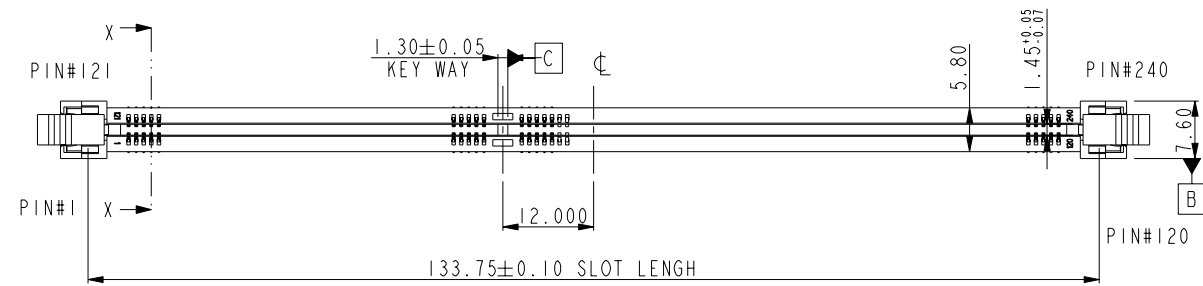

rev	ecn no	dr	date
1	PRE	BL	07/22/09
2	PRE	BL	07/22/09
A	DG09-0238	BL	07/26/09
B	DG09-0308	BL	09/18/09
C	N10-0076	R.B	02/03/2010

www.fciconnect.com		surface	<input checked="" type="checkbox"/>	tolerance std	projection	MM
		TOLERANCES UNLESS OTHERWISE SPECIFIED				
Dr	CHARLIE S	05/18/07	ANGULAR	0.X	± 0.15	size A4
Eng	CHARLIE S	05/18/07	LINEAR	0.XX	± 0.30	Scale 1.000
Chr	GARY HSIEH	05/18/07	0°	0.XXX	± 0.5	ECN N10-0076
Appr	JOSEPH HSIA	05/18/07	Product family		Spec ref	*
		title SMT DDRIII SOCKET ASS'Y (WITH LCP HOUSING)			dwg no 10104389	Rev. C
catalog no		*		CUSTOMER	sheet 1 of 4	

REV F - 2006-04-17

2

3 PDM: Rev:C

STATUS Released

4 Printed: Oct 01, 2010

A  
B  
C  
D

A

B

C

D

A

B

C

D

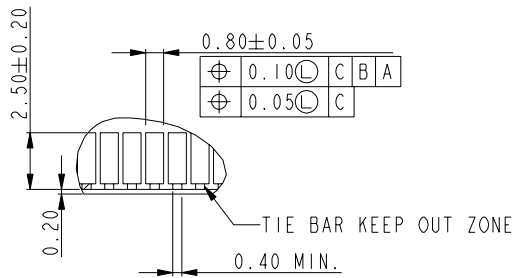
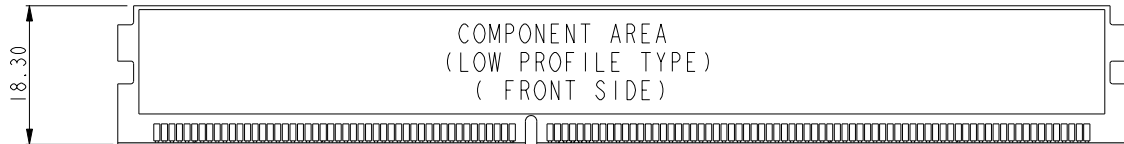
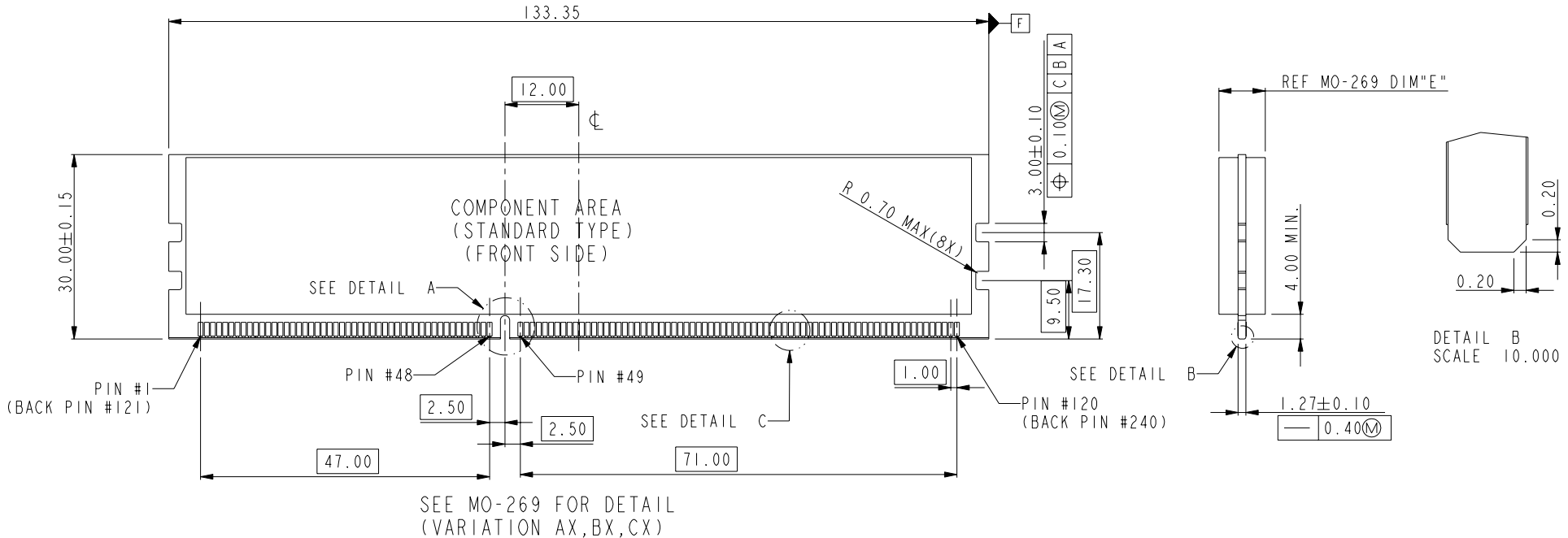

DETAIL C SCALE 3.000

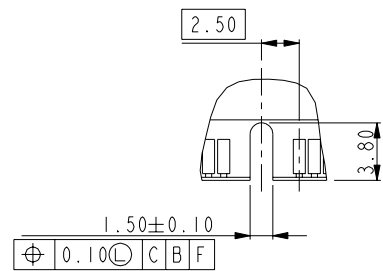

DETAIL A SCALE 2.000

	title SMT DDRIII SOCKET ASS'Y (WITH LCP HOUSING)	dwg no 10104389	Rev. C
	catalog no *	CUSTOMER	sheet 2 of 4



Copyright FCI.



Copyright FCI.

A  
B  
C  
D

A  
B  
C  
D

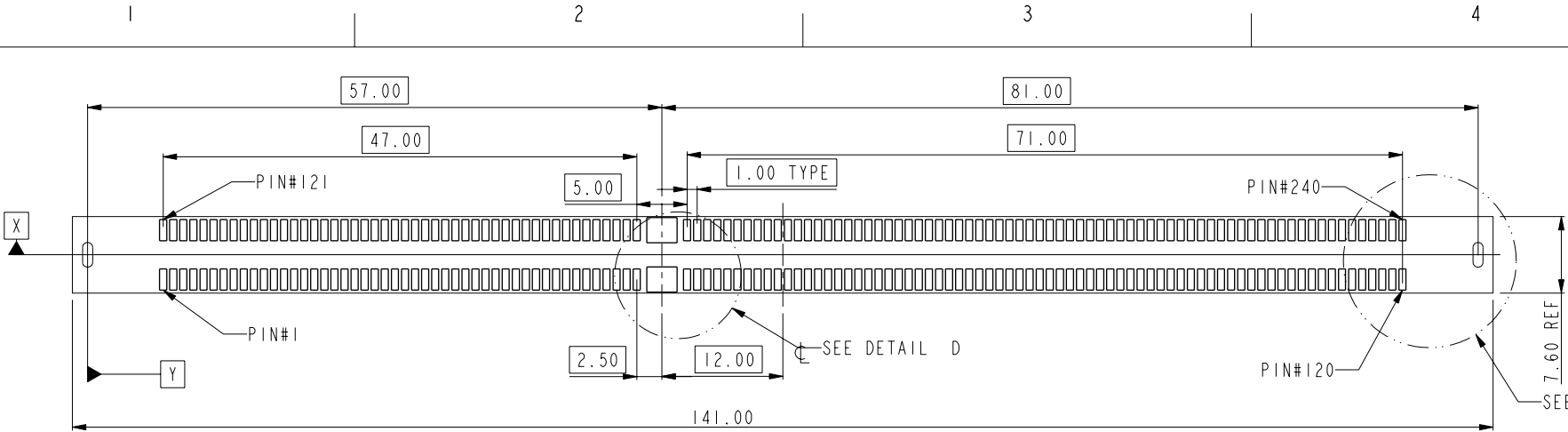

RECOMMEND CIRCUIT BOARD LAYOUT

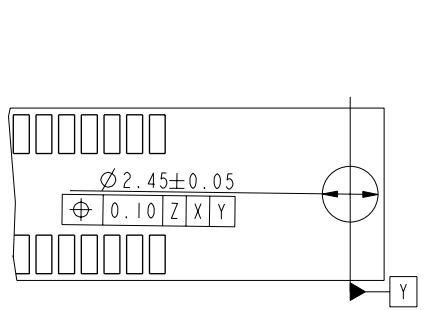

DETAIL E  
SCALE 3.000

Standard hole for hold-down clips

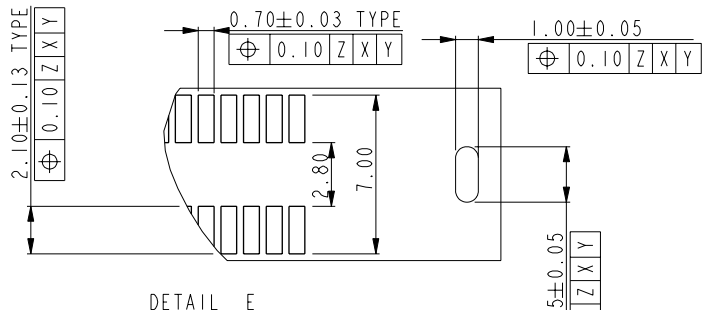

DETAIL E  
SCALE 3.000

For paste-in-hole applications.  
Can be used to solder clips during reflow operation.

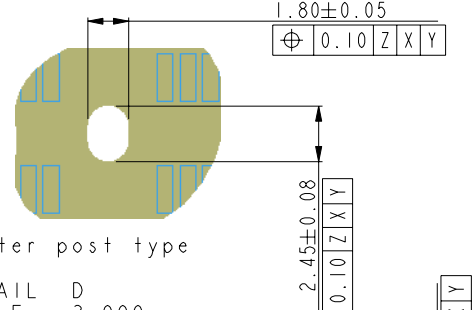

Center post type

DETAIL D  
SCALE 3.000

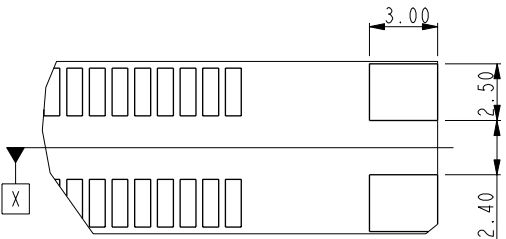

DETAIL E  
SCALE 3.000

For smt holddown type

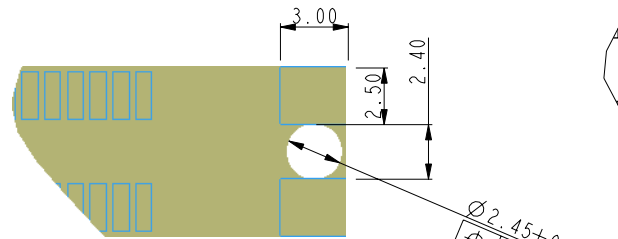

DETAIL E  
SCALE 3.000

For 3smt holddown + 2plastic post type

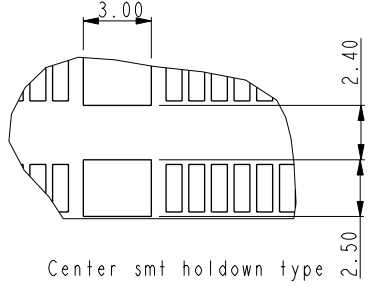

Center smt holddown type

DETAIL D  
SCALE 3.000

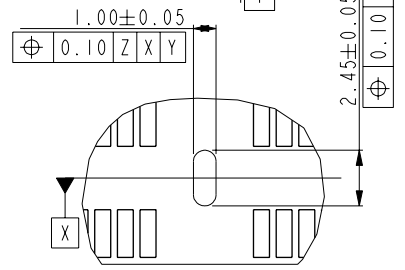

Center forklock type

DETAIL D  
SCALE 3.000

	title	SMT DDRIII SOCKET ASS'Y (WITH LCP HOUSING)	dwg no	10104389	Rev.	C
	catalog no	*	CUSTOMER	sheet 3 of 4		

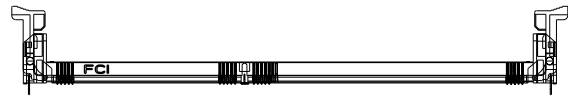

SCALE 0.500



10104389-10\*\*\*  
CENTER SMT HOLDOWN TYPE

SCALE 0.500



10104389-11\*\*\*  
3 FORK LOCK TYPE

SCALE 0.500



10104389-12\*\*\*  
3 SMT HOLDOWN TYPE

SCALE 0.500

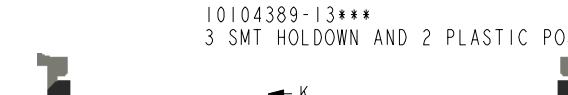

10104389-13\*\*\*  
3 SMT HOLDOWN AND 2 PLASTIC POST TYPE

SCALE 0.500



10104389-15\*\*\*  
3 PLASTIC POST TYPE

NOTES:

- MATERIAL:  
HOUSING: HIGH PERFORMANCE RESINS, GLASS FILLED UL94V-0 RATED.  
EJECTOR: HIGH PERFORMANCE RESINS, GLASS FILLED UL94V-0 RATED.  
TERMINAL: HIGH PERFORMANCE COPPER ALLOY  
METAL CLIP: COPPER ALLOY.
- FCI LOGO TO BE APPROXIMATELY LOCATED AS SHOWN ON PRINT.
- PRODUCT SPECIFICATION: GS-12-486.
- PACKAGING SPECIFICATION: GS-14-899.
- RECOMMENDED STENCIL THICKNESS NO LESS THAN 0.15 mm.
- FOR OPTIMUM PERFORMANCE, THE TIE BAR IS TO BE ON AN INTERNAL LAYER SO THAT THE REMNANT CANNOT CAUSE CONTACT DAMAGE.
- THE DATE CODE IS SHOWN "MMDDYY\*"; "\*" MEANS PRODUCTION LINE.
- THIS PRODUCT MEETS EUROPEAN UNION DIRECTIVES AND OTHER COUNTRY REGULATIONS AS DESCRIBED IN GS-22-008.
- THE HOUSING WILL WITH STAND EXPOSURE TO 260°C PEAK TEMPERATURE FOR 10 SECONDS IN AN IR REFLOW SOLDERING APPLICATION.
- PRODUCT APPLICATION SPEC GS-20-089.
- THE HOLDOWN TYPES ARE OPTION FOR HOLDOWN OR FORKLOCK.

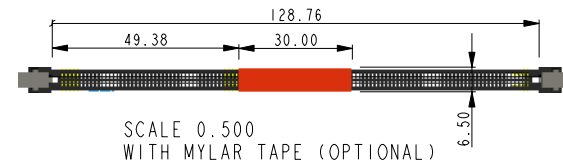
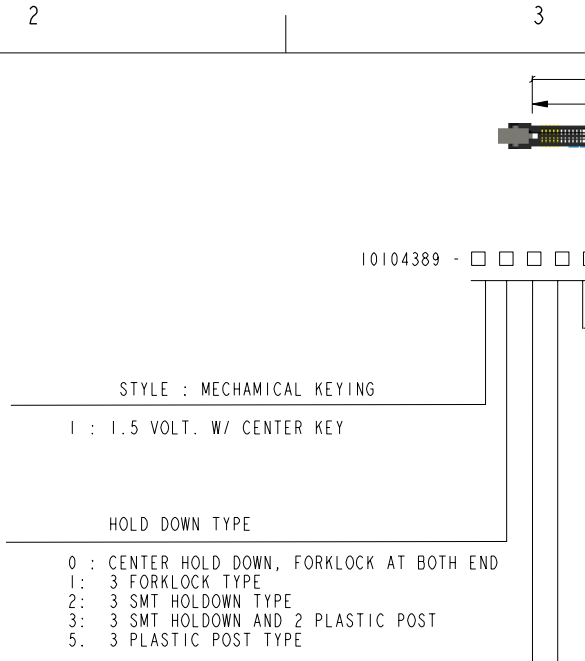

PLATING

CODE	CONTACT	SOLDERTAIL	UNDERPLATE	NOTE
1LF	10u" (0.25um) MIN. GOLD			CONTACT NON-LUBRICANT
2LF	15u" (0.38um) MIN. GOLD			
3LF	30u" (0.76um) MIN. GOLD			
4LF	GOLD FLASH	100u" (2.54um) MIN. 100% MATT TIN	50u" (1.27um) MIN. NICKEL OVERALL	CONTACT LUBRICATED
5LF	10u" (0.25um) MIN. GOLD			
6LF	15u" (0.38um) MIN. GOLD			
7LF	30u" (0.76um) MIN. GOLD			
8LF	GOLD FLASH			

COLOR OF HOUSING AND EJECTOR

- 0 : BLACK HOUSING + IVORY EJECTOR  
1 : BLACK HOUSING + BLACK EJECTOR  
2 : IVORY HOUSING + IVORY EJECTOR  
9 : IVORY HOUSING + BLACK EJECTOR

PACKAGE AND MYLAR OPTION

- 0 : SOFT TRAY WITHOUT MYLAR  
1 : HARD TRAY WITH MYLAR  
2 : HARD TRAY WITHOUT MYLAR  
3 : SOFT TRAY WITH MYLAR  
4 : SPECIAL HARD TRAY WITH MYLAR  
5 : SPECIAL HARD TRAY WITHOUT MYLAR

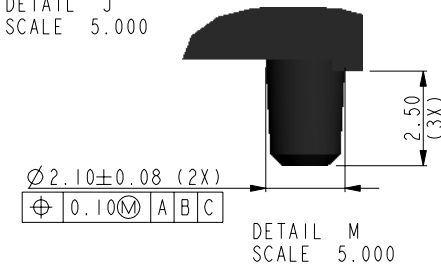
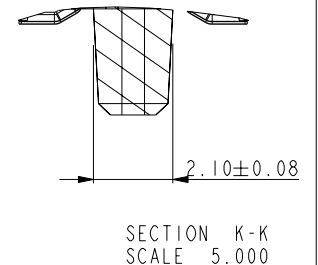
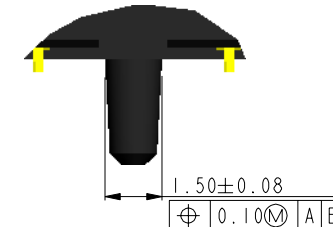
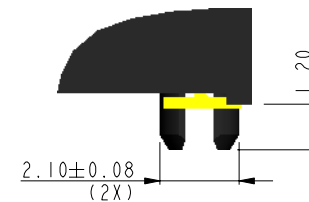

FCI	title	SMT DDRIII SOCKET ASS'Y (WITH LCP HOUSING)	dwg no	10104389	Rev.	C
	catalog no	*	CUSTOMER	sheet 4 of 4		



Copyright FCI.