

**Contact Acceptance Range .016" (.41mm) - .022" (.56mm) Dia. or .010" (.25mm) x .018" (.46mm) Rectangular Lead**

.175(4.45) Hole Depth

Type	Part Number	Contact Group
-38	1104	C

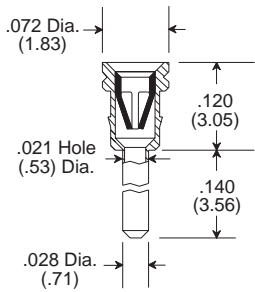
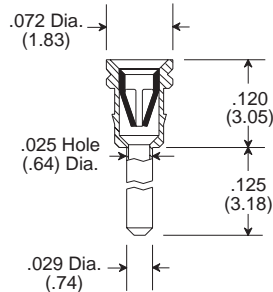

.107(2.72) Hole Depth

Type	Part Number	Contact Group
-358	4071	C

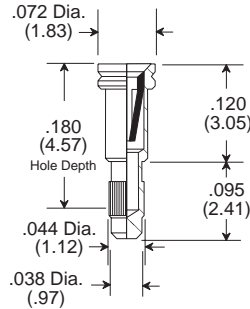

Type	Part Number	Contact Group
-500	4445	C

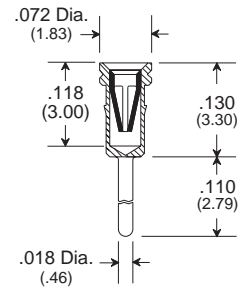

Type	Part Number	Contact Group
-148	1922	C

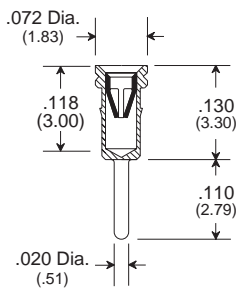

Type	Part Number	Contact Group
-51	1282	C

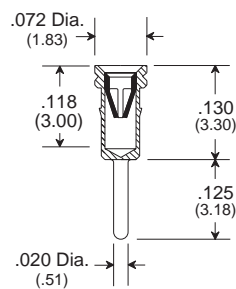

Type	Part Number	Contact Group
-364	4095	C

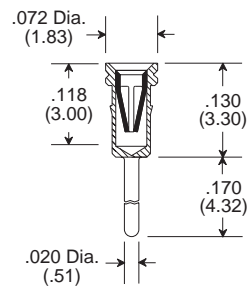

Type	Part Number	Contact Group
-285	3578	C

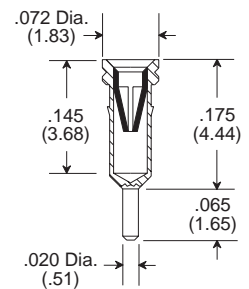

Type	Part Number	Contact Group
-218	3023	C

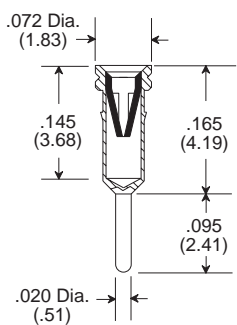

Type	Part Number	Contact Group
-243	3199	C

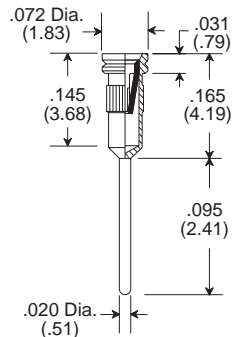

Type	Part Number	Contact Group
-537	4613	C

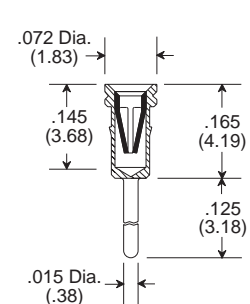

Type	Part Number	Contact Group
-384	4177	C

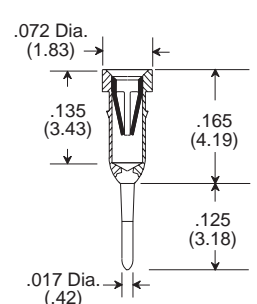

Type	Part Number	Contact Group
-242	3219	C

**Material:**  
Terminal: Brass - Copper Alloy (C36000), ASTM-B-16  
Contact: Beryllium Copper - Copper Alloy (C17200), ASTM-B-194

**Plating:**  
Contact: G = Gold/Nickel  
T = Tin-Lead/Nickel

Gold: per MIL-G-45204  
Tin-Lead: per MIL-P-81728  
Nickel: per QQ-N-290

**Note:** Pins with "V" groove in head may be supplied in Peel-A-Way®

Terminals not drawn to scale.