

Rectangular Tongue Terminals

Material and Finish:

Terminal Body — Copper per ASTM B-152

Plating — Tin per MIL-T-10727

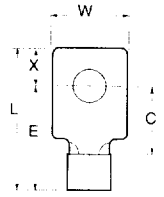

Wire Size Circular Mils [mm ²]	Stud Size	Dimensions					Material Thickness Max.	Wire Barrel I.D. Min.	Part Numbers
		L Max.	E Max.	C Min.	W	X			
16-14 2,050-5,180 [1.04-2.62]	6 M3.5	.529 13.44	.384 9.75	.203 5.16	.296 7.52	.140 3.56	.033 0.84	.085 2.16	2-34266-1
12-10 5,180-13,100 [2.62-6.64]	6 M3.5	.631 16.03	.486 12.34	.218 5.54	.290 7.37	.140 3.56	.042 1.07	.129 3.28	2-321499-1

Spade Tongue Terminals

Material and Finish:

Terminal Body — Copper per ASTM B-152

Plating — Tin per MIL-T-10727

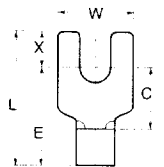

Wire Size Circular Mils [mm ²]	Stud Size	Dimensions					Material Thickness Max.	Wire Barrel I.D. Min.	Part Numbers
		L Max.	E Max.	C Min.	W	X			
22-16 509-3,260 [0.26-1.65]	2 M2	.504 12.80	.384 9.75	.203 5.16	.182 4.62	.115 2.92	.033 0.84	.061 1.55	53555-1*
	6 M3.5	.530 13.46	.384 9.75	.203 5.16	.297 7.54	.141 3.58	.033 0.84	.061 1.55	36195* 2-36195-3
		.623 15.82	.493 12.52	.312 7.92	.250 6.35	.125 3.18	.033 0.84	.061 1.55	323127*
	10	.685 17.40	.493 12.52	.312 7.92	.375 9.53	.187 4.75	.033 0.84	.061 1.55	34118* 2-34118-2
16-14 2,050-5,180 [1.04-2.62]	6 M3.5	.530 13.46	.384 9.75	.203 5.16	.297 7.54	.141 3.58	.033 0.84	.085 2.16	322996* 2-322996-1
		.623 15.82	.493 12.52	.312 7.92	.244 6.20	.125 3.18	.033 0.84	.085 2.16	330827
16-14 2,050-5,180 [1.04-2.62]	8 M4	.685 17.40	.493 12.52	.312 7.92	.385 9.78	.187 4.75	.033 0.84	.085 2.16	34128*
	10	.685 17.40	.493 12.52	.312 7.92	.385 9.78	.187 4.75	.033 0.84	.085 2.16	34129*
12-10 5,180-13,100 [2.62-6.64]	6 M3.5	.631 16.03	.486 12.34	.218 5.54	.282 7.16	.140 3.56	.042 1.07	.129 3.28	322451*
	8 M4	.991 25.17	.757 19.23	.468 11.89	.312 7.92	.250 6.35	.042 1.07	.129 3.28	32995*
	10	.772 19.61	.564 14.33	.296 7.52	.375 9.53	.203 5.16	.042 1.07	.129 3.28	35495* 2-35495-2

Note: Part numbers are shown as loose piece over tape mounted product.

* Part numbers are available in small quantity packages.

For complete product information, order Catalog 65505