

VICOR CONFIDENTIAL

THIS DOCUMENT AND THE DATA DISCLOSED
HEREIN OR HEREWITH IS NOT TO BE REPRODUCED,
USED, OR DISCLOSED IN WHOLE OR IN PART
TO ANYONE WITHOUT PERMISSION OF VICOR CORP.

| REV. | DESCRIPTION | DATE | APPROVED |
|------|-------------------------------|--------|----------|
| 03 | REVSD & REDWN PER E950112 DPK | 4/5/95 | RCM |

ELECTRICAL CHARACTERISTICS

| | |
|--------------------------|--|
| RATED VOLTAGE: | 250 VAC, 50/60 Hz |
| CAPACITANCE TOLERANCE: | ± 10% |
| DISSIPATION FACTOR: | < 1% MEASURED AT 1 KHZ |
| MAXIMUM PULSE RISE TIME: | ACCORDING TO VDE 0565 PART 1 du/dt 100V / μSEC |
| DIELECTRIC: | POLYESTER-FILM |
| TEST VOLTAGE: | (ELECTRODE/ELECTRODE) 1075 V-, 2 SEC. (SELF HEALINGS ARE ALLOWED TO OCCUR) |
| INSULATION RESISTANCE: | FOR C ≤ .33μF 15000 MEGOHM MINIMUM VALUE |
| COATING: | PLASTIC CAN, EPOXY RESIN SEALED, FLAME RETARDANT |

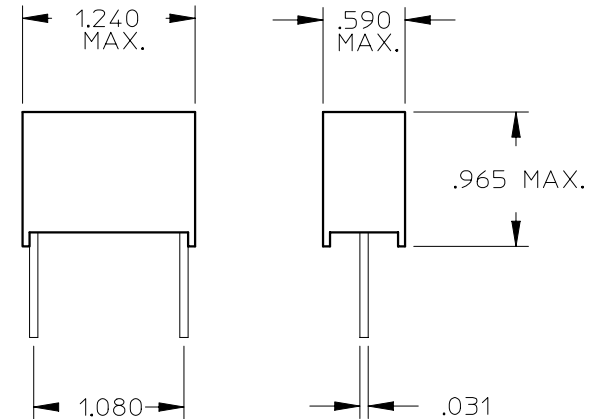

NOTES:

1. APPROVALS INCLUDE VDE, SEV, DEMKO, SEMKO, NEMKO, SETI, UL, IMQ, OVE.
2. LEADS ARE TINNED COPPER WIRE.

UNLESS OTHERWISE SPECIFIED
DIMENSIONS ARE IN INCHES
TOLERANCES ARE:

| FRACTIONS | DECIMALS | ANGLES |
|-----------|-------------|--------|
| ± 1/64 | .XX ± .01 | ± 1° |
| | .XXX ± .005 | |

THIRD ANGLE PROJECTION

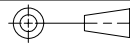

DO NOT SCALE DRAWING

| APPROVALS | | DATE | | | | |
|------------------------------------|--|------|--------------|----------|----------|------|
| DRAWN: D.P. KELLY | | 4/95 | | | | |
| CAP, FLM, AXIAL, 1μF, ±10%/250V | | | SIZE | FSCM NO. | DWG. NO. | REV. |
| | | | B | 67131 | 02573 | 03 |
| SCALE FULL | | | SHEET 1 OF 1 | | | |