

THIS DOCUMENT CONTAINS PROPRIETARY DATA OF POLARIS INDUSTRIAL ENTERPRISES, INC. NO DISCLOSURE, REPRODUCTION, OR USE OF ANY PART THERE OF MAY BE MADE EXCEPT BY WRITTEN PERMISSION.

REV.	BY	DATE	APPRVL.	P/N	HSM22
------	----	------	---------	-----	-------

GENERAL SPECIFICATION:

CURRENT CONSUMPTION SINGLE OUTPUT ----- BELOW 16mA
 CURRENT CONSUMPTION DUAL OUTPUT----- BELOW 32mA
 INDEPENDENT LINEARITY TOL. ----- $\pm 0.5\%FS(FS=360^\circ)$
 MECHANICAL ROTATING ANGLE ----- $360^\circ(ENDESS)$
 EFFECTIVE ELECTRICAL ANGLE ----- $360^\circ(ENDESS)$
 APPLIED VOLTAGE ----- $5V \pm 10\%D.C$
 LOAD RESISTANCE ----- 10KOHMS MIN
 EFFECTIVE OUTPUT ----- $10\% \pm 3\% \sim 90\% \pm 3\% VIN$
 OUTPUT TEMPERATURE CHARACT. ----- WITHIN $\pm 0.3\%VOUT/FS$
 OPERATING TEMPERATURE RANGE ----- $-40^\circ C \sim +120^\circ C$
 STORAGE TEMPERATURE RANGE ----- $-40^\circ C \sim +120^\circ C$
 MASS ----- APPROX 20g

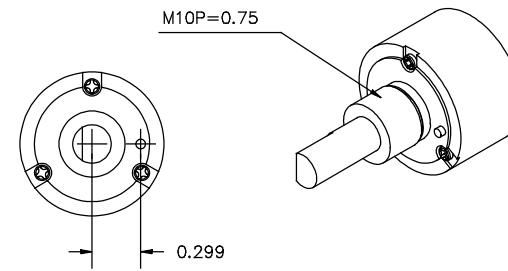
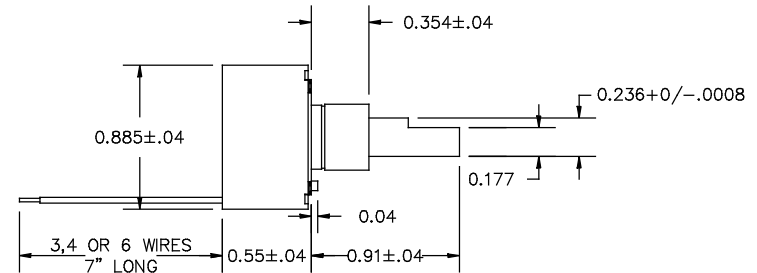

ENVIRONMENTAL SPECIFICATION:

ROTATING TORQUE ----- BELOW 5mN.m
 THERMAL SHOCK ----- 5 CYCLES $-40^\circ C \sim +105^\circ C$
 EXPOSURE TO LOW TEMPERATURE ----- 24 HOURS AT $-40^\circ C$
 EXPOSURE AT HIGH TEMPERATURES ----- 1,000 HOURS AT $+105^\circ C$
 VIBRATION ----- $10 \sim 2,000Hz$ 196m/s.s 12 HOURS
 SHOCK ----- 980m/s.s 6ms (18 TIMES)
 ROTATIONAL LIFE EXPECTANCY ----- APPROX. 50,000,000 REVOLUTIONS
 EMS TOLERANCE ----- 100V/m (80MHz \sim 1GHz 1KHz SIN WAVE
 80% AMPLITUDE MODULATION)
 ESD TOLERANCE ----- $\pm 8KV$ CONTACT / $\pm 15KV$ AERIAL DISCHARGE

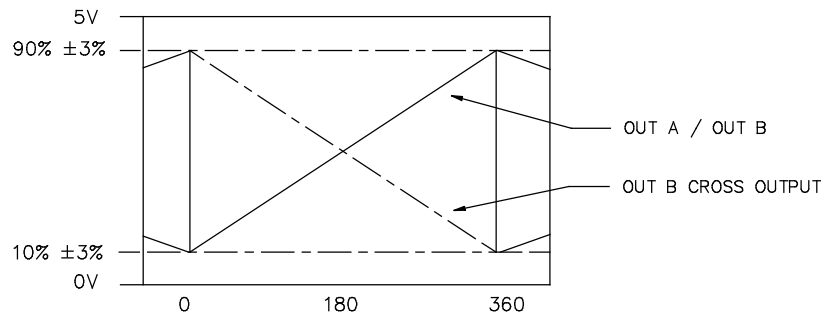

SINGLE OUTPUT DUAL OUTPUT DUAL INDEP. OUTPUT

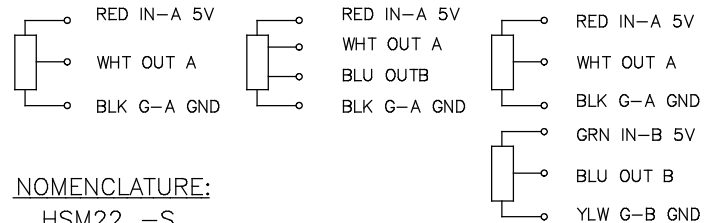

NOMENCLATURE:

HSM22 -S
 OUTPUT TYPE (S, X, P, IX OR IP)
 SERIES

TOLERANCES
 XX = +/- .010" FRACT. = +/- 1/64"
 XXX = +/- .005" ANGLES = +/- 1/2"
 ALL SPECIFICATIONS SUBJECT TO CHANGE WITHOUT NOTICE.

SCALE	DATE: 5-3-13
NONE	BY AT
	APPRV'D
CODE IDENT:	19477



TITLE
 CONTACTLESS
 POTENTIOMETER

PART NO.
 HSM22

Mouser Electronics

Authorized Distributor

Click to View Pricing, Inventory, Delivery & Lifecycle Information:

[ETI Systems:](#)

[HSM22-S](#) [HSM22-P](#) [HSM22-X](#)