

CCT	A	B	C
3	5.00	10.10	11.70
4	7.50	12.60	14.20
5	10.00	15.10	16.70
6	12.50	17.60	19.20
7	15.00	20.10	21.70
8	17.50	22.60	24.20
9	20.00	25.10	26.70
10	22.50	27.60	29.20
11	25.00	30.10	31.70
12	27.50	32.60	34.20
13	30.00	35.10	36.70
14	32.50	37.60	39.20
15	35.00	40.10	41.70

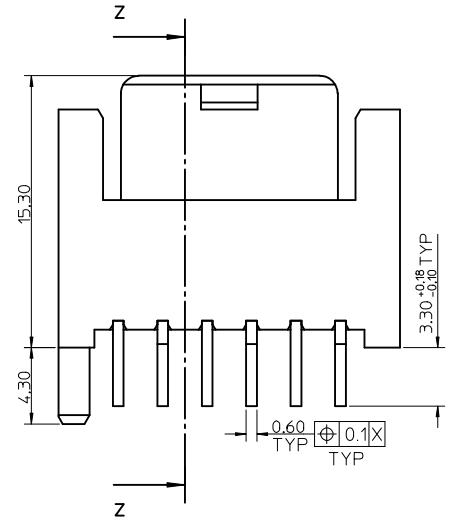
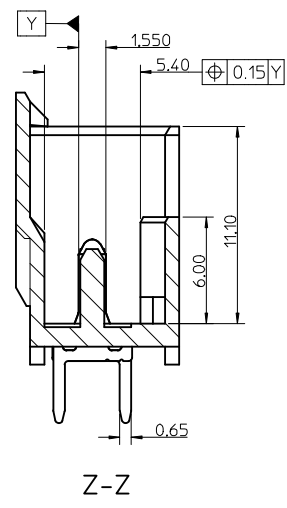

Standard PCB Layout - Even cct size

Standard PCB Layout - Odd cct size

Opposite PCB Layout - Even cct size

Opposite PCB Layout - Odd cct size

NOTES:

1. MATERIAL: HOUSING - PA66 25% G/F, UL94 V-0
COLOUR: NATURAL
TERMINAL - BRASS
PLATING - 3-7um Sn over 1.27um Min Ni
2. PARTS PACKED AS PER PK-90370-001
3. PRODUCT SPECIFICATION: PS-93070-001
4. RECOMMENDED PCB THICKNESS: 1.5+/-0.14mm

DIM. CHANGE EC NO: IFC2014-2048 DRAWN: MONAHAN 2014/07/21 CHKD: APPR: MSANAHAN 2014/08/11	QUALITY SYMBOLS ▽=0 ▽=0	GENERAL TOLERANCES (UNLESS SPECIFIED)		DIMENSION STYLE MM ONLY		SCALE 5:1	DESIGN UNITS METRIC	THIRD ANGLE PROJECTION	
		mm	INCH	DRAWN BY	DATE	TITLE	RAST 2.5 APPLI-MATE VERTICAL MALE HEADER 2.5 PITCH MOLEX INCORPORATED SD-93070-001		
4 PLACES ±---	±---	TTOURISH	2008/03/14	APPROVED BY BMAGUIRE 2010/11/11		DOCUMENT NO.			
3 PLACES ±0.05	±---	CHECKED BY	DATE					DRAFT WHERE APPLICABLE MUST REMAIN WITHIN DIMENSIONS	
2 PLACES ±0.10	±---	BRUTTLE	2008/03/14	SEE SHEETS 2-4					
1 PLACE ±0.20	±---	ANGULAR ± 2 °							

3 CIRCUIT

MOLEX PART NO.	HOUSING PART NO.	BLOCKED POSITION KEYS	TERMINAL VOID POSITION	CONFIGURATION	LATCH	CCT 1 LOCATION	HOUSING COLOUR
93070-0001	91698-0001	NONE	NONE		YES	STANDARD	NATURAL
93070-0002	91698-0007	b d	NONE		YES	STANDARD	NATURAL
93070-0003	91698-0010	b c	NONE		YES	STANDARD	NATURAL
93070-0004	91698-0006	d	NONE		YES	STANDARD	NATURAL
93070-0005	91698-0003	a	NONE		YES	STANDARD	NATURAL
93070-0006	91698-0009	a b	NONE		YES	STANDARD	NATURAL
93070-0007	91698-0008	a c	NONE		YES	STANDARD	NATURAL
93070-0008	91698-0002	a d	NONE		YES	STANDARD	NATURAL
93070-0009	91698-0011	c d	NONE		YES	STANDARD	NATURAL
93070-0010	91698-0004	b	NONE		YES	STANDARD	NATURAL
93070-0011	91698-0251	NONE	NONE		NO	STANDARD	NATURAL
93070-0012	91698-0018	b d	NONE		YES	STANDARD	BLUE
93070-0013	91698-0019	b c	NONE		YES	STANDARD	RED
93070-0014	91698-0020	d	NONE		YES	STANDARD	GREEN
93070-0015	91698-0021	a	NONE		YES	STANDARD	BLACK

4 CIRCUIT

MOLEX PART NO.	HOUSING PART NO.	BLOCKED POSITION KEYS	TERMINAL VOID POSITION	CONFIGURATION	LATCH	CCT 1 LOCATION	HOUSING COLOUR
93070-0501	91698-0501	NONE	NONE		YES	STANDARD	NATURAL
93070-0502	91698-0507	b c	NONE		YES	STANDARD	NATURAL
93070-0503	91698-0507	b c	CCT 4		YES	STANDARD	NATURAL
93070-0504	91698-0512	c d	NONE		YES	STANDARD	NATURAL
93070-0505	91698-0501	NONE	CCT 1		YES	STANDARD	NATURAL
93070-0601	91698-0507	b c	NONE		YES	OPPOSITE	NATURAL
93070-0506	91698-0506	b	NONE		YES	STANDARD	NATURAL
93070-0507	91698-0514	c	NONE		YES	STANDARD	NATURAL
93070-0508	91698-0502	d	NONE		YES	STANDARD	NATURAL
93070-0509	91698-0515	a c d	NONE		YES	STANDARD	NATURAL
93070-0510	91698-0516	b c d	NONE		YES	STANDARD	NATURAL
93070-0511	91698-0517	b c d	NONE		YES	STANDARD	RED
93070-0512	91698-0518	d	NONE		YES	STANDARD	RED
93070-0513	91698-0519	b d	NONE		YES	STANDARD	NONE
93070-0514	91698-0509	d e	NONE		YES	STANDARD	NONE
93070-0515	91698-0513	a c e	NONE		YES	STANDARD	NONE
93070-0516	91698-0520	b	NONE		YES	STANDARD	RED
93070-0517	91698-0521	d	NONE		YES	STANDARD	BLUE

5 CIRCUIT

MOLEX PART NO.	HOUSING PART NO.	BLOCKED POSITION KEYS	TERMINAL VOID POSITION	CONFIGURATION	LATCH	CCT 1 LOCATION	HOUSING COLOUR
93070-1001	91698-1001	NONE	NONE		YES	STANDARD	NATURAL
93070-1002	91698-1004	c d	NONE		YES	STANDARD	NATURAL
93070-1003	91698-1008	a d f	NONE		YES	STANDARD	NATURAL
93070-1101	91698-1001	NONE	NONE		YES	OPPOSITE	NATURAL
93070-1004	91698-1009	d	NONE		YES	STANDARD	NATURAL
93070-1005	91698-1007	a b e f	NONE		YES	STANDARD	NATURAL
93070-1006	91698-1011	b c d e	NONE		YES	STANDARD	NATURAL
93070-1007	91698-1014	c d	NONE		YES	STANDARD	RED
93070-1008	91698-1017	a b e f	NONE		YES	STANDARD	BLUE
93070-1009	91698-1016	b c d e	NONE		YES	STANDARD	BLUE
93070-1010	91698-1018	d e	NONE		YES	STANDARD	NATURAL
93070-1011	91698-1019	b d e	NONE		YES	STANDARD	NATURAL
93070-1012	91698-1020	a c f	NONE		YES	STANDARD	NATURAL
93070-1013	91698-1021	a b c d	NONE		YES	STANDARD	NATURAL
93070-1014	91698-1022	a b d e	NONE		YES	STANDARD	NATURAL
93070-1015	91698-1023	a b c e	NONE		YES	STANDARD	NATURAL

NOTES:
 1. + DENOTES TERMINAL VOIDED POSITION
 ⊕ DENOTES TERMINAL LOADED POSITION

SEE SHEET 1 IEC NO: IP2014-2048 DRAWN BY: DRINKOMAHAN 2014/07/24 CHKD: APPR: SHAMAHAN 2014/08/11 REV:	QUALITY SYMBOLS	GENERAL TOLERANCES (UNLESS SPECIFIED)	DIMENSION STYLE	SCALE	DESIGN UNITS	THIRD ANGLE PROJECTION
	▽=0	mm INCH	MM ONLY	1:1	METRIC	
	▽=0	4 PLACES ± --- ± ---	TITOURISH 2008/03/14			
		3 PLACES ± 0.05 ± ---	CHECKED BY: BRUTTLE 2008/03/14			
	2 PLACES ± 0.10 ± ---	APPROVED BY: BMAGUIRE 2010/11/11				
	1 PLACE ± 0.20 ± ---					
	ANGULAR ± 2 °					
	DRAFT WHERE APPLICABLE MUST REMAIN WITHIN DIMENSIONS					
		SEE CHARTS				

RAST 2.5 APPLI-MATE
 VERTICAL MALE HEADER
 2.5 PITCH

MOLEX INCORPORATED

DOCUMENT NO. SD-93070-001

SHEET NO. 2 OF 5

THIS DRAWING CONTAINS INFORMATION THAT IS PROPRIETARY TO MOLEX INCORPORATED AND SHOULD NOT BE USED WITHOUT WRITTEN PERMISSION

6 CIRCUIT

MOLEX PART NO.	HOUSING PART NO.	BLOCKED POSITION KEYS	TERMINAL VOID POSITION	CONFIGURATION	LATCH	CCT 1 LOCATION	HOUSING COLOUR
93070-1501	91698-1501	NONE	NONE		YES	STANDARD	NATURAL
93070-1502	91698-1508	d f	CCT 2, 5		YES	STANDARD	NATURAL
93070-1503	91698-1513	c e	NONE		YES	STANDARD	NATURAL
93070-1505	91698-1508	d f	NONE		YES	STANDARD	NATURAL
93070-1506	91698-1514	b d f	CCT 4, 5		YES	STANDARD	NATURAL
93070-1507	91698-1501	NONE	CCT 2		YES	STANDARD	NATURAL
93070-1508	91698-1511	c f	CCT 2		YES	STANDARD	NATURAL
93070-1509	91698-1515	d	NONE		YES	STANDARD	NATURAL
93070-1510	91698-1516	a b c e f	NONE		YES	STANDARD	NATURAL
93070-1511	91698-1507	e f	NONE		YES	STANDARD	NATURAL
93070-1512	91698-1517	d f	NONE		YES	STANDARD	GREEN
93070-1513	91698-1512	b d e f	CCT 2 4		YES	STANDARD	NATURAL
93070-1514	91698-1518	a b d f	NONE		YES	STANDARD	NATURAL
93070-1515	91698-1516	a b c e f	CCT 1		YES	STANDARD	NATURAL

7 CIRCUIT

MOLEX PART NO.	HOUSING PART NO.	BLOCKED POSITION KEYS	TERMINAL VOID POSITION	CONFIGURATION	LATCH	CCT 1 LOCATION	HOUSING COLOUR
93070-2001	91698-2001	NONE	NONE		YES	STANDARD	NATURAL
93070-2002	91698-2006	a f	CCT 2, 6		YES	STANDARD	NATURAL
93070-2003	91698-2007	d g	CCT 4		YES	STANDARD	NATURAL
93070-2004	91698-2008	a e	CCT 4		YES	STANDARD	NATURAL
93070-2005	91698-2009	d f g	CCT 4		YES	STANDARD	NATURAL
93070-2006	91698-2006	a f	CCT 4		YES	STANDARD	NATURAL
93070-2007	91698-2003	a	NONE		YES	STANDARD	NATURAL
93070-2008	91698-2001	NONE	CCT 2		YES	STANDARD	NATURAL
93070-2009	91698-2003	a	CCT 4		YES	STANDARD	NATURAL
93070-2010	91698-2005	h	CCT 2		YES	STANDARD	NATURAL
93070-2011	91698-2010	b e g	NONE		YES	STANDARD	NATURAL
93070-2013	91698-2015	h	CCT 2		YES	STANDARD	NATURAL
93070-2014	91698-2016	all	NONE		YES	STANDARD	NATURAL
93070-2015	91698-2012	b c d e f g	NONE		YES	STANDARD	NATURAL

- NOTES:
 1. + DENOTES TERMINAL VOIDED POSITION
 ⊕ DENOTES TERMINAL LOADED POSITION

SEE SHEET 1 ELEC NO: IPG2014-2048 DRAWN BY: DRWNGKONWANHAN CHKD: APPR: SHAMAHAN DATE: 2014/07/24	QUALITY SYMBOLS ▽=0 ▽=0	GENERAL TOLERANCES (UNLESS SPECIFIED) mm INCH 4 PLACES ± --- ± --- 3 PLACES ± 0.05 ± --- 2 PLACES ± 0.10 ± --- 1 PLACE ± 0.20 ± --- ANGULAR ± 2 °	DIMENSION STYLE MM ONLY	SCALE 1:1	DESIGN UNITS METRIC	THIRD ANGLE PROJECTION	
	DRAWN BY: TOURISH DATE: 2008/03/14	CHECKED BY: BRUTTLE DATE: 2008/03/14	APPROVED BY: BMAGUIRE DATE: 2010/11/11	MATERIAL NO.	DOCUMENT NO.	TITLE RAST 2.5 APPLI-MATE VERTICAL MALE HEADER 2.5 PITCH	SHEET NO. 3 OF 5
	DRAFT WHERE APPLICABLE MUST REMAIN WITHIN DIMENSIONS			SEE CHARTS	Molex INCORPORATED		SD-93070-001
	THIS DRAWING CONTAINS INFORMATION THAT IS PROPRIETARY TO MOLEX INCORPORATED AND SHOULD NOT BE USED WITHOUT WRITTEN PERMISSION						

8 CIRCUIT

MOLEX PART NO.	HOUSING PART NO.	BLOCKED POSITION KEYS	TERMINAL VOID POSITION	CONFIGURATION	LATCH	CCT 1 LOCATION	HOUSING COLOUR
93070-2501	91698-2501	NONE	NONE		YES	STANDARD	NATURAL
93070-2502	91698-2504	c f h i	NONE		YES	STANDARD	NATURAL
93070-2503	91698-2503	b c d h i	CCT 4, 7		YES	STANDARD	NATURAL
93070-2601	91698-2501	NONE	CCT 4, 7		YES	OPPOSITE	NATURAL
93070-2504	91698-2503	b c d h i	NONE		YES	STANDARD	NATURAL
93070-2505	91698-2507	a c e f h i	NONE		YES	STANDARD	NATURAL
93070-2506	91698-2508	a b d f h i	CCT 7, 8		YES	STANDARD	NATURAL
93070-2508	91698-2505	b c d g h i	NONE		YES	STANDARD	NATURAL
93070-2509	91698-2506	c d e h	NONE		YES	STANDARD	NATURAL

9 CIRCUIT

MOLEX PART NO.	HOUSING PART NO.	BLOCKED POSITION KEYS	TERMINAL VOID POSITION	CONFIGURATION	LATCH	CCT 1 LOCATION	HOUSING COLOUR
93070-3001	91698-3001	NONE	NONE		YES	STANDARD	NATURAL
93070-3002	91698-3003	ALL	CCT 2, 5, 8		YES	STANDARD	NATURAL
93070-3101	91698-3001	NONE	CCT 3, 5, 8		YES	OPPOSITE	NATURAL
93070-3003	91698-3004	c d e i j	CCT 3, 5, 8		YES	STANDARD	NATURAL
93070-3004	91698-3001	NONE	CCT 2, 5, 8		YES	STANDARD	NATURAL
93070-3005	91698-3006	b c d e f g i	CCT 3, 5, 8		YES	STANDARD	NATURAL

NOTES:
 1. + DENOTES TERMINAL VOIDED POSITION
 ● DENOTES TERMINAL LOADED POSITION

SEE SHEET 1 EC NO: IPG2014-2048 DRAWN BY: DRINKOMAHAN CHKD: APPR: SHAMAHAN DATE: 2014/07/21	QUALITY SYMBOLS	GENERAL TOLERANCES (UNLESS SPECIFIED)	DIMENSION STYLE	SCALE	DESIGN UNITS	THIRD ANGLE PROJECTION
	▽=0	mm INCH	MM ONLY	1:1	METRIC	
	▽=0	4 PLACES ± --- ± ---	TITOURISH	DATE	TITLE	
		3 PLACES ± 0.05 ± ---	CHECKED BY	DATE	RAST 2.5 APPLI-MATE VERTICAL MALE HEADER 2.5 PITCH	
	2 PLACES ± 0.10 ± ---	APPROVED BY	DATE	MATERIAL NO.		
	1 PLACE ± 0.20 ± ---	BMAGUIRE	2010/11/11	SD-93070-001		
	ANGULAR ± 2 °	DRAFT WHERE APPLICABLE MUST REMAIN WITHIN DIMENSIONS		DOCUMENT NO.		
		SEE CHARTS		SD-93070-001		
		THIS DRAWING CONTAINS INFORMATION THAT IS PROPRIETARY TO MOLEX INCORPORATED AND SHOULD NOT BE USED WITHOUT WRITTEN PERMISSION		SHEET NO. 4 OF 5		

10 CIRCUIT

MOLEX PART NO.	HOUSING PART NO.	BLOCKED POSITION KEYS	TERMINAL VOID POSITION	CONFIGURATION	LATCH	CCT 1 LOCATION	HOUSING COLOUR
93070-3501	91698-3501	NONE	NONE		YES	STANDARD	NATURAL
93070-3502	91698-3501	NONE	CCT 2, 5, 7, 9		YES	STANDARD	NATURAL
93070-3503	91698-3504	a b d e f g i j	NONE		YES	STANDARD	NATURAL

14 CIRCUIT

MOLEX PART NO.	HOUSING PART NO.	BLOCKED POSITION KEYS	TERMINAL VOID POSITION	CONFIGURATION	LATCH	CCT 1 LOCATION	HOUSING COLOUR
93070-5501	91698-5501	NONE	NONE		YES	STANDARD	NATURAL

11 CIRCUIT

MOLEX PART NO.	HOUSING PART NO.	BLOCKED POSITION KEYS	TERMINAL VOID POSITION	CONFIGURATION	LATCH	CCT 1 LOCATION	HOUSING COLOUR
93070-4001	91698-4001	NONE	NONE		YES	STANDARD	NATURAL

15 CIRCUIT

MOLEX PART NO.	HOUSING PART NO.	BLOCKED POSITION KEYS	TERMINAL VOID POSITION	CONFIGURATION	LATCH	CCT 1 LOCATION	HOUSING COLOUR
93070-6001	91698-6001	NONE	NONE		YES	STANDARD	NATURAL
93070-6002	91698-6003	o p	CCT 4, 6, 8, 10, 12, 14		YES	STANDARD	NATURAL
93070-6003	91698-6002	a d g i j n o p	NONE		YES	STANDARD	NATURAL

12 CIRCUIT

MOLEX PART NO.	HOUSING PART NO.	BLOCKED POSITION KEYS	TERMINAL VOID POSITION	CONFIGURATION	LATCH	CCT 1 LOCATION	HOUSING COLOUR
93070-4501	91698-4501	NONE	NONE		YES	STANDARD	NATURAL
93070-4502	91698-4501	NONE	CCT 2, 5, 8, 11		YES	STANDARD	NATURAL

13 CIRCUIT

MOLEX PART NO.	HOUSING PART NO.	BLOCKED POSITION KEYS	TERMINAL VOID POSITION	CONFIGURATION	LATCH	CCT 1 LOCATION	HOUSING COLOUR
93070-5001	91698-5001	NONE	NONE		YES	STANDARD	NATURAL
93070-5002	91698-5001	NONE	CCT 4, 6, 8, 10, 12		YES	STANDARD	NATURAL

NOTES:
 1. + DENOTES TERMINAL VOIDED POSITION
 ⊕ DENOTES TERMINAL LOADED POSITION

SEE SHEET 1 ELEC NO: IPG2014-2048 DRAWN BY: DRW/KOMOHAN CHKD: APPR:SHAMHAN DATE: 2014/07/21 DATE: 2014/08/11	QUALITY SYMBOLS	GENERAL TOLERANCES (UNLESS SPECIFIED)	DIMENSION STYLE	SCALE	DESIGN UNITS	THIRD ANGLE PROJECTION	
	▽=0 ▽=0	m m INCH	MM ONLY	1:1	METRIC		
		4 PLACES ± --- ± --- 3 PLACES ± 0.05 ± --- 2 PLACES ± 0.10 ± --- 1 PLACE ± 0.20 ± ---	DRAWN BY DATE TTOURISH 2008/03/14	CHECKED BY DATE BRUTTLE 2008/03/14	TITLE RAST 2.5 APPLI-MATE VERTICAL MALE HEADER 2.5 PITCH		
		ANGULAR ± 2 °	APPROVED BY DATE BMAGUIRE 2010/11/11	MATERIAL NO. SD-93070-001 DOCUMENT NO. SD-93070-001 SHEET NO. 5 OF 5			
DRAFT WHERE APPLICABLE MUST REMAIN WITHIN DIMENSIONS		SEE CHARTS		THIS DRAWING CONTAINS INFORMATION THAT IS PROPRIETARY TO MOLEX INCORPORATED AND SHOULD NOT BE USED WITHOUT WRITTEN PERMISSION			